

This circuit is proprietary to Linear Technology and supplied for use with Linear Technology parts.

**Customer Notice:** Linear Technology has made a best effort to design a circuit that meets customer-supplied specifications; however, it remains the customer's responsibility to verify proper and reliable operation in the actual application. Component substitution and printed circuit board layout may significantly affect circuit performance or reliability. Contact Linear Applications Engineering for assistance.

LTC CONFIDENTIAL - For Customer Use Only

REVISION HISTORY

ECO	REV	DESCRIPTION	DATE	APPROVED
	2	PROTO	02-04-03	

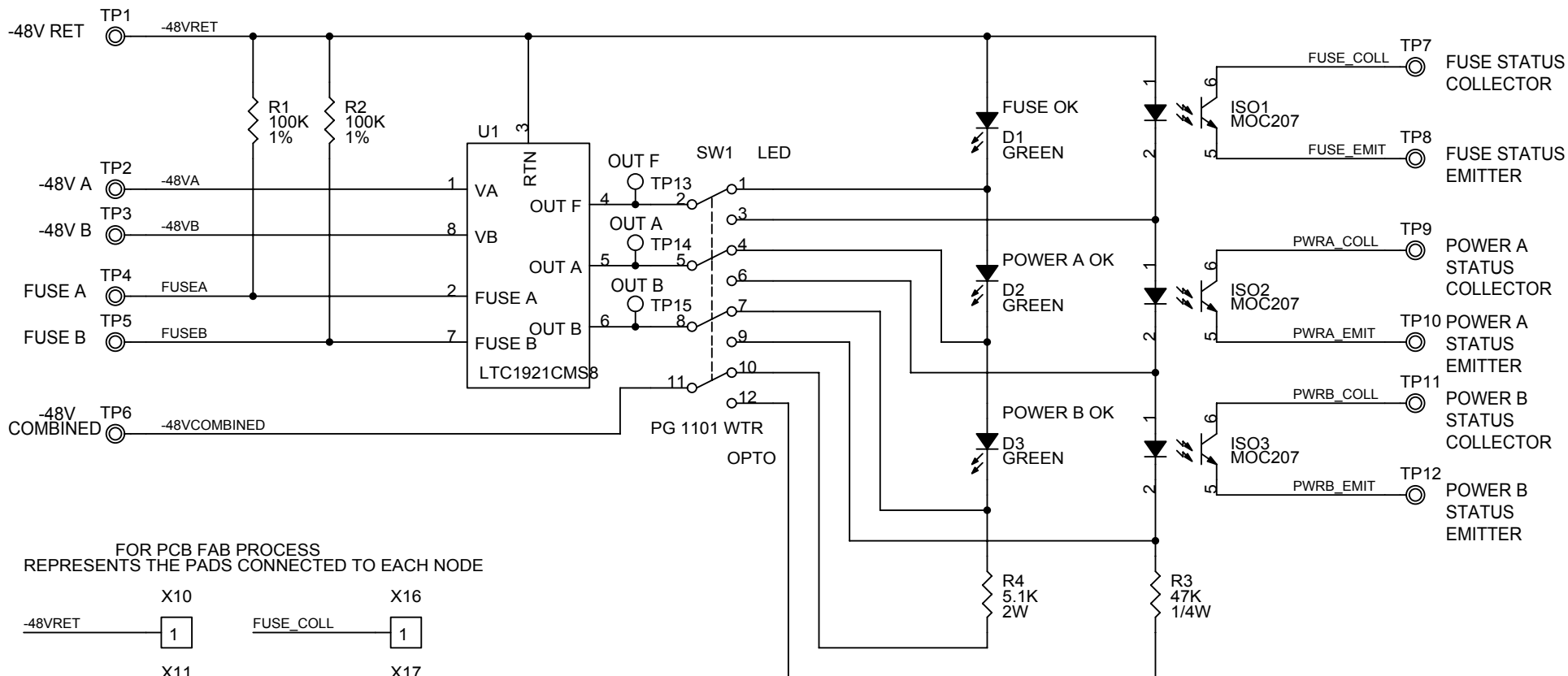

FOR PCB FAB PROCESS  
REPRESENTS THE PADS CONNECTED TO EACH NODE

-48VRET	X10	FUSE_COLL	X16
-48VA	X11	FUSE_EMIT	X17
-48VB	X12	PWRA_COLL	X18
FUSEA	X13	PWRA_EMIT	X19
FUSEB	X14	PWRB_COLL	X20
-48VCOMBINED	X15	PWRB_EMIT	X21

UNLESS OTHERWISE SPECIFIED  
DIMENSIONS ARE IN INCHES  
TOLERANCE ON ANGLE ---  
2 PLACES --- 3 PLACES ---  
INTERPRET DIM AND TOL  
PER ASME Y14.5M -1994

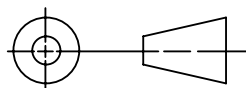

DO NOT SCALE DRAWING

CONTRACT NO.

APPROVALS	DATE
DRAWN MEI	06-18-02
CHECKED	
APPROVED	
ENGINEER	
DESIGNER	

Tuesday, December 23, 2003



1630 McCarthy Blvd.  
Milpitas, CA 95035  
Phone: (408)432-1900  
Fax: (408)434-0507

TITLE  
**SCH, LTC1921CMS8 DUAL -48V SUPPLY  
AND FUSE MONITOR**

SIZE	CAGE CODE	DWG NO	REV
A		DC548A	2
SCALE NONE		FILENAME: 548A-2.DSN	SHEET 1 OF 1