

REVISION HISTORY			
ECO REV	DESCRIPTION	APPR	DATE
1	1ST PROTOTYPE	CLARENCE M.	10-22-10

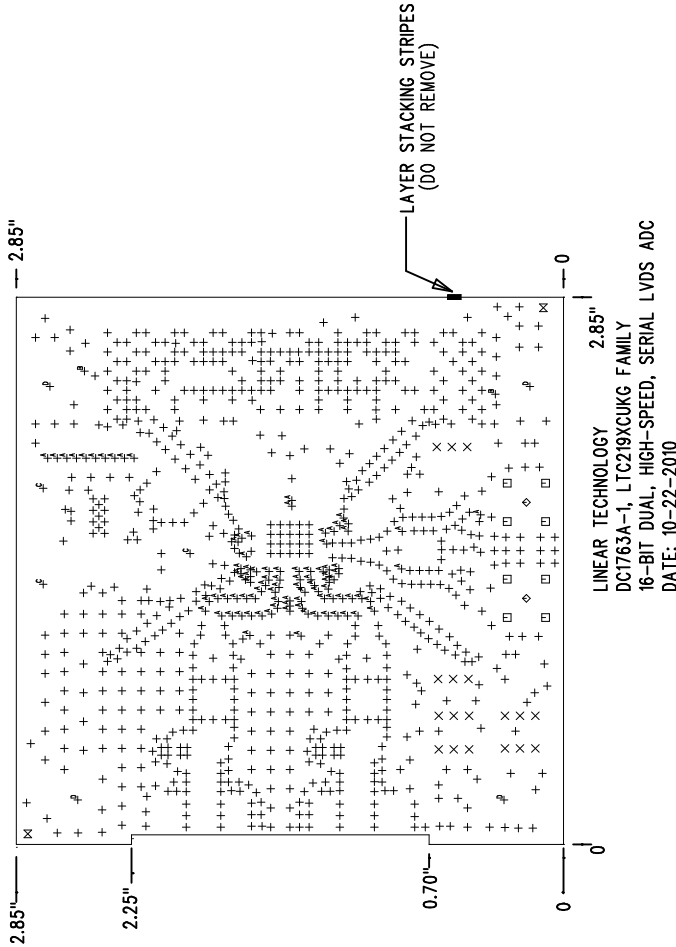

LINEAR TECHNOLOGY
DC1763A-1, LTC219XCUKG FAMILY
16-BIT DUAL, HIGH-SPEED, SERIAL LVDS ADC
DATE: 10-22-2010

9. BOARD USES TWO DIFFERENT FIXED IMPEDANCE DESIGN TECHNIQUES AS FOLLOWS:
9.1 ALL 31.5 MIL WIDE TRACES ON TOP SIDE ARE DESIGNED AS SURFACE MICROSTRIP, AND SHALL HAVE AN IMPEDANCE OF 50 OHMS +/- 10%, MEASURED FROM LAYER 1 TO THE LAYER 3 GROUND PLANE LAYER, AT A FREQUENCY OF 2 GHZ.
9.2 ALL 5 MIL WIDE TRACES ON THE TOP SIDE ARE DESIGNED AS DIFFERENTIAL PAIRS, AND SHALL HAVE A DIFFERENTIAL IMPEDANCE OF 100 OHMS +/- 10%, MEASURED FROM LAYER 1 TO THE LAYER 2 GROUND PLANE LAYER, AT A FREQUENCY OF 2 GHZ.

LAYER STRUCTURE

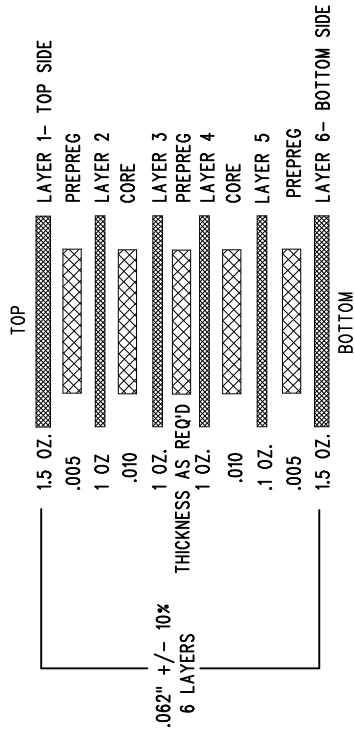

SIZE	QTY	SYM	PLATED	TOL
10	825	+	YES	+/-
35	18	X	YES	+/-
65	8	□	YES	+/-
60	2	◇	YES	+/-
70	2	⋈	NO	+/-
8	92	⊕	YES	+/-
50	2	⊕	NO	+/-
95	3	⊕	YES	+/-
125	4	⊕	YES	+/-

NOTES: UNLESS OTHERWISE SPECIFIED

- FAB PER IPC-A-600.
- MATERIAL: -LEAD FREE ASSEMBLY COMPLIANT, ISOLA FR-370HR OR EQUIVALENT.
-FINISHED THICKNESS TO BE 0.062" +/- .005"
-TOTAL OF 6 LAYERS WITH 0.50Z. CU. OUTER LAYERS, 1 OZ. COPPER INNER LAYERS.
-FLAMMABILITY RATING: 94 V-0 MINIMUM.
0.00" ARE PRIMARY DATUMS.
- SIZE: CUT TO DIMENSIONS AND TOLERANCES SHOWN.
- DRILLING: -DRILL HOLES PER SCHEDULE. PLATE THROUGH HOLES WITH COPPER, 0.001" THICK MIN.
-ALL HOLE SIZES ARE SPECIFIED AFTER PLATING.
-HOLE LOCATION TOLERANCES ARE +/-0.003" IN RELATION TO CENTER
- FINISH: -SMOBC USING LPI BOTH SIDES, COLOR GREEN.
-GOLD IMMERSION BOTH SIDES.
-FOR SILKSCREENS: USE WHITE NON-CONDUCTIVE INK.
DO NOT ALTER ARTWORK e.g. TO ADD LOGO OR DATE CODE. PAD SIZE CAN BE MODIFIED TO MEET END FINISH.
- PCBS ARE TO BE RoHS COMPLIANT.
- SCORING FOR PANELIZED PCB (PRODUCTION FAB ONLY):

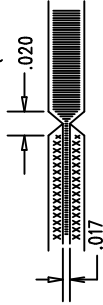

UNLESS OTHERWISE SPECIFIED		APPROVALS	
DIMENSIONS ARE IN INCHES TOLERANCES: 0.XX" = ±0.01" 0.XXX" = ±0.005" INTERPRET DIM AND TOL PER ASME Y14.5M-1994 THIRD ANGLE PROJECTION		PCB DES.	MH
		APP ENG.	CLARENCE M.
		TITLE: FABRICATION DRAWING 16-BIT DUAL, HIGH SPEED, SERIAL LVDS ADC	
		SIZE	IC NO. LTC219XCUKG FAMILY
		N/A	REV 1
		SCALE = NONE	
		FILENAME: DC1763A-1.PCB	
		SHT 1 OF 1	

LINEAR TECHNOLOGY
1630 MCCARTHY BLVD
MILPITAS, CA 95035
PH (408)432-9600
WWW.LINEARTECH.COM
LTC219XCUKG-1
FOR CUSTOMER USE ONLY