

ADI CONFIDENTIAL -
FOR CUSTOMER USE ONLY

DATE: 10-09-2017
DC2645A-1-LTCT294
WIDEBAND IQ DEMODULATOR
ANALOG DEVICES
BOTTOM SILKSCREEN

UNLESS OTHERWISE SPECIFIED

DIMENSIONS ARE IN INCHES
TOLERANCES:

0.XX" = ± 0.01 "

0.XXX" = ± 0.005 "

INTERPRET DIM AND TOL
PER ASME Y14.5M-1994
THIRD ANGLE PROJECTION

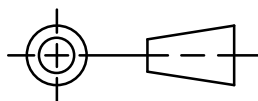

APPROVALS

| | |
|----------|----------|
| PCB DES. | AK. |
| APP ENG. | SUNNY H. |

SCALE = NONE



AHEAD OF WHAT'S POSSIBLE™

1630 MCCARTHY BLVD
MILPITAS, CA 95035
PH: (408)432-1900
CONFIDENTIAL -
FOR CUSTOMER USE ONLY

TITLE: BOTTOM ASSEMBLY DRAWING

WIDEBAND IQ DEMODULATOR

| | | |
|-------------|--|----------|
| SIZE N/A | IC NO. LTC5594IUH DEMO CIRCUIT 2645A | REV 1 |
|-------------|--|----------|

FILENAME: DC2645A-1.PCB

SHT 1 OF 1