

# Section 7

## Schematic Diagrams

### TABLE OF CONTENTS

FIGURE	TITLE	PAGE
7-1.	Mnemonics .....	7-2
7-2.	A1 Main PCB Assembly, Line Supply .....	7-3
7-3.	A1 Main PCB Assembly, Schematic .....	7-4
7-4.	A1 Main PCB Assembly, Battery Option-01 .....	7-6

**SCHEMATIC DIAGRAMS  
MNEMONICS**

AC X 1	AC buffer gain of 1 command
AC X 100	AC Buffer gain of 100 command
AZ	Auto Zero
BP	Back plane drive signal, 50 Hz square wave
BT	Low Battery, indicates that the rechargeable batteries in the -01 Option need recharging
dB	Decibels
DE(+R)	De-integrate plus reference used with a negative input
DE(-R)	De-integrate minus reference used with a positive input
DP	Decimal Point
EXT INT	External Interrupt, stops the counter in the microcomputer
Fa	} Function inputs to microcomputer
Fb	
Fc	
Fd	
HOLD	A 52 $\mu$ sec (maximum) period immediately following INT
HV	High Voltage, comes on when the instrument measures 40V or greater
INT	Integrate
LCD	Liquid Crystal Display
LO	Defines front panel selection of a function/range requiring an A/D gain of 10
$\overline{OL}$	A 5 msec period at the beginning of auto zero when an overrange is detected
P.O.R.	Power On Reset, a 500 msec pulse at turn on which initializes the A/D
REL	Relative, indicates that the readings displayed are relative to the input applied when the RELATIVE switch was set to ON
RNG a	} Range inputs to microcomputer
RNG b	
RNG c	
S	Siemens, $1/\Omega$
ST0	} Five sequential Strobe pulses
ST1	
ST2	
ST3	
ST4	
T&H	Touch & Hold
W	} BCD data lines
X	
Y	
Z	
Z	Impedance

Figure 7-1. Mnemonics

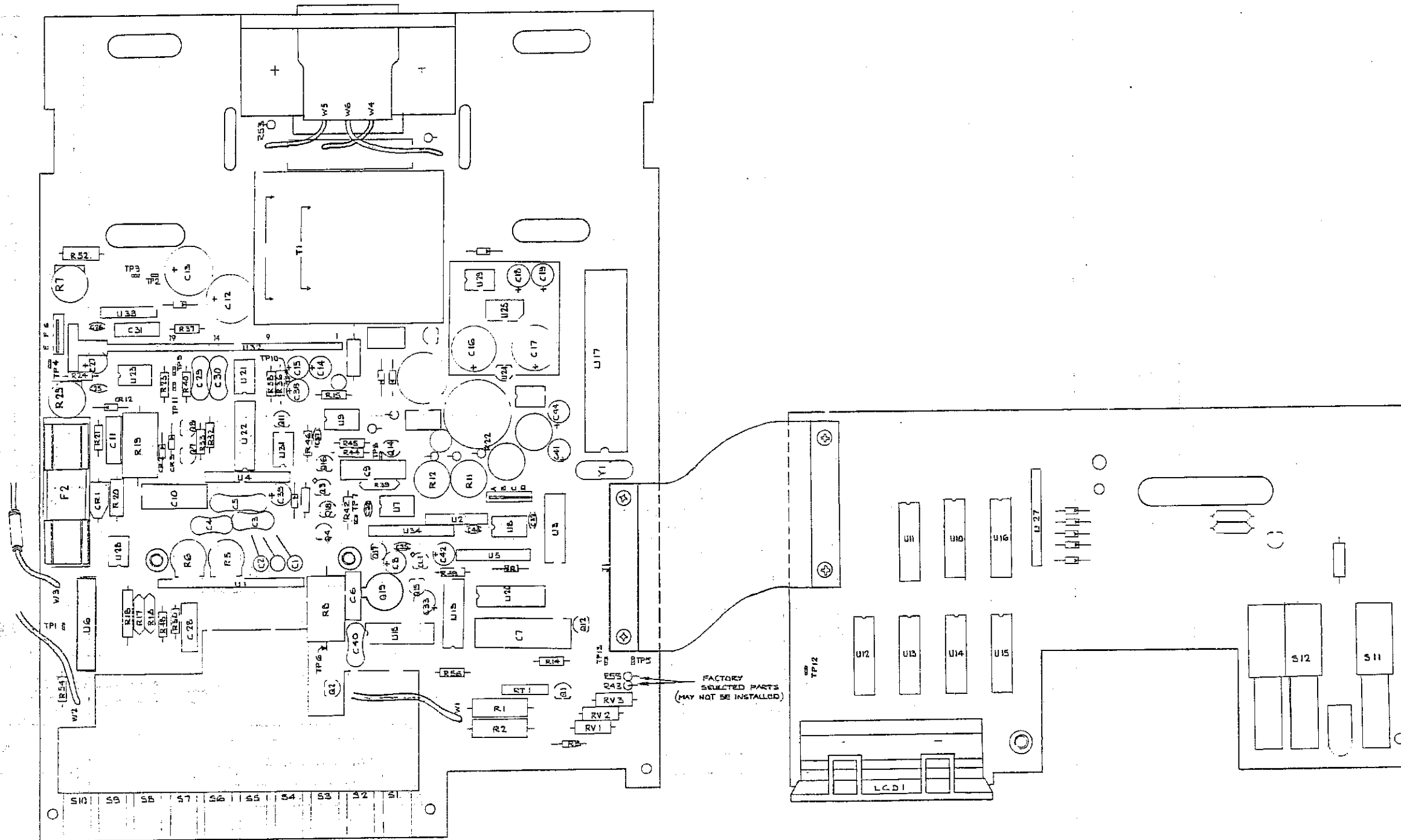

FOR SCHEMATIC DIAGRAM, SEE FIGURE 7-3

8050A-1601

Figure 7-2. A1 Main PCB Assembly, Line Supply

SCHMATIC DIAGRAMS

**CAUTION**  
SUBJECT TO DAMAGE BY  
STATIC ELECTRICITY

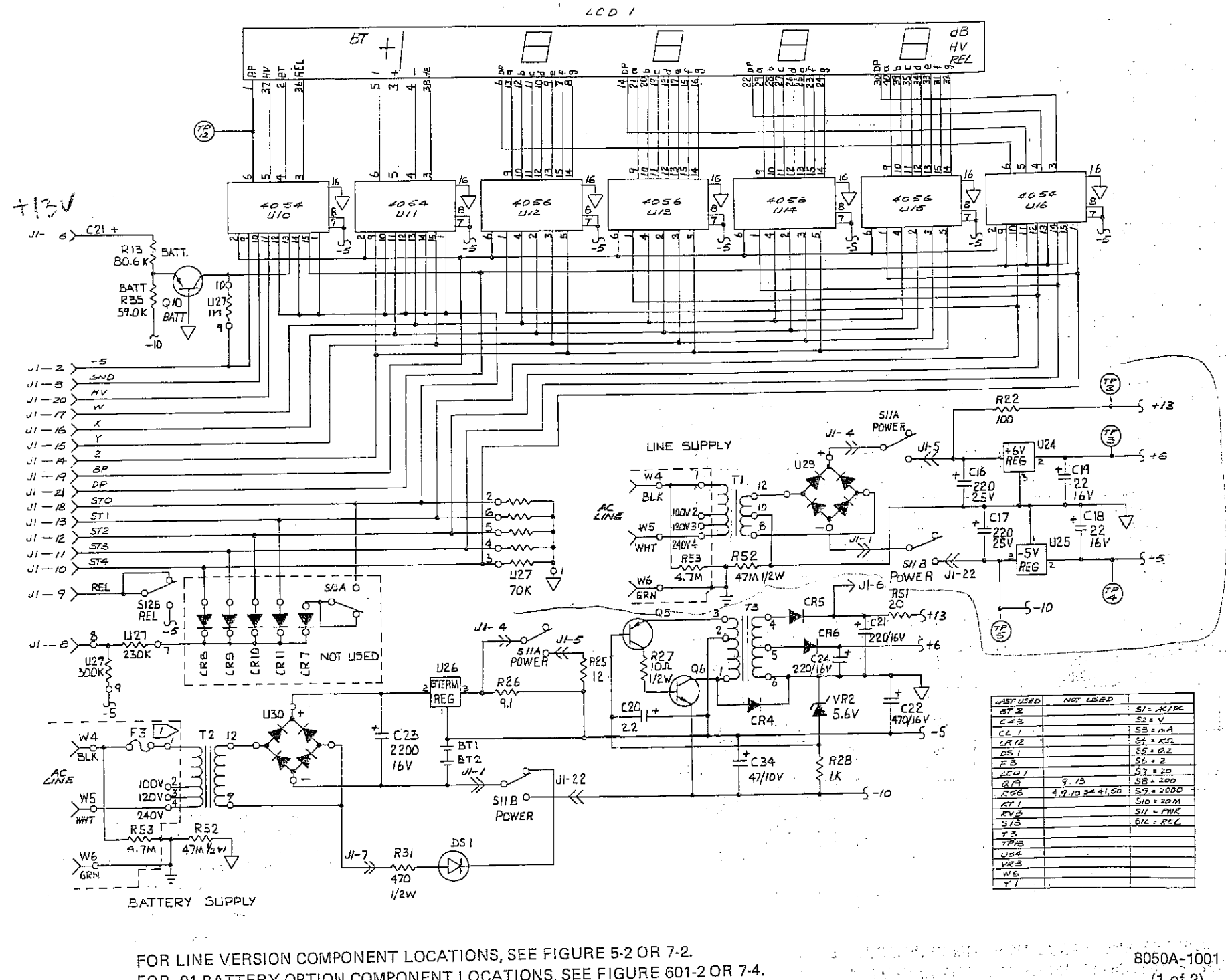

NOTES:

1. 1/16 A FOR 100V AND 120V CONFIGURATION.  
1/32 A FOR 240V CONFIGURATION.
2. ALL RESISTANCE VALUES ARE IN OHMS.  
ALL CAPACITANCE VALUES ARE IN MICROFARADS.
5. FACTORY SELECT.
6.
  - ▽ P.S & DIGITAL COMMON
  - ▽ SENSE COMMON
  - ▽ ANALOG COMMON

FOR LINE VERSION COMPONENT LOCATIONS, SEE FIGURE 5-2 OR 7-2.  
FOR -01 BATTERY OPTION COMPONENT LOCATIONS, SEE FIGURE 601-2 OR 7-4.  
SWITCHES ARE SHOWN IN THEIR RELAXED (OUT) POSITION.

8050A-1001  
(1 of 2)

Figure 7-3. A1 Main PCB Assembly, Schematic

**CAUTION**  
SUBJECT TO DAMAGE BY  
STATIC ELECTRICITY

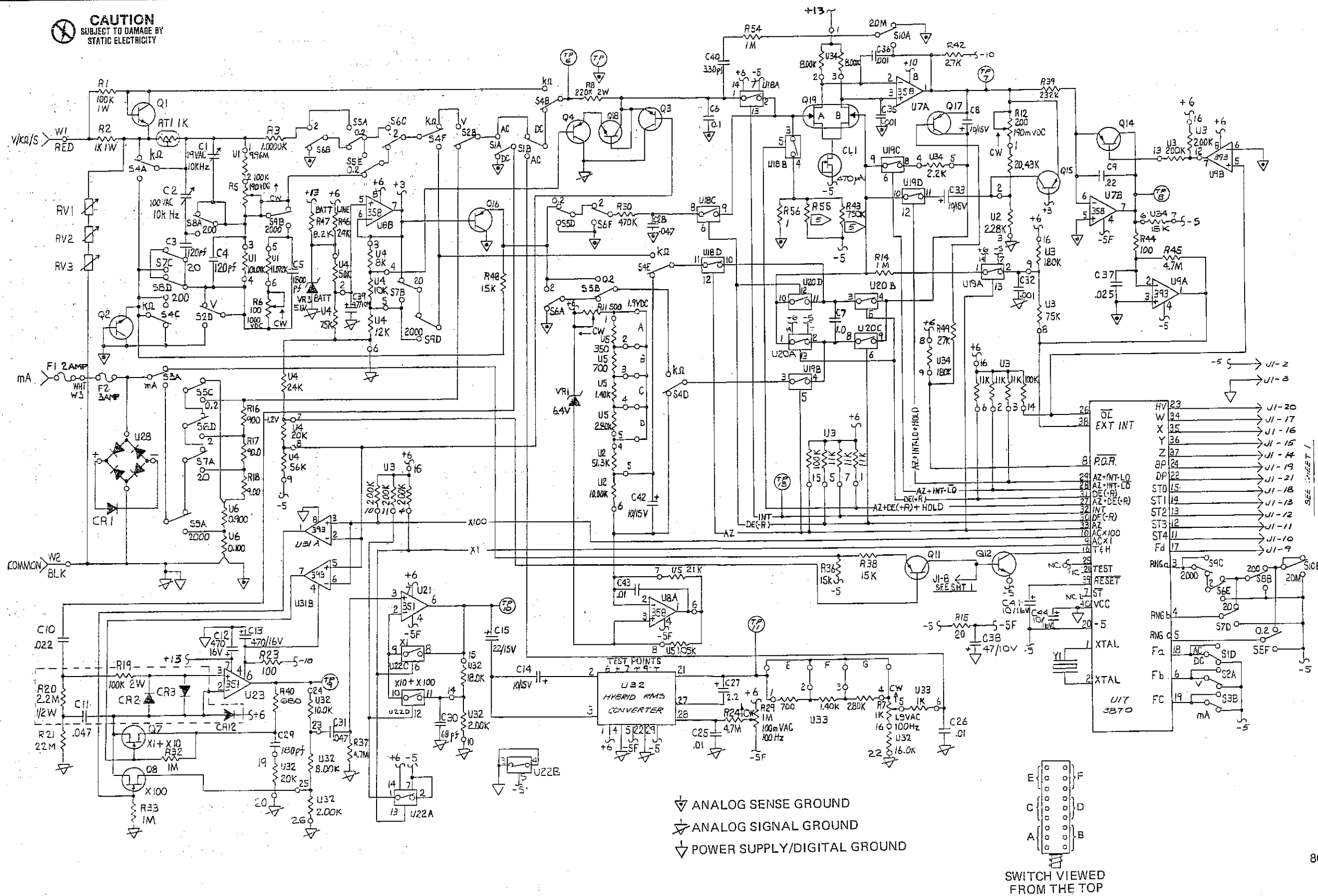

8050A-1001  
(2 of 2)

Figure 7-3. A1 Main PCB Assembly, Schematic (cont)

CAUTION  
SUBJECT TO DAMAGE BY  
STATIC ELECTRICITY

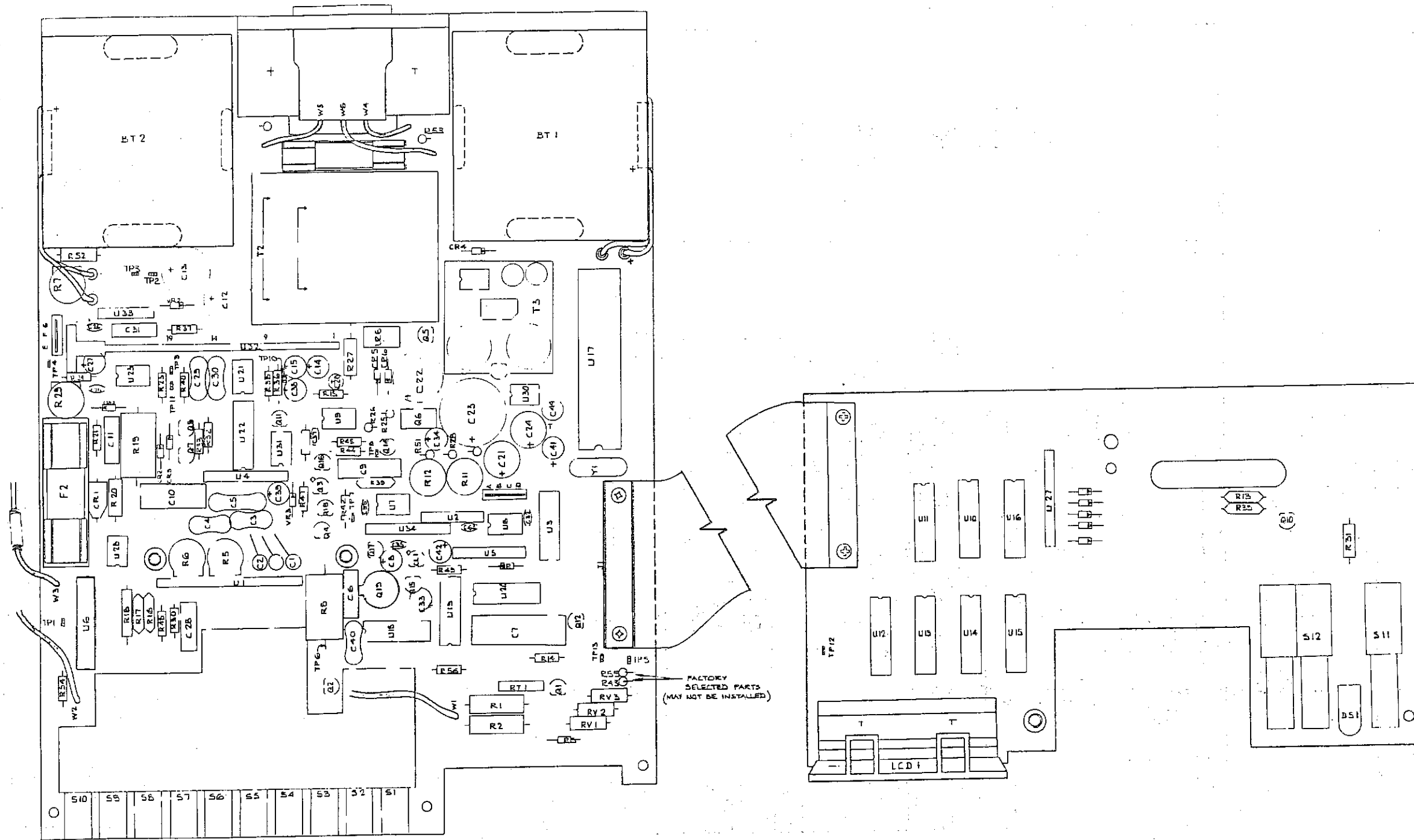

FOR SCHEMATIC DIAGRAM, SEE FIGURE 7-3.

8050A-1611

Figure 7-4. A1 Main PCB Assembly, Battery Option -01