

SECTION 3 - REPLACEMENT PROCEDURES

3-1 GENERAL

This section contains instructions for replacement of any assembly contained in the 2975. The instructions given are for removal of each assembly. Prerequisite instructions are listed as needed. Reassembly is in reverse order of removal instructions unless otherwise noted.

3-1-1 SAFETY PRECAUTIONS

Power should be removed from the unit before any replacement procedure is initiated.

WARNING: DANGEROUS VOLTAGES ARE PRESENT WITH CASE ASSEMBLIES REMOVED IF POWER IS PRESENT.

3-1-2 ESD PRECAUTIONS

CAUTION: THE REPLACEMENT PROCEDURES FOR THE 2975 SHOULD ONLY BE PERFORMED IN AN ESD ENVIRONMENT AND ALL PERSONNEL PERFORMING THE REPLACEMENT PROCEDURES SHOULD HAVE KNOWLEDGE OF ACCEPTED ESD PRACTICES AND/OR BE ESD CERTIFIED.

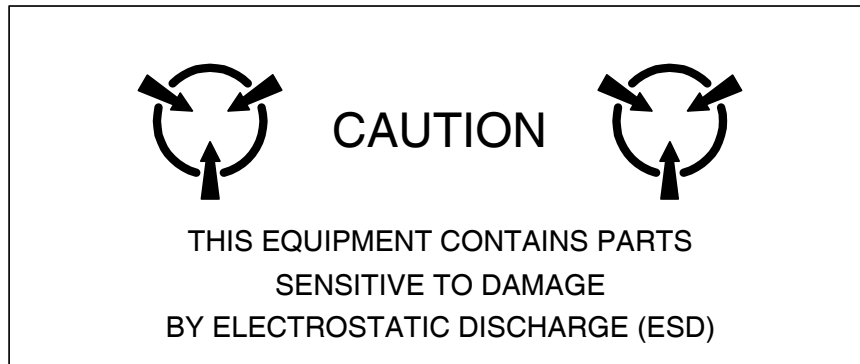

3-2 TOOL REQUIREMENTS

TOOL	SIZE
WRENCH, OPEN END	5/16"
RATCHET / SOCKET	3/16" 1/4"
RATCHET / DEEP SOCKET	9/16"
SCREWDRIVER	Phillips

3-3 REPLACEMENT PROCEDURES

	Page
3-3-1 Remove Case Assy	3-3
3-3-2 Replace Handle	3-4
3-3-3 Replace Attenuator Assy	3-5
3-3-4 Replace Generator Assy	3-6
3-3-5 Replace Receiver Assy	3-7
3-3-6 Replace IF/Video PCB Assy	3-8
3-3-7 Replace Multifunction I/O PCB Assy	3-9
3-3-8 Replace CAI PCB Assy	3-10
3-3-9 Replace CPU Adapter Assy	3-11
3-3-10 Replace Rear Panel Assy	3-12
3-3-11 Replace Rear Panel PCB Assy	3-13
3-3-12 Replace Power Supply Assy	3-16
3-3-13 Replace Disk I/O PCB Assy	3-19
3-3-14 Replace Front Panel Assy	3-20
3-3-15 Replace Front Panel Audio PCB Assy	3-23
3-3-16 Replace Power Termination Assy	3-24
3-3-17 Replace Floppy Drive Assy	3-26
3-3-18 Replace Backplane PCB Assy	3-27

3-3-1 REMOVE CASE ASSY

PRELIMINARY PROCEDURES: None

WARNING: DANGEROUS VOLTAGES ARE PRESENT WITH CASE ASSY REMOVED IF POWER IS PRESENT.

STEP	PROCEDURE
1.	Remove external power sources and all external cables from the 2975.
2.	Remove two screws (1) from each corner securing the Rear Panel Assy (2) to the Case Assy (3).
3.	Remove six screws (4) securing the Rear Panel Assy (2) to the Chassis Assy (5).
4.	Remove the Case Assy (3).

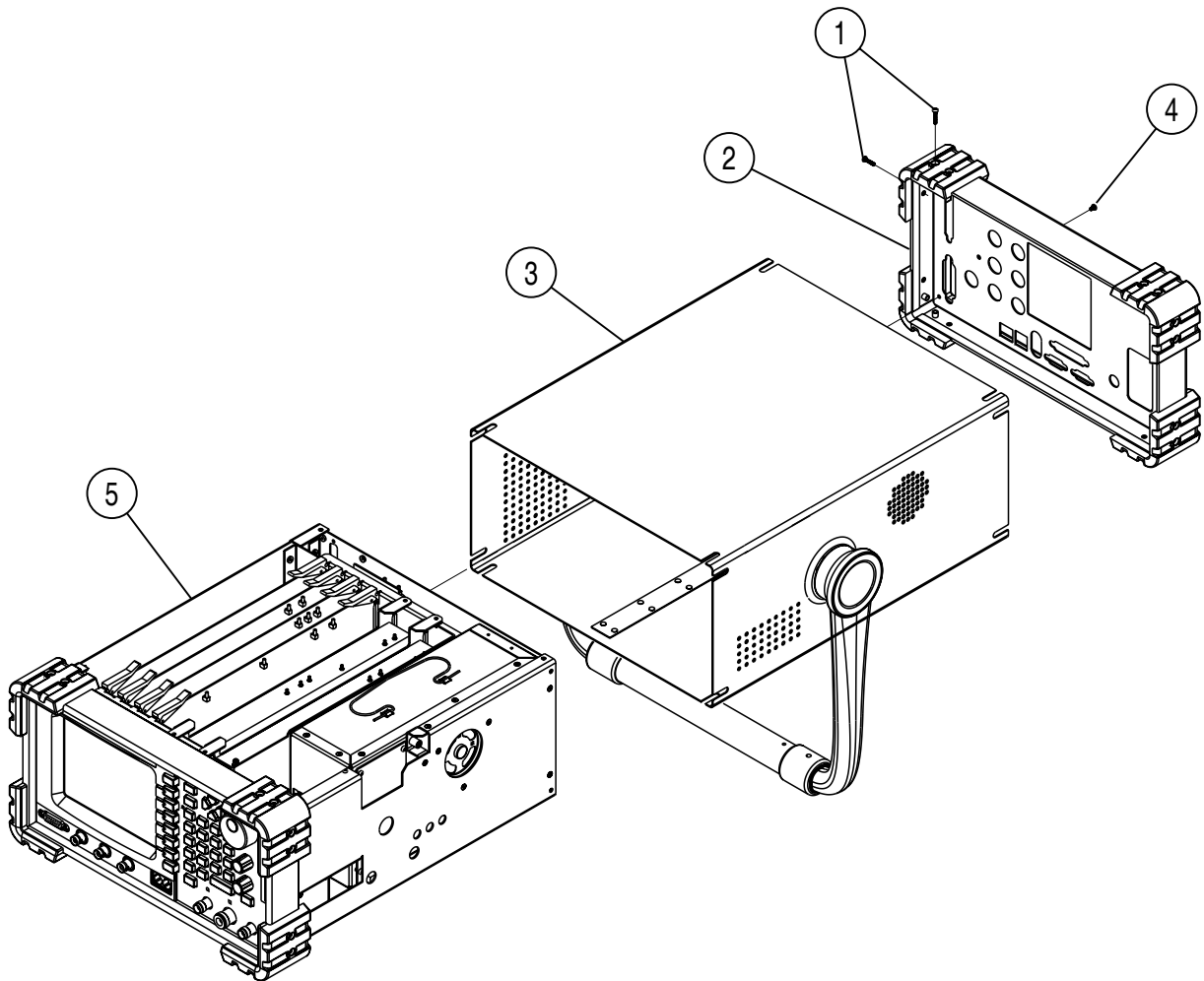

3-3-2 REPLACE HANDLE

PRELIMINARY PROCEDURES: Remove Case Assy (para 3-3-1)

STEP **PROCEDURE**

1. Remove washers (1) securing the Handle (2) to the Case Assy (3).
2. Remove the Handle (2) from the Case Assy (3).

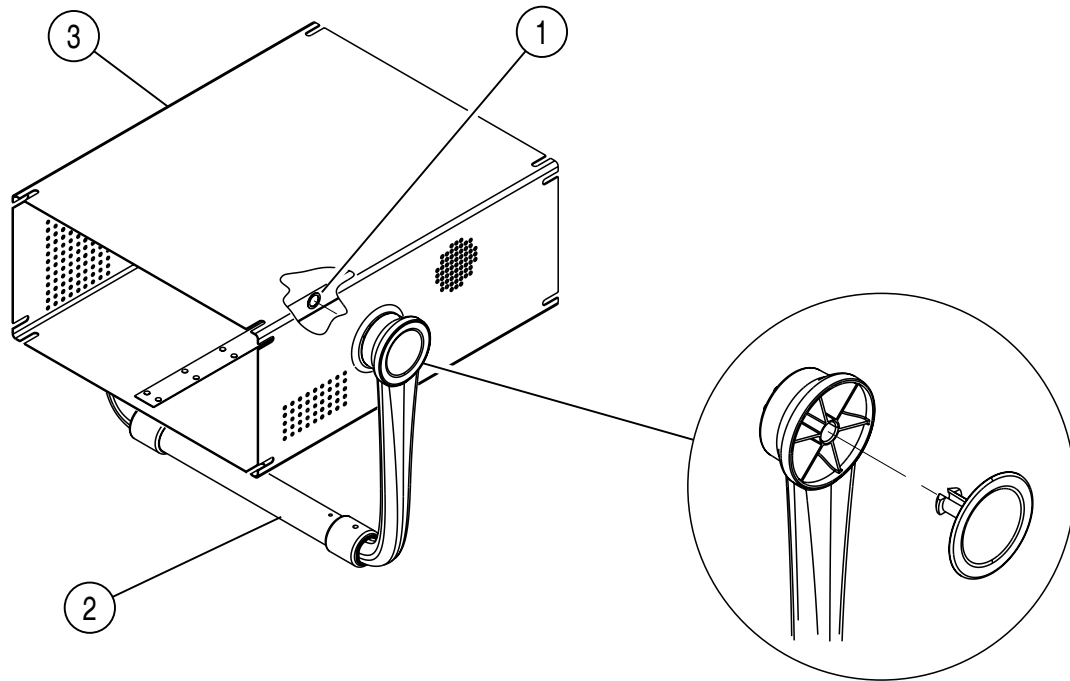

042M-029

3-3-3 REPLACE ATTENUATOR ASSY

PRELIMINARY PROCEDURES: Remove Case Assy (para 3-3-1)

STEP **PROCEDURE**

1. Disconnect the coaxial cable from each end of the Attenuator Assy.

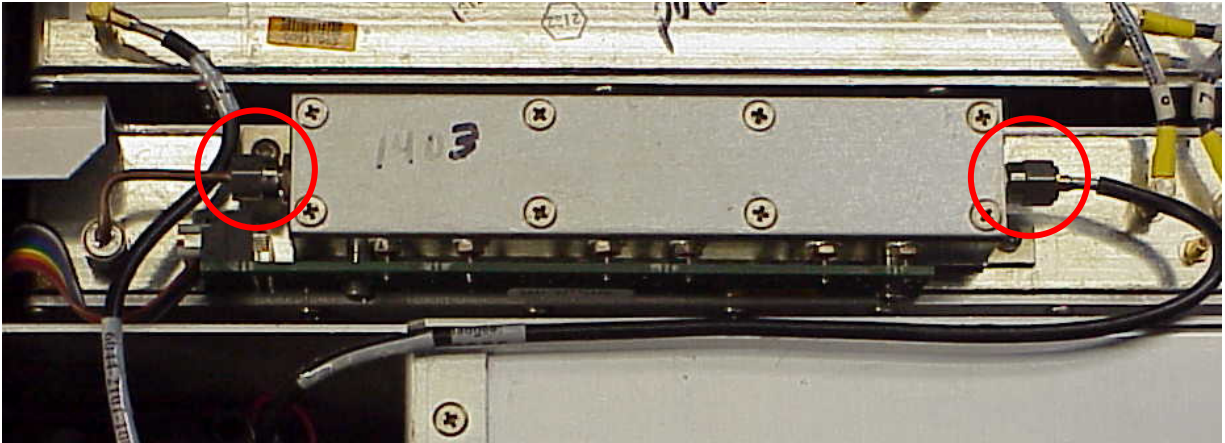

2. Remove two screws securing the Attenuator Assy to the Generator Assy.

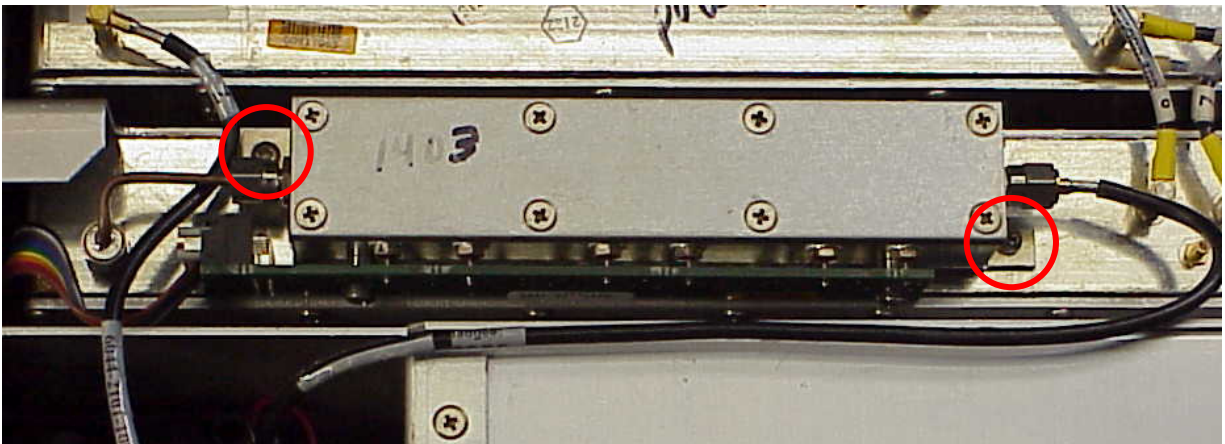

3. Remove the Attenuator Assy.

3-3-4 REPLACE GENERATOR ASSY

PRELIMINARY PROCEDURES: Remove Case Assy (para 3-3-1)
Remove Attenuator Assy (para 3-3-1)

STEP	PROCEDURE
------	-----------

1. Disconnect four coaxial cables from the Generator Assy.

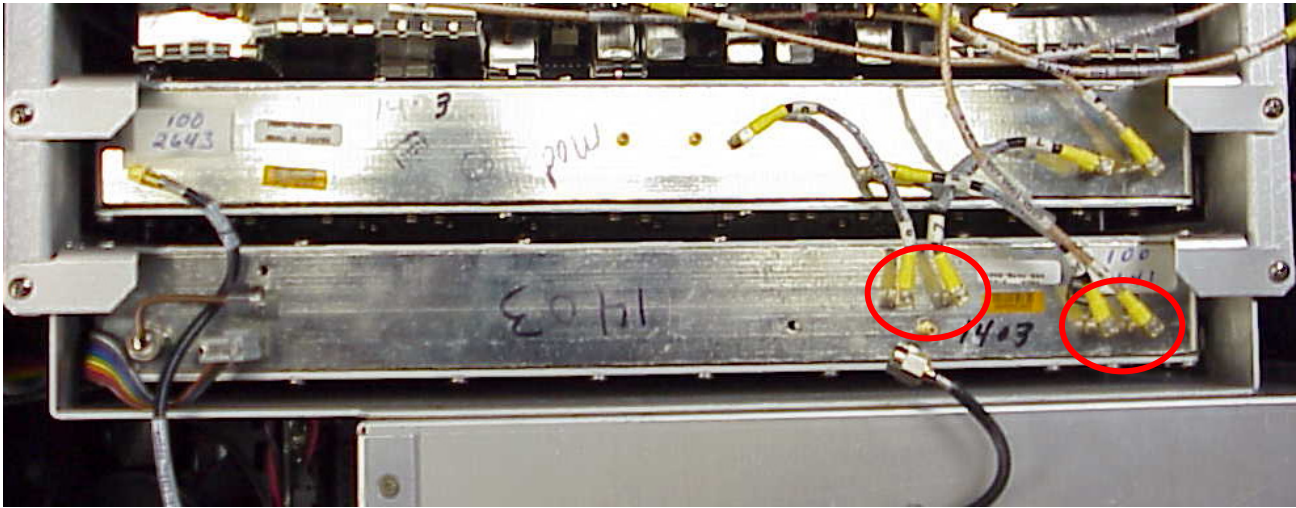

2. Remove two screws securing the Generator Assy to the Chassis Assy.

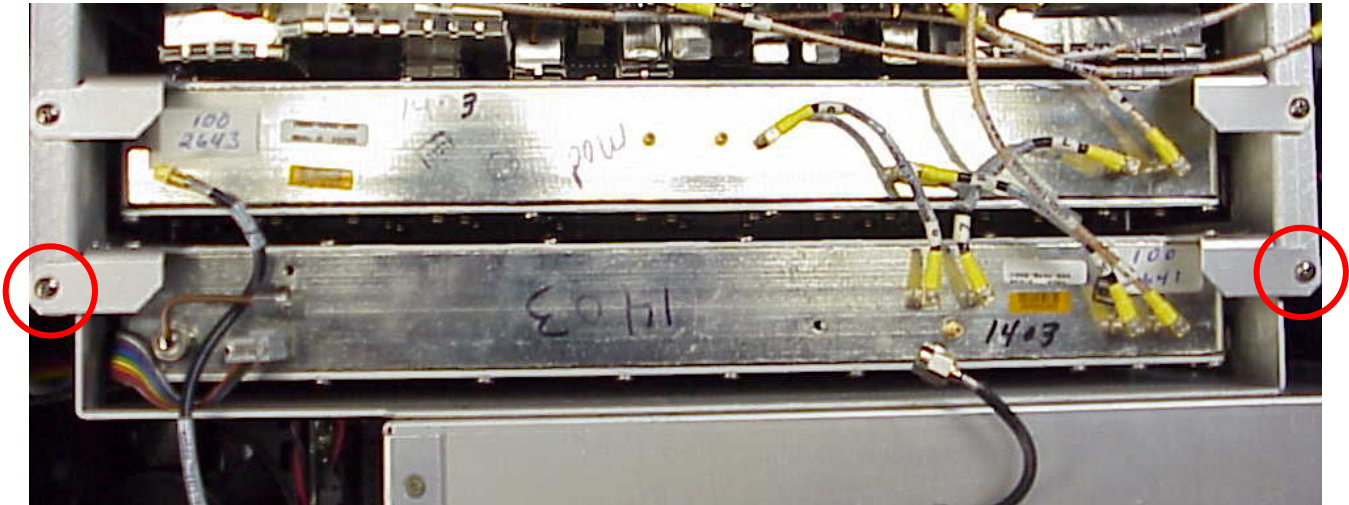

3. Remove the Generator Assy.

3-3-5 REPLACE RECEIVER ASSY

PRELIMINARY PROCEDURES: Remove Case Assy (para 3-3-1)

STEP **PROCEDURE**

1. Disconnect four coaxial cables from the Receiver Assy.

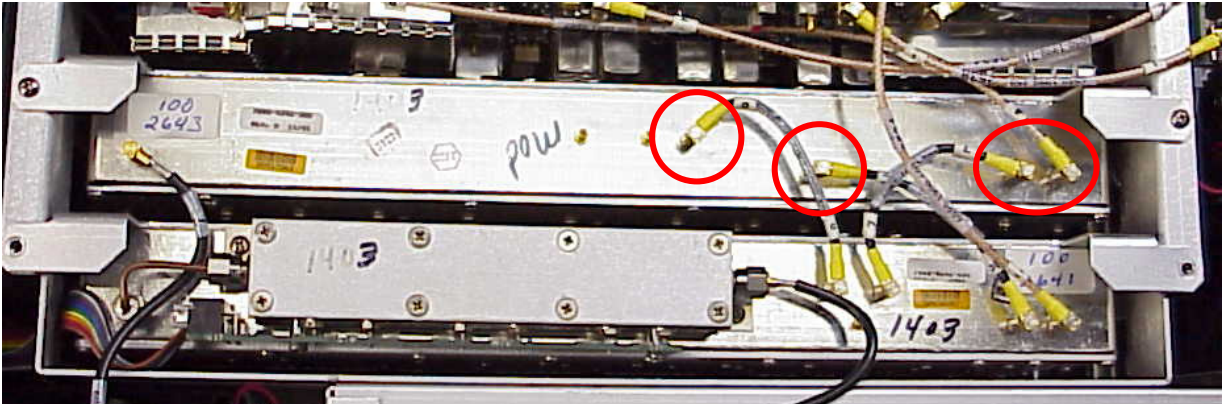

2. Disconnect the coaxial cable from the Generator Assy.

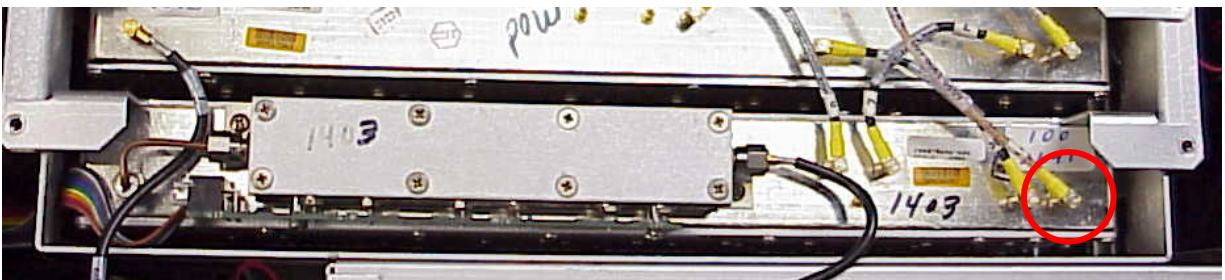

3. Remove two screws securing the Receiver Assy to the Chassis Assy.

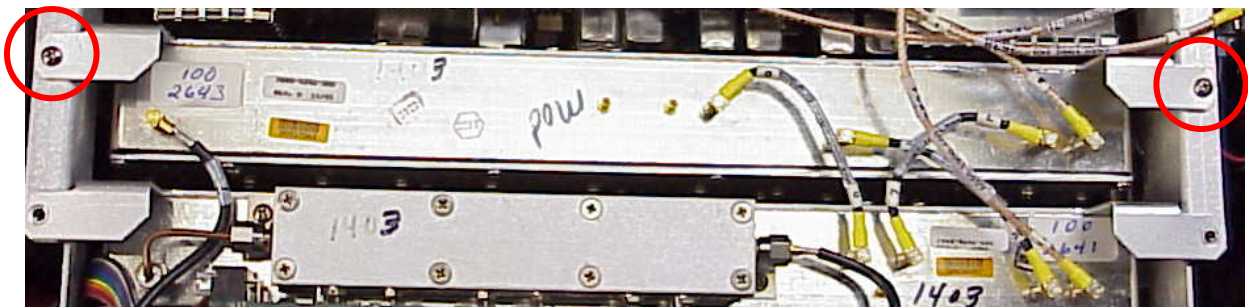

4. Remove the Receiver Assy.

3-3-6 REPLACE IF/VIDEO PCB ASSY

PRELIMINARY PROCEDURES: Remove Case Assy (para 3-3-1)

STEP **PROCEDURE**

1. Disconnect four coaxial cables from the IF/Video PCB Assy.

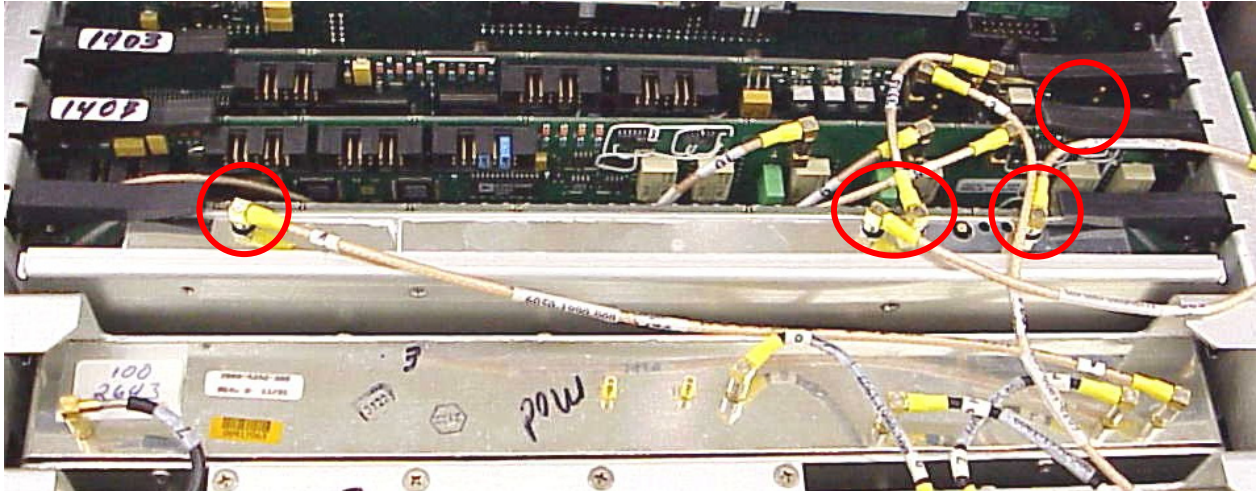

2. Lift up on the card ejectors and remove the IF/Video PCB Assy from the Chassis Assy.

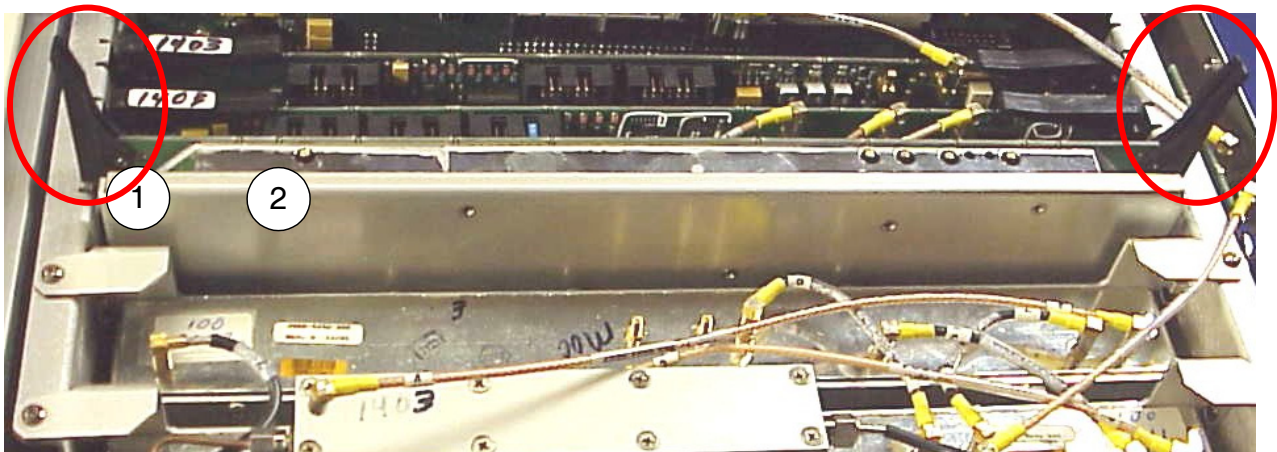

3-3-7 REPLACE MULTIFUNCTION I/O PCB ASSY

PRELIMINARY PROCEDURES: Remove Case Assy (para 3-3-1)

STEP **PROCEDURE**

1. Disconnect the coaxial cable from the IF/Video PCB Assy.

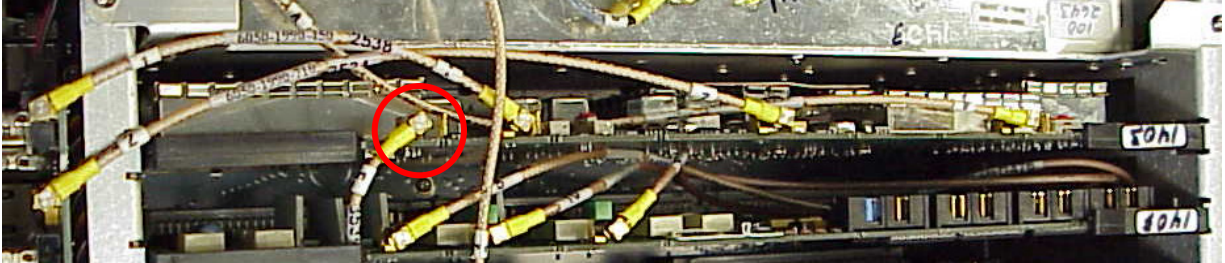

2. Disconnect three coaxial cables from the Multifunction I/O PCB Assy.

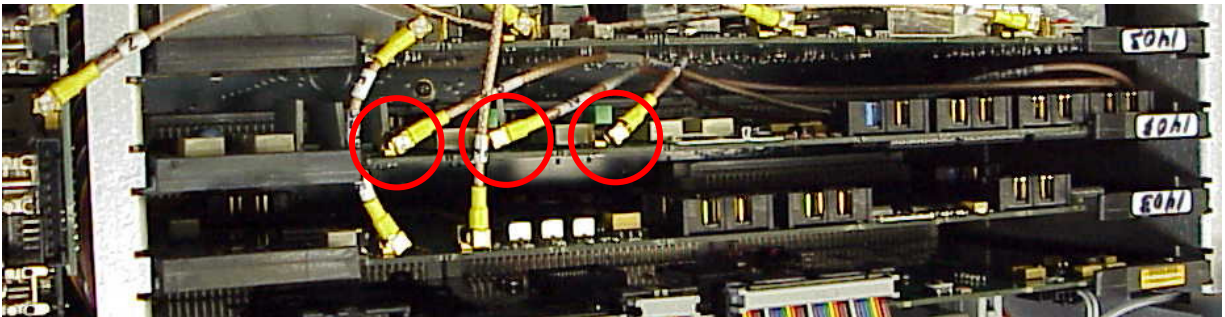

3. Lift up on the card ejectors and remove the Multifunction I/O PCB Assy from the Chassis Assy.

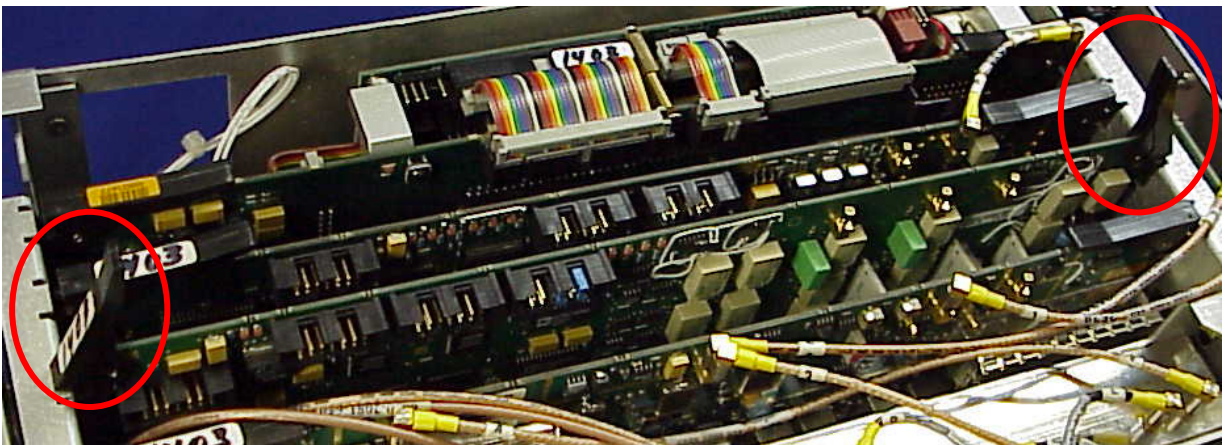

3-3-8 REPLACE CAI PCB ASSY

PRELIMINARY PROCEDURES: Remove Case Assy (para 3-3-1)

STEP **PROCEDURE**

1. Disconnect two coaxial cables from the CAI PCB Assy.

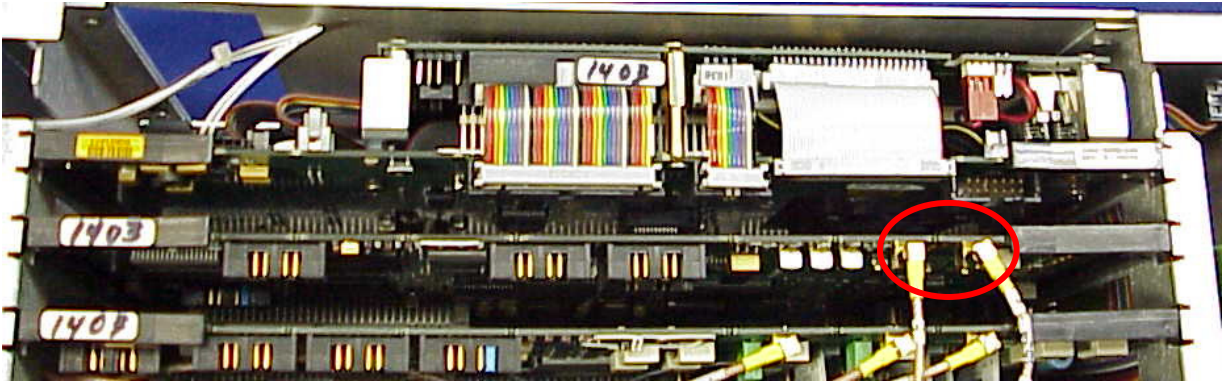

2. Lift up on the card ejectors and remove the CAI PCB Assy from the Chassis Assy.

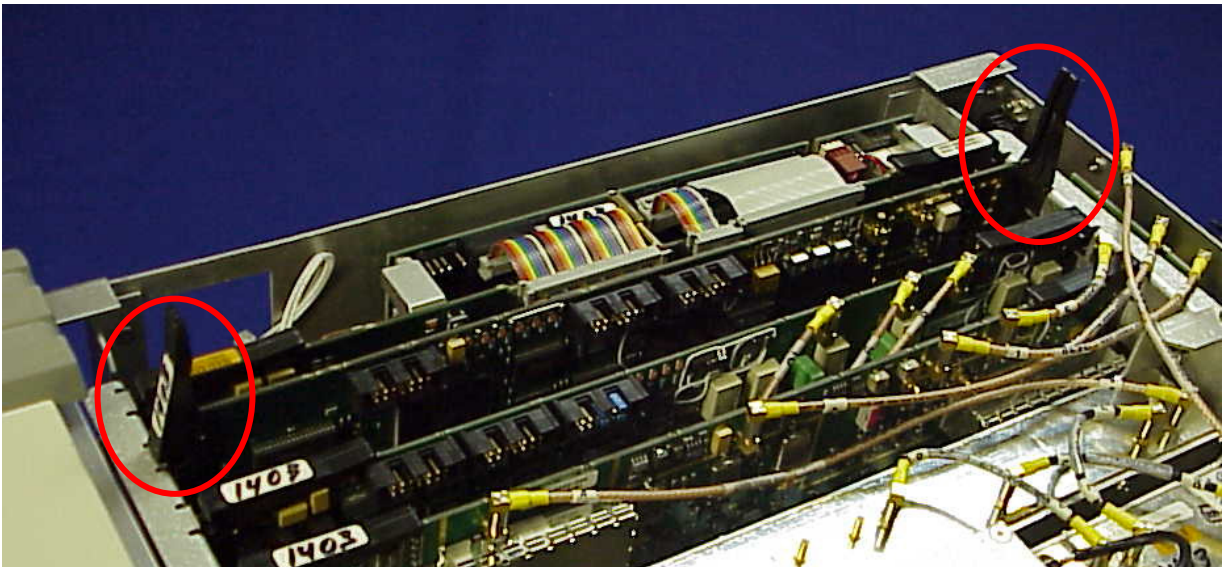

3-3-9 REPLACE CPU ADAPTER ASSY

PRELIMINARY PROCEDURES: Remove Case Assy (para 3-3-1)

STEP **PROCEDURE**

1. Disconnect the wire cable and ribbon cable from the CPU Adapter PCB Assy.

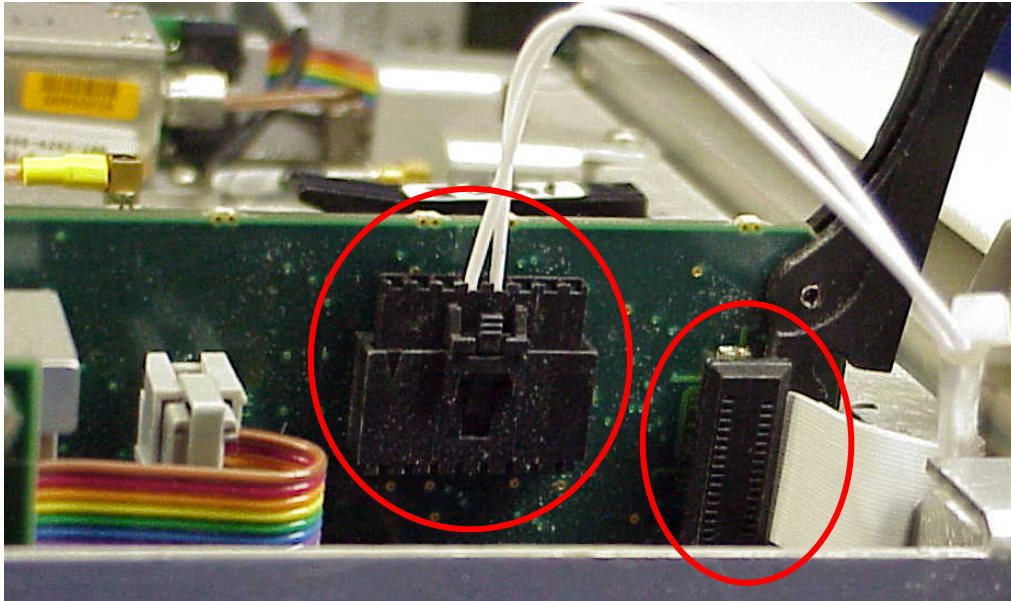

2. Lift up on the card ejectors and remove the CPU Adapter PCB Assy from the Chassis Assy.

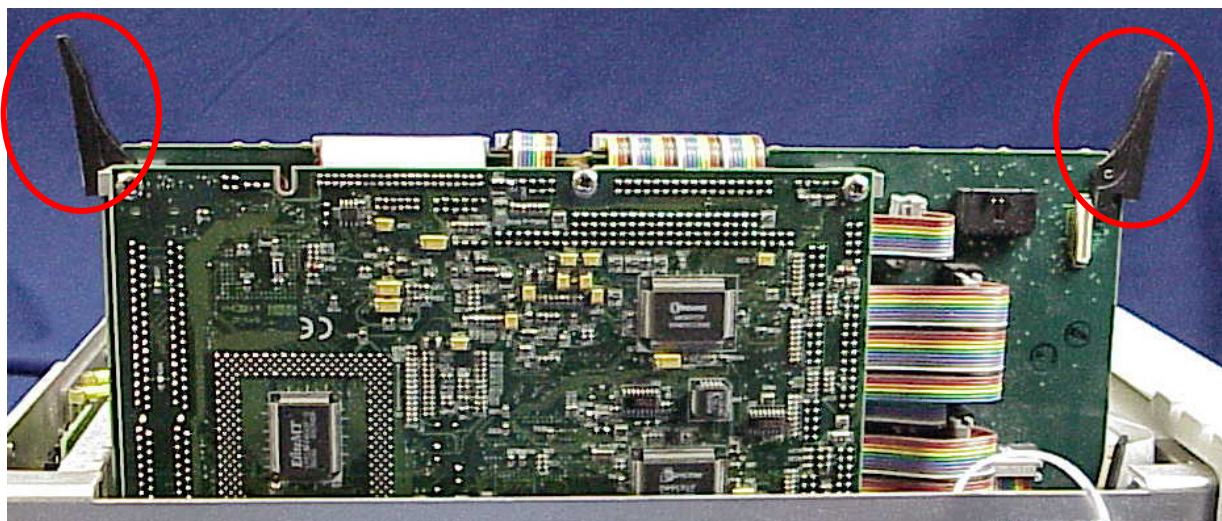

3-3-10 REPLACE REAR PANEL ASSY

PRELIMINARY PROCEDURES: Remove Case Assy (para 3-3-1)

STEP	PROCEDURE
------	-----------

1. Remove external power sources and all external cables from the 2975.
2. Remove two screws (1) from each corner securing the Rear Panel Assy (2) to the Case Assy (3).
3. Remove six screws (4) securing the Rear Panel Assy (2) to the Chassis Assy (5).
4. Remove the Rear Panel Assy (2).

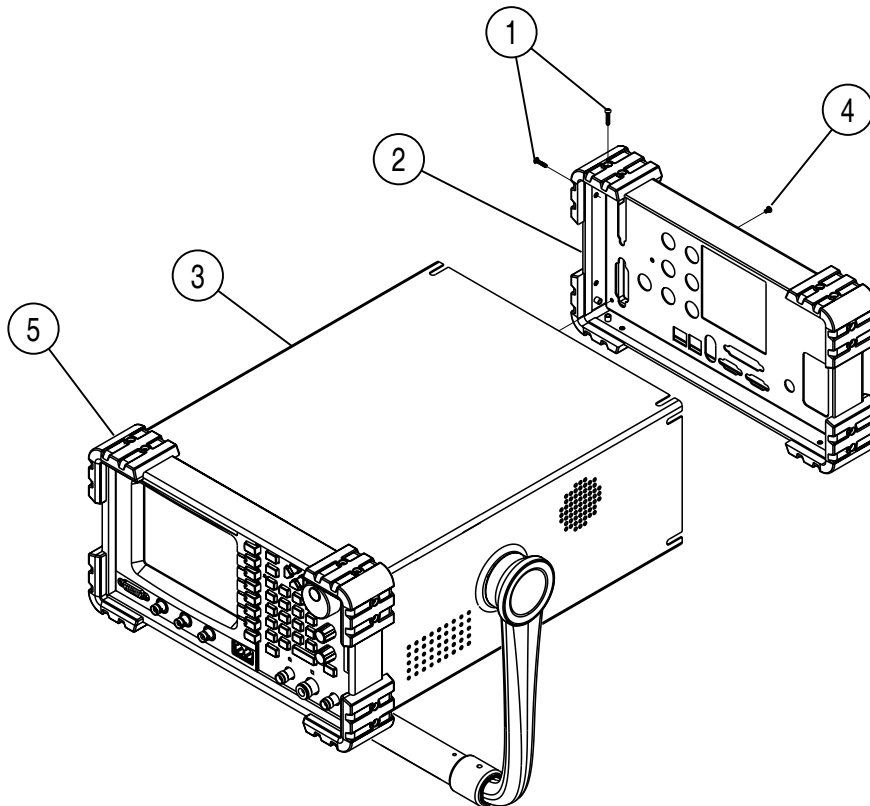

042M-028

3-3-11 REPLACE REAR PANEL PCB ASSY

PRELIMINARY PROCEDURES: Remove Case Assy (para 3-3-1)

STEP **PROCEDURE**

1. Remove two coaxial cables from the Rear Panel PCB Assy.

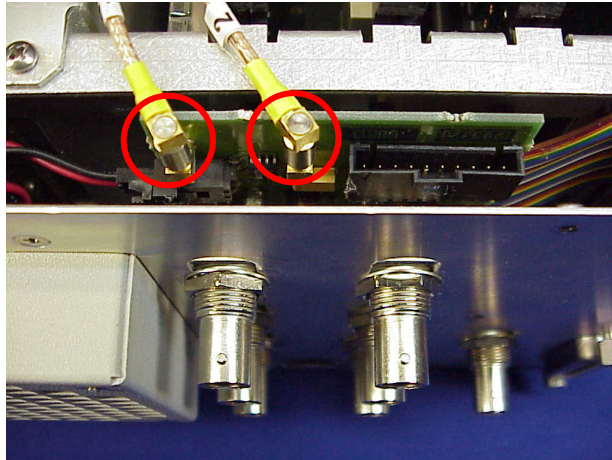

2. Remove the nut and washer from the seven coaxial connectors on the Rear Panel PCB Assy.

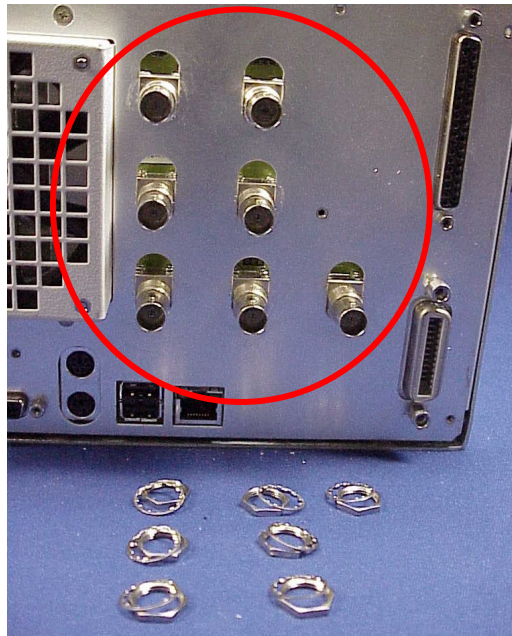

STEP

PROCEDURE

3. Remove five screws.

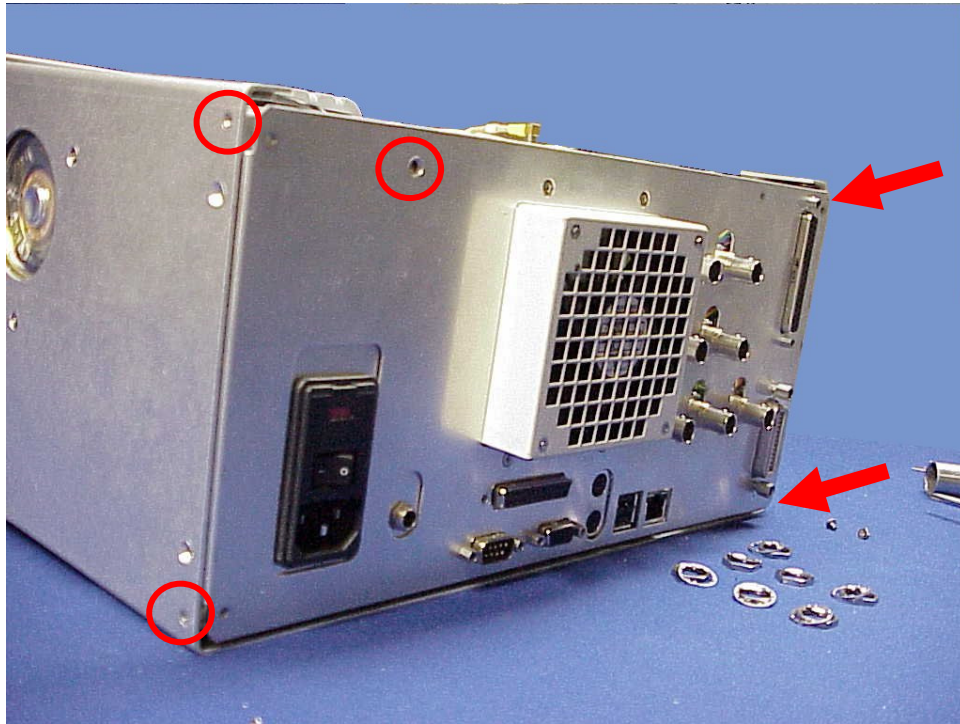

4. Remove nuts (2 each) from three connectors.

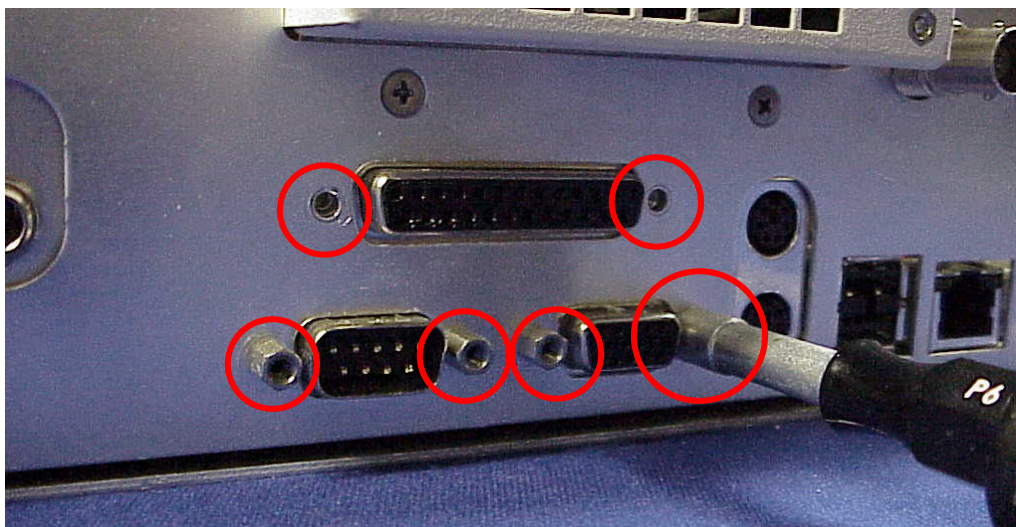

STEP

PROCEDURE

5. Remove the wire cable (Fan) from the Rear Panel PCB Assy.

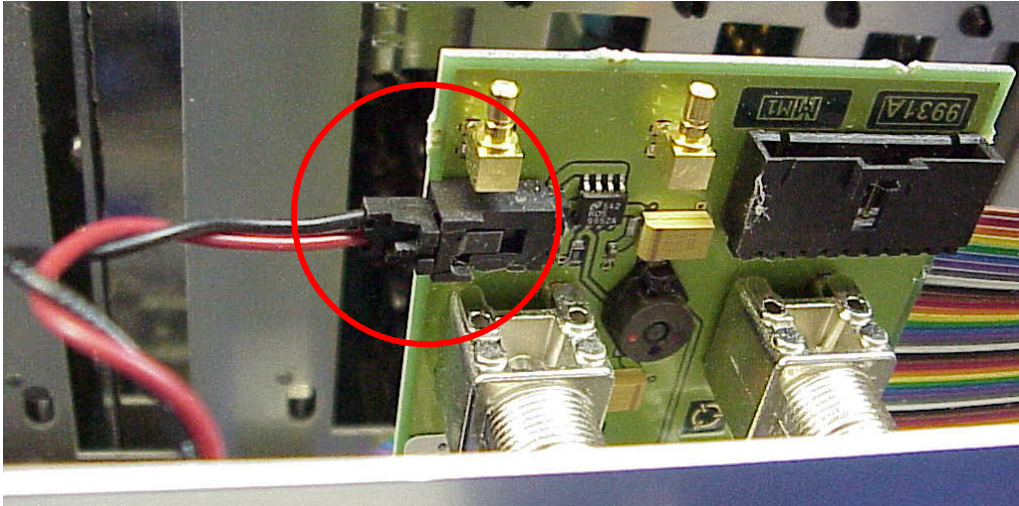

6. Remove the Rear Panel PCB Assy.

3-3-12 REPLACE POWER SUPPLY ASSY

PRELIMINARY PROCEDURES: Remove Case Assy (para 3-3-1)
Remove Attenuator Assy (para 3-3-3)

STEP **PROCEDURE**

1. Remove the screw securing the Power Supply Assy to the Cardcage Assy.

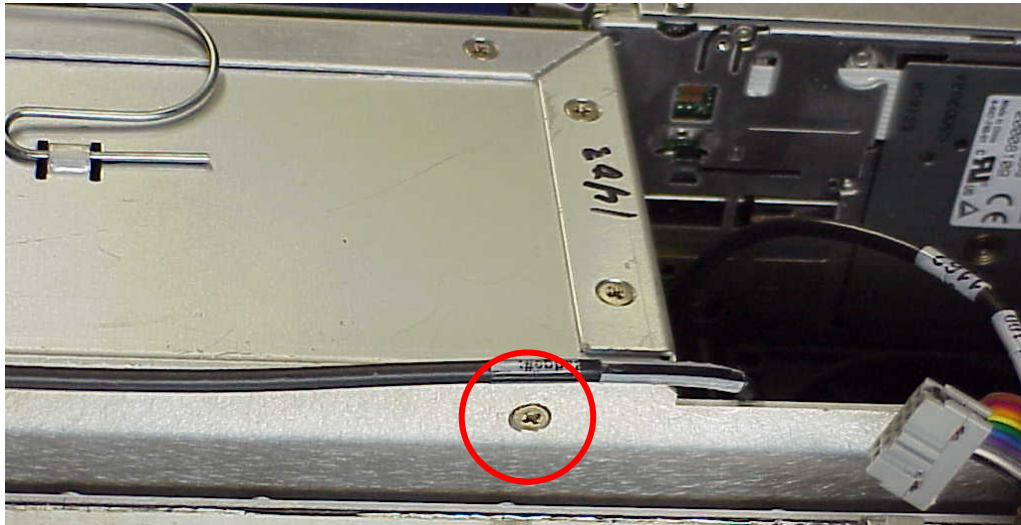

2. Remove five screws.

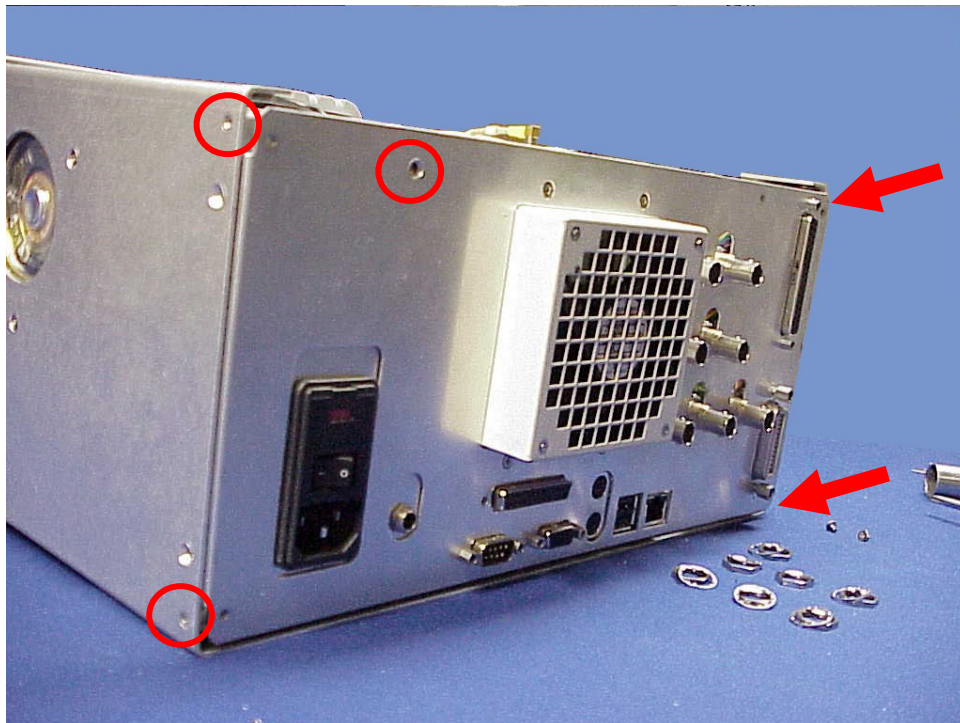

STEP

PROCEDURE

3. Remove nuts (2 each) from three connectors.

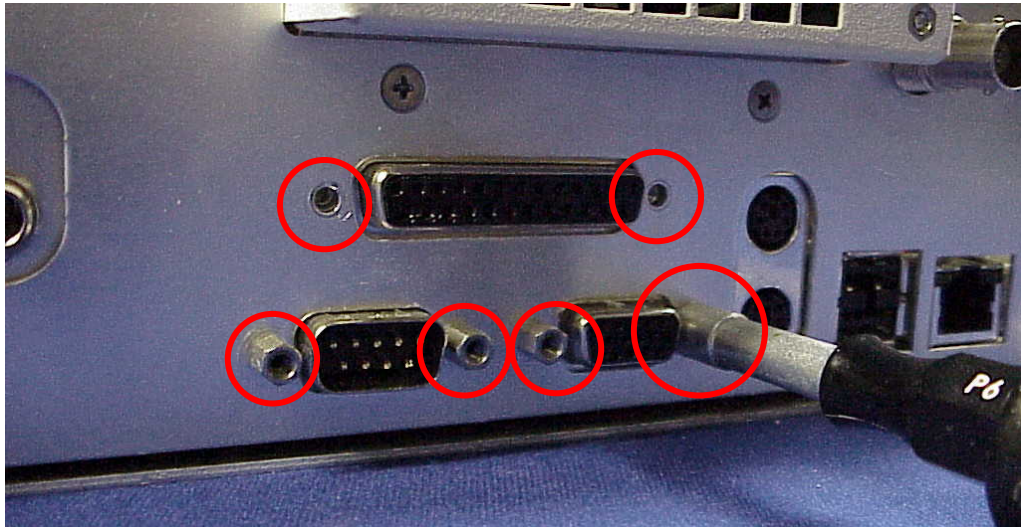

4. Fully loosen the captive screw securing the Power Supply Assy to the Chassis Assy.

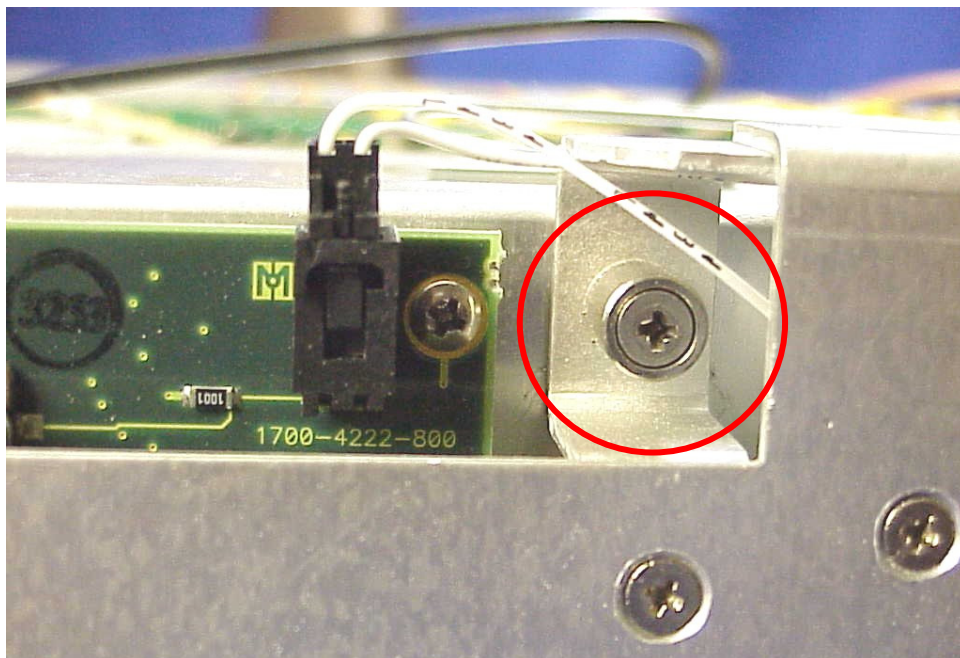

STEP

PROCEDURE

5. Disconnect the wire cable and ribbon cable from the Power Supply Assy.

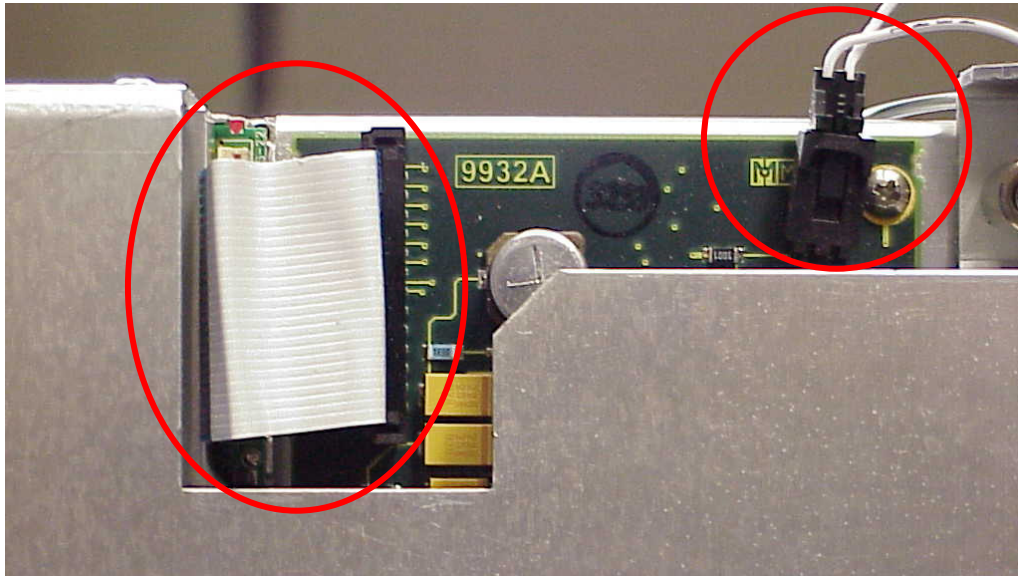

6. Raise the Power Supply Assy straight up and out of the Chassis Assy.

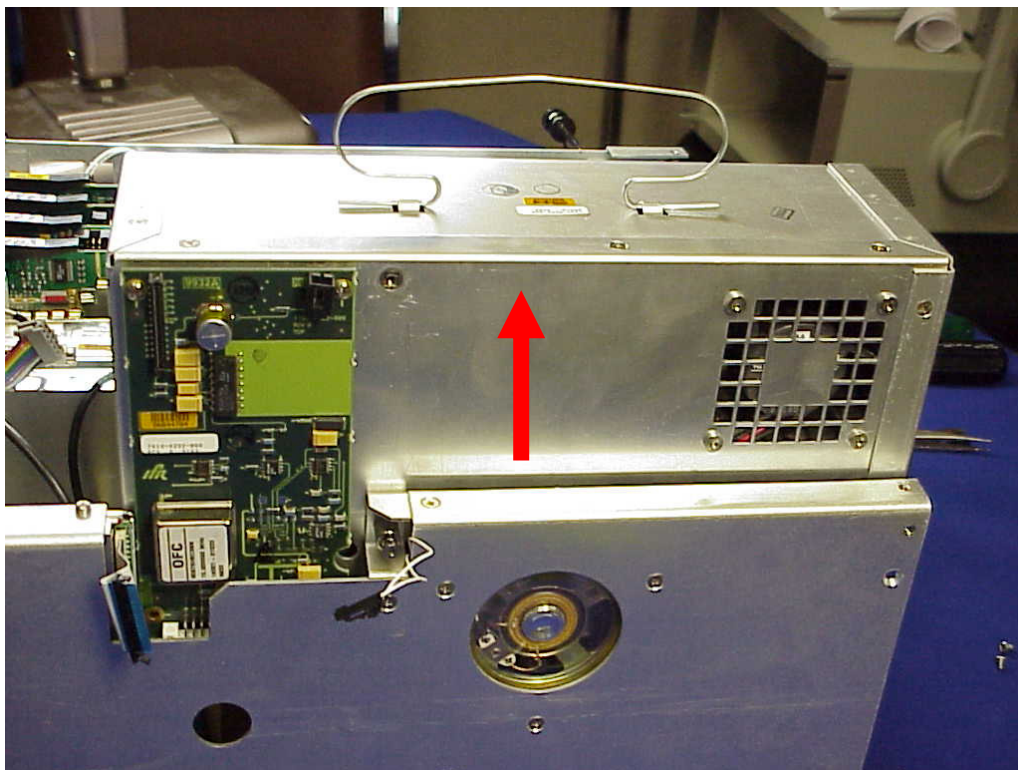

3-3-13 REPLACE DISK I/O PCB ASSY

PRELIMINARY PROCEDURES:

Remove Case Assy (para 3-3-1)

Remove Power Supply Assy (para 3-3-12)

STEP

PROCEDURE

1. Remove two screws securing the Disk I/O PCB Assy to the Power Supply Assy.

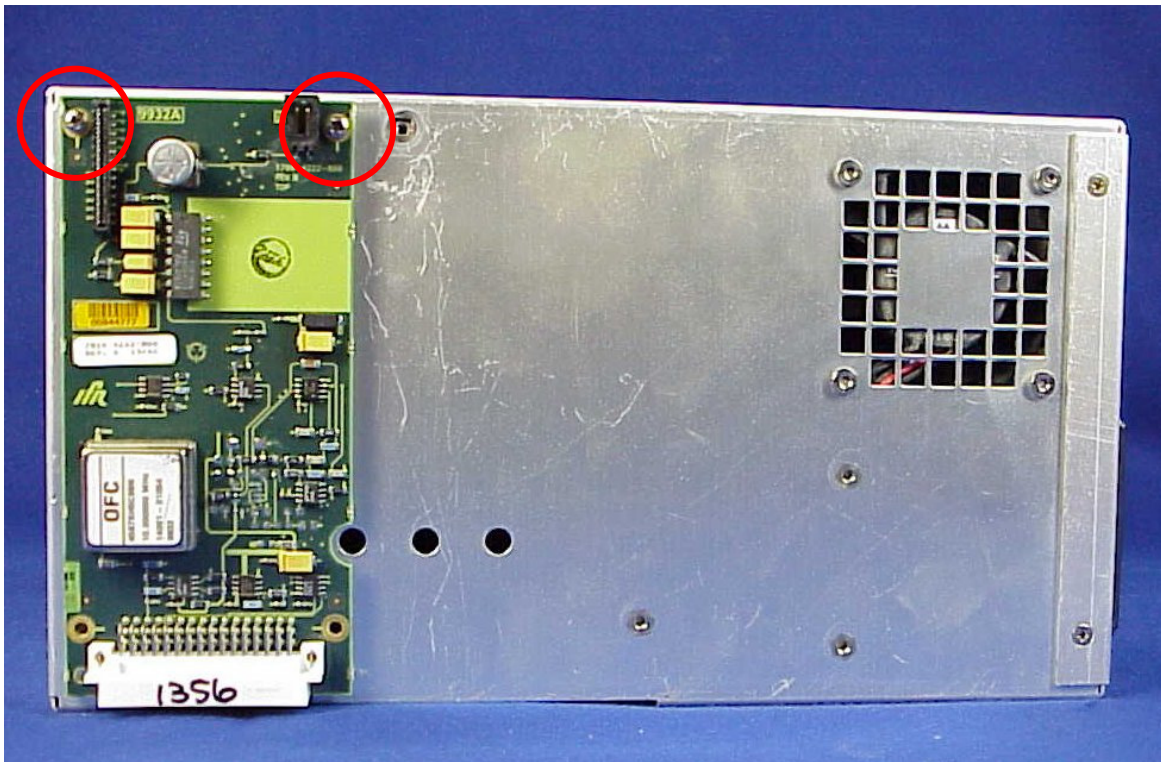

2. Remove the Disk I/O PCB Assy.

3-3-14 REPLACE FRONT PANEL ASSY

PRELIMINARY PROCEDURES: Remove Case Assy (para 3-3-1)

STEP **PROCEDURE**

3. Remove two screws from each corner of the Front Panel Assy.

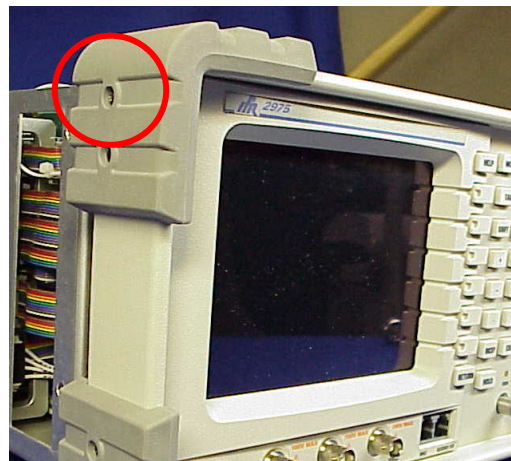
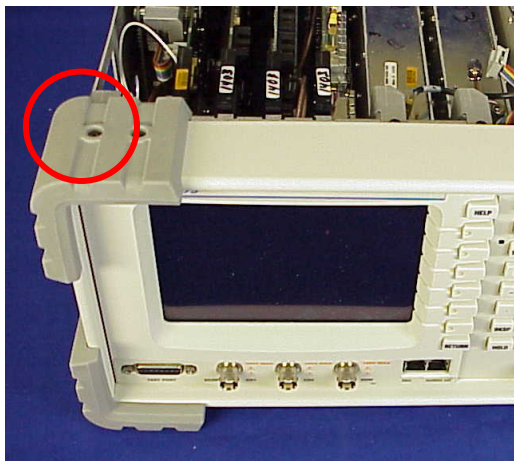

4. Remove two nuts from connector.

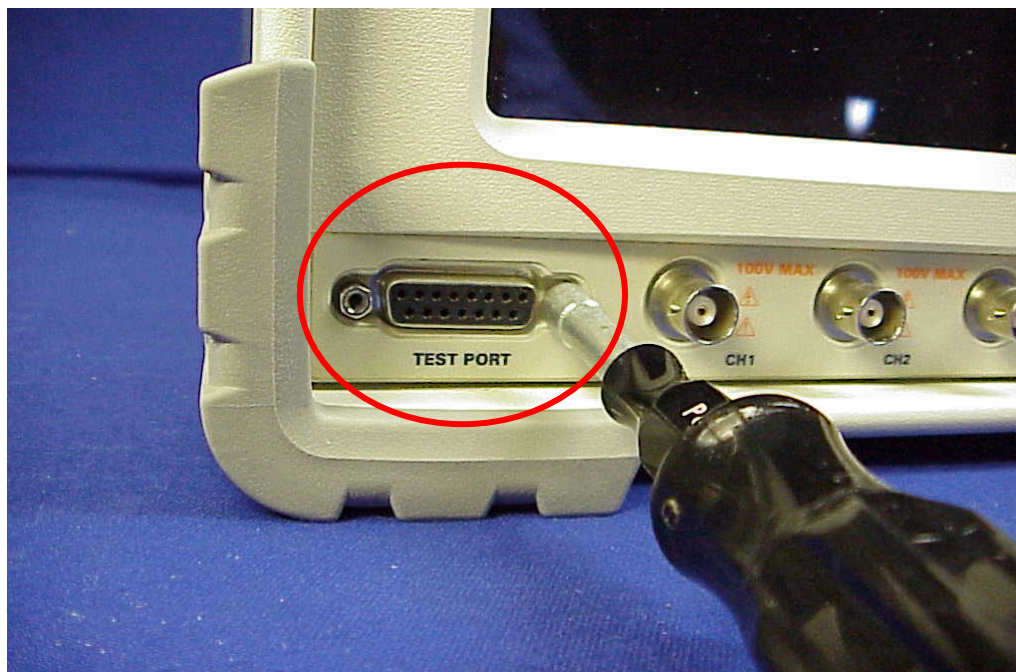

5. Separate the Front Panel Assy from the Chassis Assy.

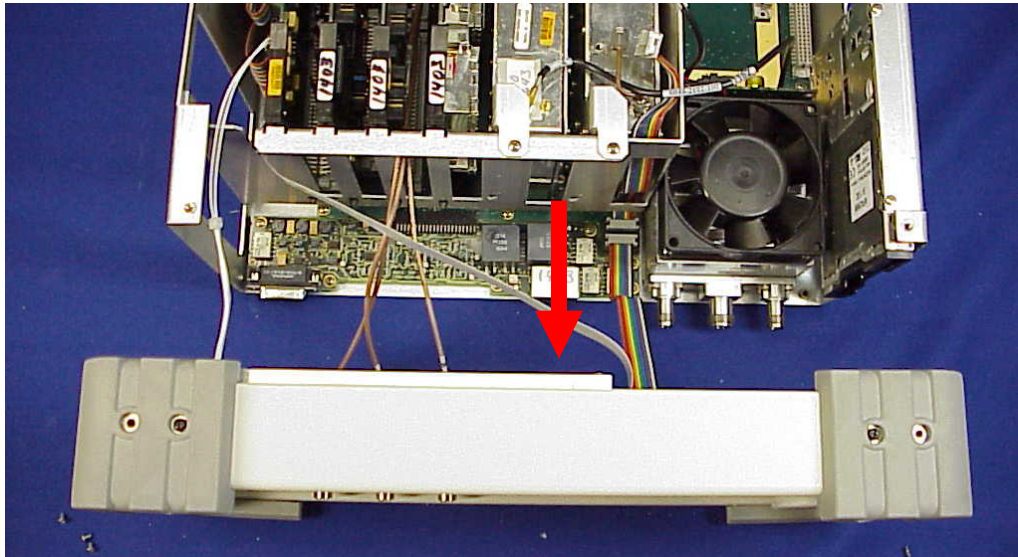

6. Disconnect the wire cable and ribbon cable from the CPU Adapter PCB Assy.

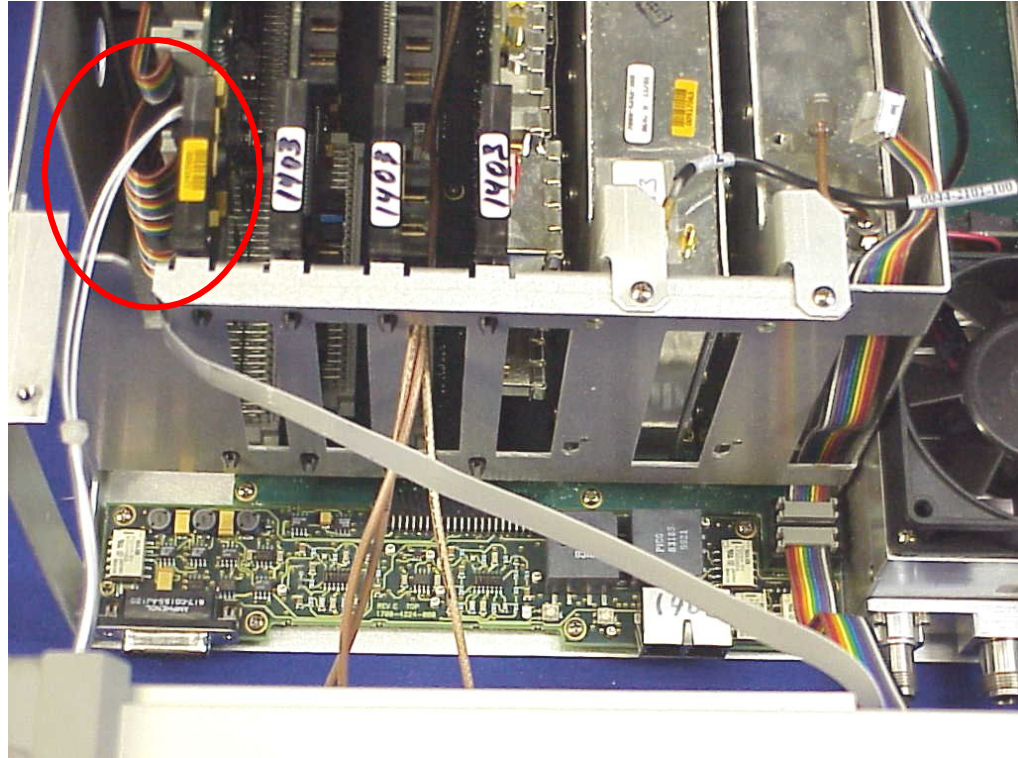

STEP

PROCEDURE

7. Disconnect three coaxial cables from the Front Panel Assy.

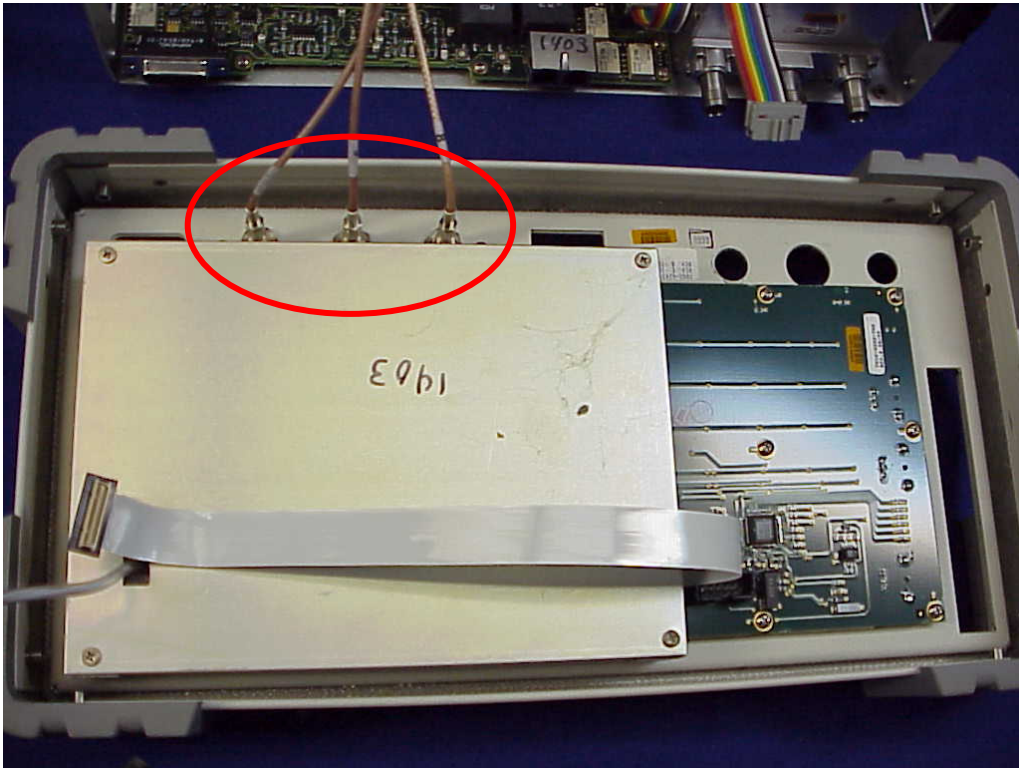

3-3-15 REPLACE FRONT PANEL AUDIO PCB ASSY

PRELIMINARY PROCEDURES: Remove Case Assy (para 3-3-1)
Remove Front Panel Assy (para 3-3-14)

STEP **PROCEDURE**

1. Remove six screws securing the Front Panel Audio PCB Assy to the Chassis Assy.

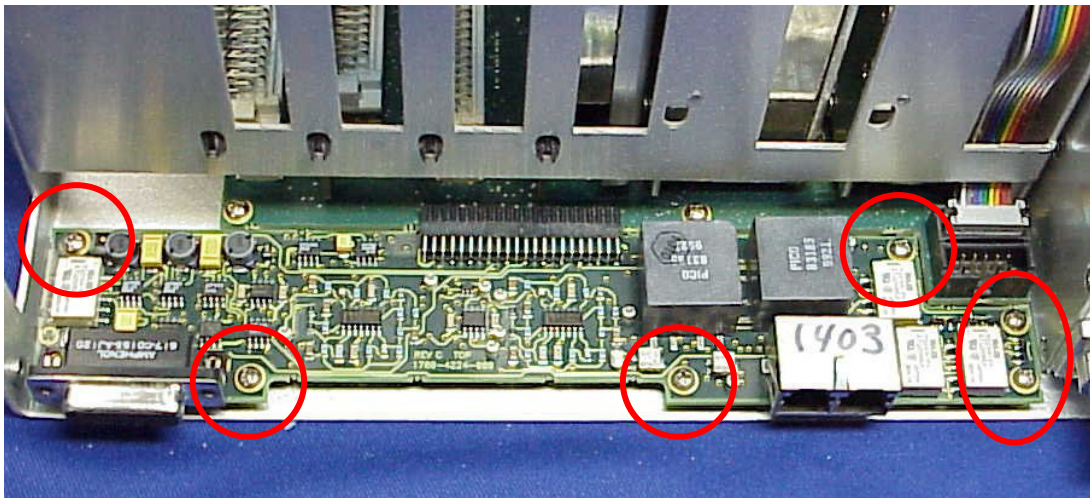

2. Remove the Front Panel Audio PCB Assy.

3-3-16 REPLACE POWER TERMINATION ASSY

PRELIMINARY PROCEDURES: Remove Case Assy (para 3-3-1)
Remove Power Supply Assy (para 3-3-12)

STEP **PROCEDURE**

1. Remove the wire cable and two coaxial cables from the Power Termination Assy.

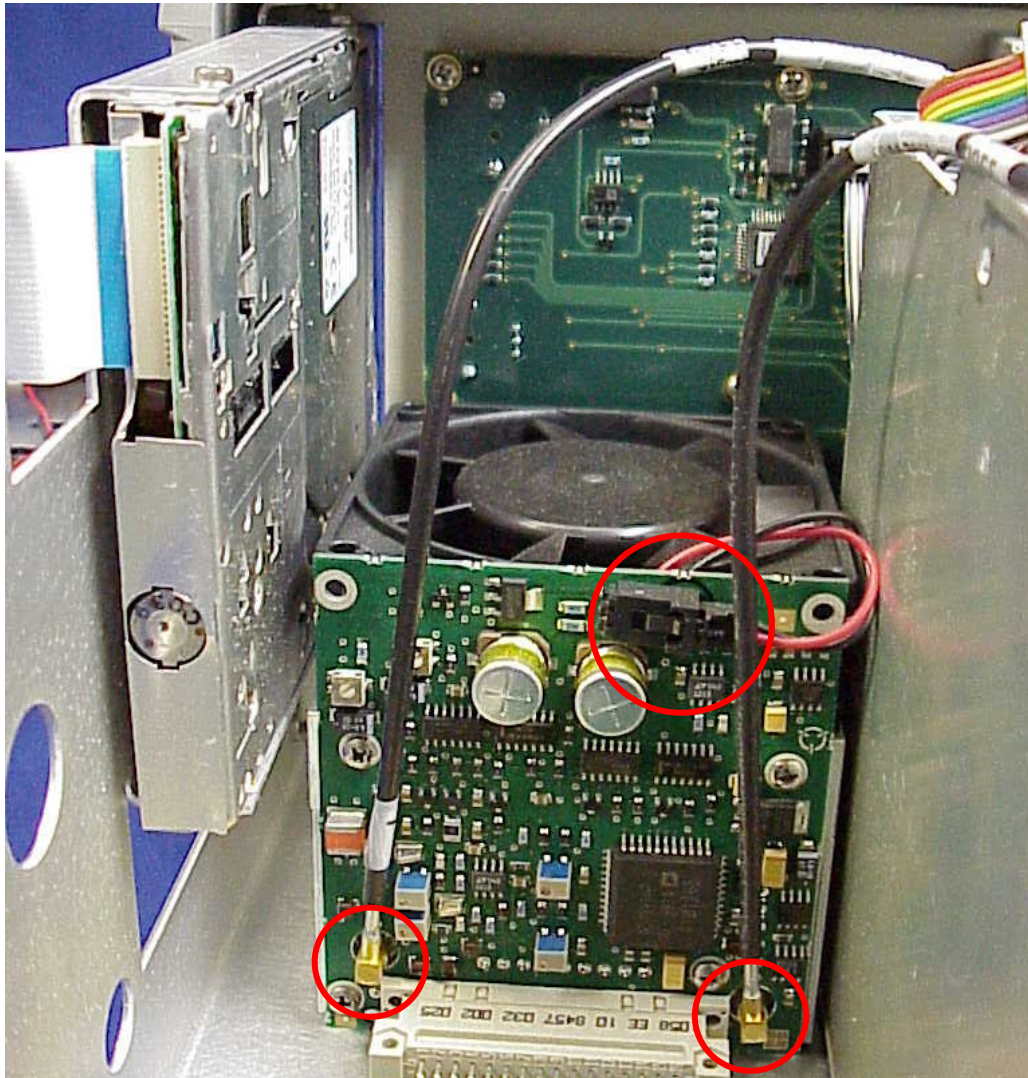

STEP

PROCEDURE

2. Remove four screws securing the Power Termination Assy to the Chassis Assy.

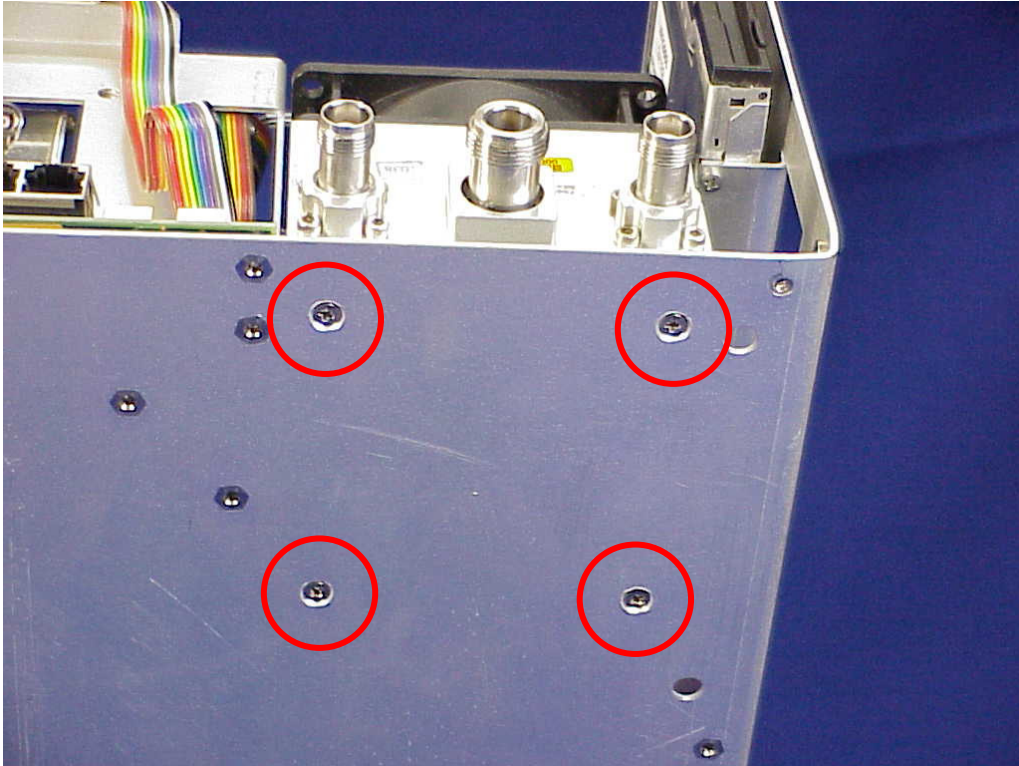

3. Remove the Power Termination Assy.

3-3-17 REPLACE FLOPPY DRIVE ASSY

PRELIMINARY PROCEDURES: Remove Case Assy (para 3-3-1)
Remove Front Panel Assy (para 3-3-14)

STEP **PROCEDURE**

1. Remove two screws securing the Floppy Drive Assy to the Chassis Assy.

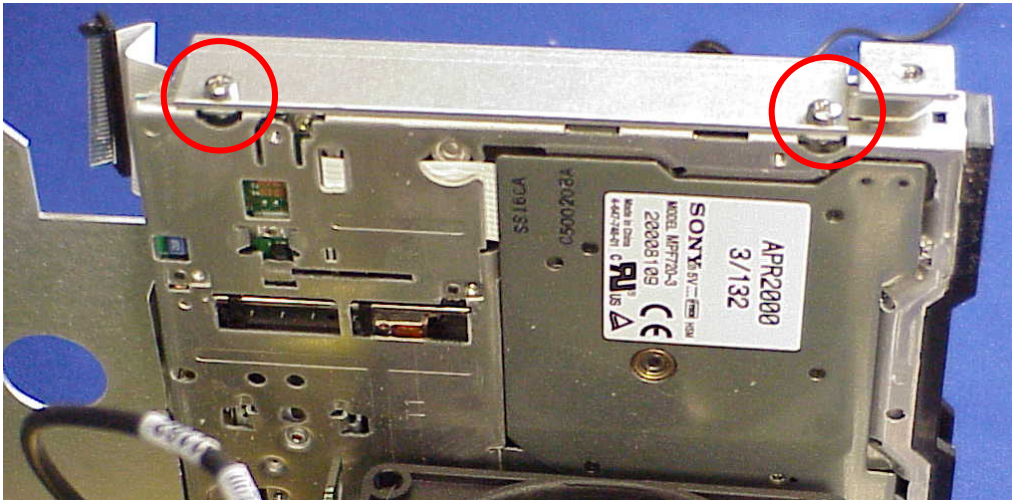

2. Remove two screws (through the access holes) securing the Floppy Drive Assy to the Chassis Assy.

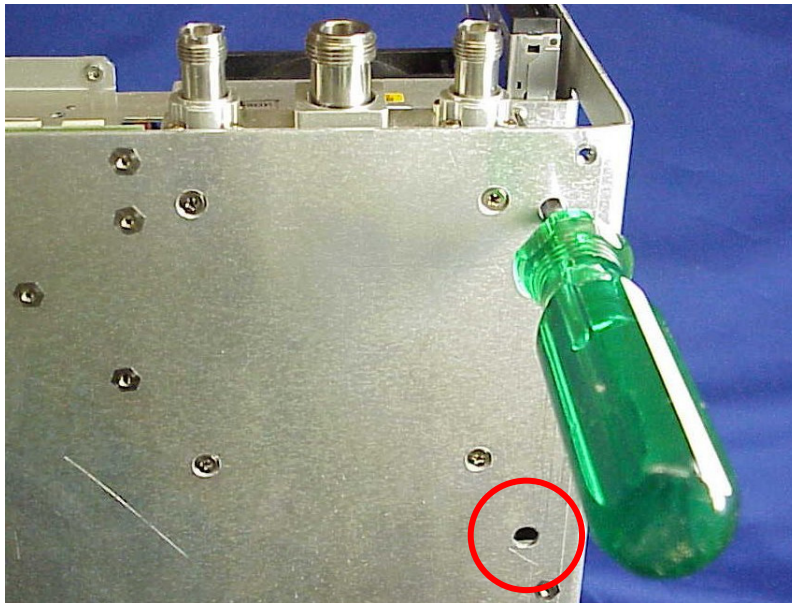

3. Remove the Floppy Drive Assy.

3-3-18 REPLACE BACKPLANE PCB ASSY

PRELIMINARY PROCEDURES:

- Remove Case Assy (para 3-3-1)
- Remove Attenuator Assy (para 3-3-3)
- Remove Generator Assy (para 3-3-4)
- Remove Receiver Assy (para 3-3-5)
- Remove IF/Video PCB Assy (para 3-3-6)
- Remove Multifunction I/O PCB Assy (para 3-3-7)
- Remove CAI PCB Assy (para 3-3-8)
- Remove CPU Adapter Assy (para 3-3-9)
- Remove Power Supply Assy (para 3-3-12)
- Remove Power Termination Assy (para 3-3-16)

STEP

PROCEDURE

1. Remove screw.

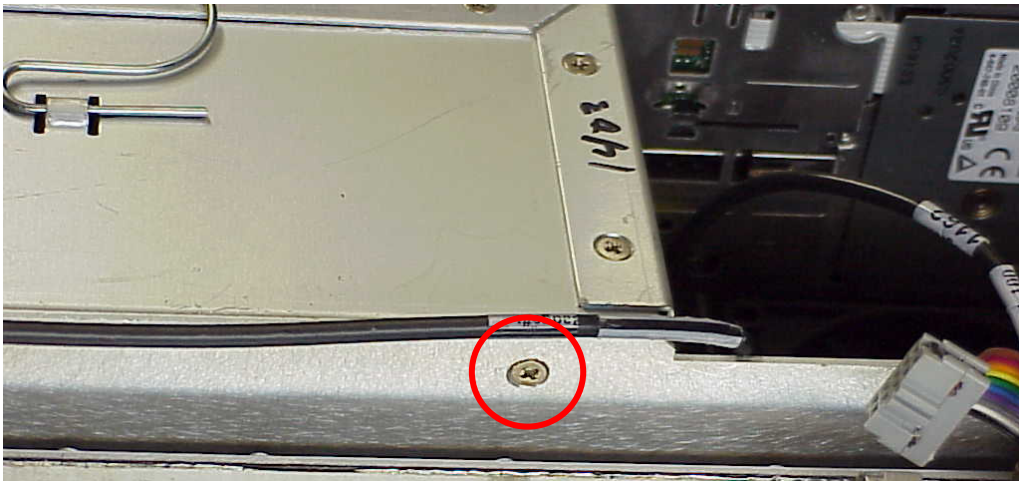

2. Remove four screws securing the Cardcage Assy to the Chassis Assy.

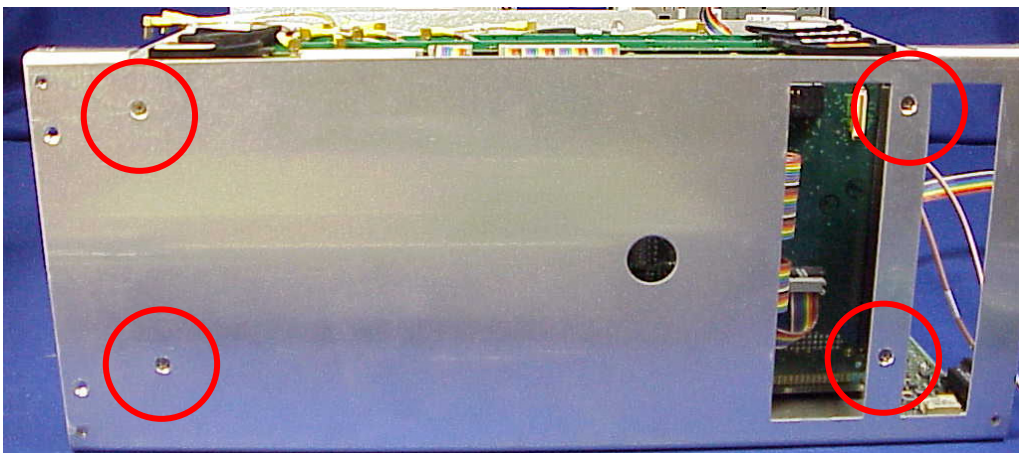

STEP

PROCEDURE

3. Remove four screws securing the Cardcage Assy to the Chassis Assy.

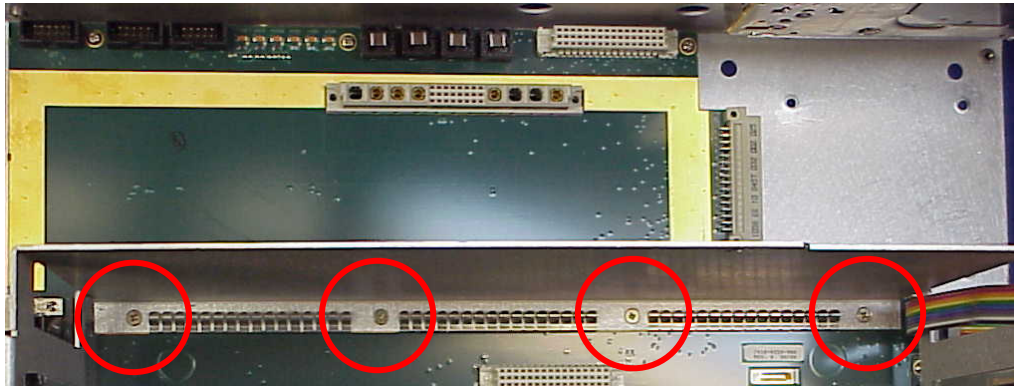

4. Remove the Cardcage Assy from the Chassis Assy.
5. Remove seven screws securing the Backplane PCB Assy to the Chassis Assy.

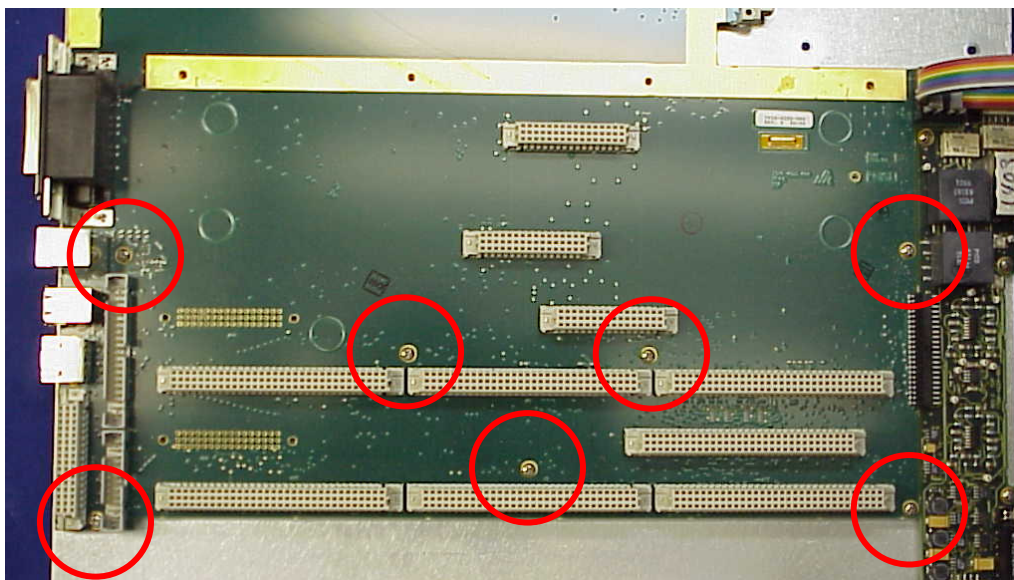

6. Remove the Backplane PCB Assy from the Chassis Assy.