

40FBT-R. 3040. A

40FBE-R. 3040. A

N i k o n F 3 T

N i k o n F 3 P

F 3 L i m i t e d

P A R T S L I S T

R E V I S E D

Supplimentary repair manual for the
Nikon F3/T (40FBT) and Nikon F3/P (40FBE)

Contents

1. FPC 2

2. SHUTTER UNIT 5

3. FRONT PLATE 6

4. BODY DIE-CASTING 9

5. TOP COVER, FILM-ADVANCE SIDE 10

6. TOP COVER, REWIND SIDE 14

7. BOTTOM PLATE 17

8. CAMERA BACK 18

Remark:

Part numbers of the F3/P are indicated by the numbers which are added 5000 or 6000 to those of the F3 and also, part numbers of the F3/T by numbers which are added 2000 or 3000 to those of the F3.

Common parts among the F3, F3/P and F3/T are indicated by the part numbers of the F3.

Common parts between the F3/P and F3/T are indicated by the part numbers of the F3/T.

1. FPC

T: Nikon F3/T (40FBT)

P: Nikon F3/P (40FBE)

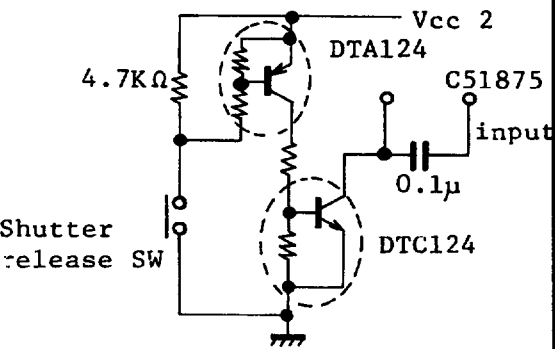
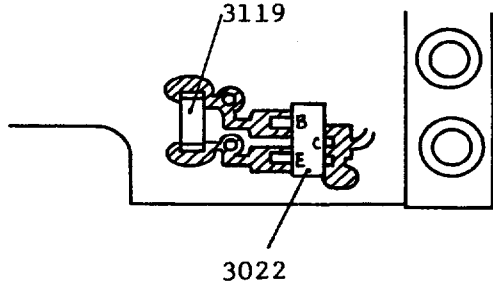
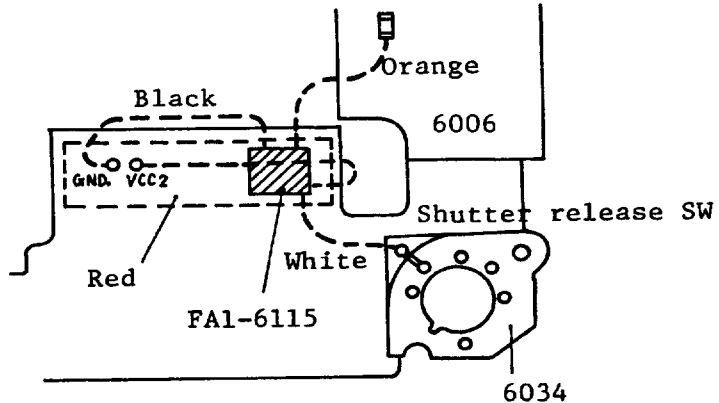
Section	Item	Solution
FA1-6115 (Release base plate)	T, P	<p>An interface circuit is added between Release switch #1006 and IC input.</p> <p>The following parts are installed on Release base plate FA1-6115.</p> <ol style="list-style-type: none"> 1) Transistors DTA 124, DTC 124. 2) Resistor (4.7KΩ) 3) Lead wires (red, black, white, orange) 
#3006	T, P	<p>Reinforcement of the power switch circuit</p> <p>Mini-mold transistor #1022 on #1066 is replaced with #3022. Resistor #3119 (22KΩ) is added between Terminals B and E of #3022.</p> 
FA4-6001	<p>T, P</p> <p>T, P</p> <p>T, P</p> <p>T, P</p> <p>P</p>	<ol style="list-style-type: none"> ① Circuit pattern for the release switch of #1006 is eliminated. ② FA1-6115 is attached to #1004. ③ Four lead wires. ④ MD connector #1034 is modified to #6034. ⑤ Use Paint ECF0011 when coating #132. 

Section	Item	Solution
FA1-3115	T, P	① Shutter release and self-timer reinforcement circuits.
FA1-6115	P	② Shutter release reinforcement circuit.
FA1-3115A	T, P	③ Reinforcement circuit of the film-advance completion switch.

Cut the pattern for the release switch of #1001-1 and attach FA1-3115 onto #1004 by adhesive tape after applying moisture-proof coating.

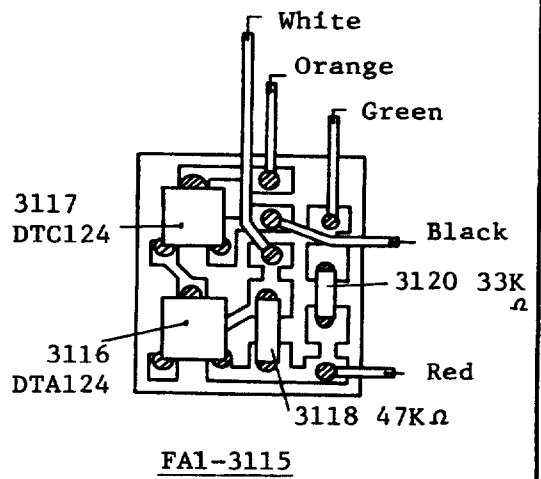
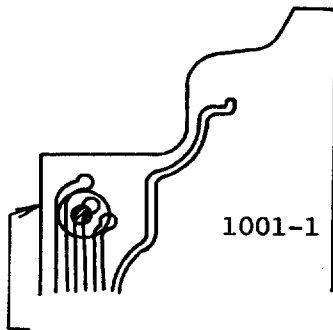
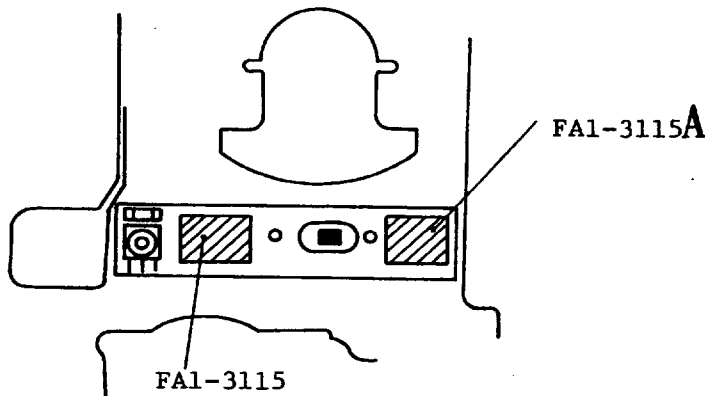

Attach FA1-3115A onto #1004.

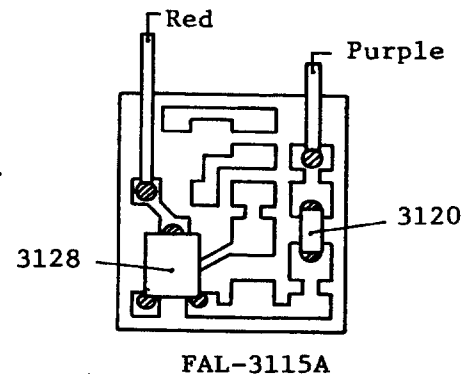

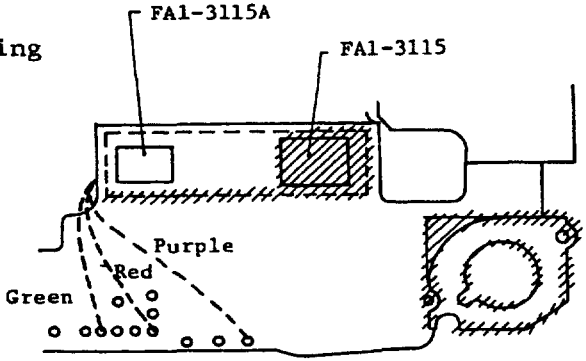
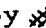
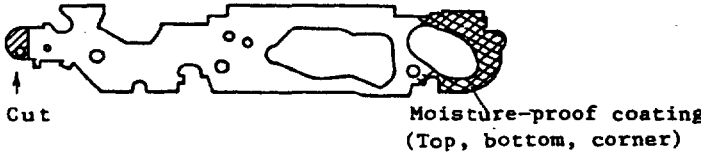
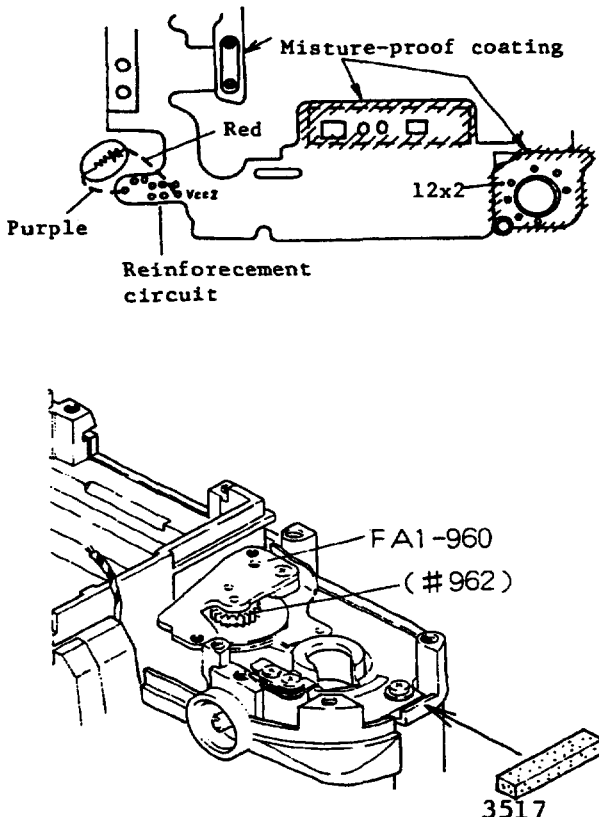
Section	Item	Solution
FA4-6001	T, P T T, P P	<ol style="list-style-type: none"> ① Moisture-proof coating is applied. ② Self-timer reinforcement circuit is added. ③ Reinforcement circuit of the film-advance completion switch is added. ④ Moisture-proof coating is applied to the following sections. <ul style="list-style-type: none"> ◦ Around #6034 ◦ Inside #1004 ◦ FA1-6115 ◦ Bottom of #1006 
#5200	T, P	<ol style="list-style-type: none"> ① The pertaining section for the film-advance completion switch is cut off. ② Apply moisture-proof coating to the section indicated by  in the figure. (Top, bottom, and corner) 
FA4-6001	P P T P P P T. P	<ol style="list-style-type: none"> ① Moisture-proof coating. <ul style="list-style-type: none"> ◦ MD connector ◦ Outside of #1004 ◦ Press-contact joint ◦ Solder joint, gray code contact ② Power switch, the first and second release switches are connected to the shutter unit directly. ③ Sponge strip #3517 is attached by adhesive tape. ④ Insulating tape #743 is attached to the gray code contact. ⑤ #12x2 ⑥ Reinforcement circuit of the film-advance completion is added. (FA1-3115A) 

Section	Item	Solution
FA4-6001	P	① Use #6560 to cover the gray code press-contact joint.
	T, P	② Apply moisture-proof coating to the press-contact joint.
	P	③ Solder the lead wire (white) to the input terminal of #1005.
	P	④ Secure the lead wire by insulating tape after routing.
	T, P	⑤ Apply Sumiflunon EAC0511 to Section (A) indicated in the figure. Then apply silicon onto the surface.

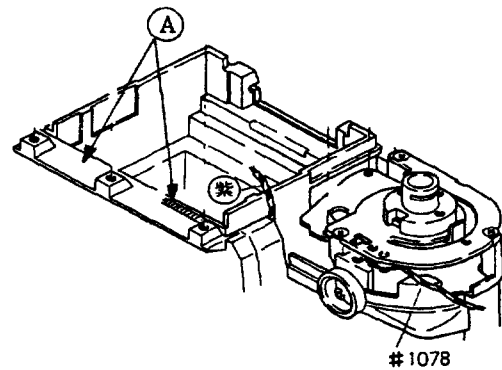
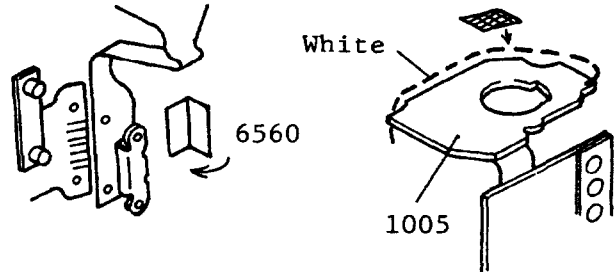

2. Shutter Unit

Section	Item	Solution
FA4-5281	P	① Lead wire soldering <ul style="list-style-type: none"> ◦ Power switch (yellow) ◦ The second release switch (orange)
	P	② Apply moisture-proof coating to the following sections. <ul style="list-style-type: none"> ◦ Top/bottom of the connector (Excepting top of the lug plate) ◦ Power switch base ◦ The first release switch base, solder joint. ◦ The second release switch base (bottom, solder joint) ◦ Closing curtain switch base (Only positive terminal side)
	T, P	◦ Solder joint of the trigger switch lead wire (Section (A))

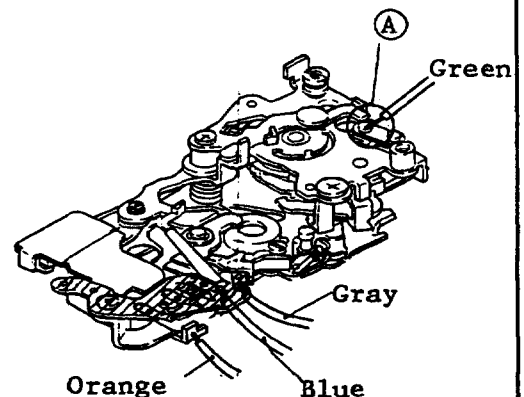

3. Front plate

Section	Item	Solution
FA3-5006	P	① Attach #6520 to #5006
	P	② Apply Sumiflunon EAC0511 to the end face of #6520.
	T, P	③ Apply Sumiflunon EAC0511 to #5714
	P	④ Use Paint ECF0011 (black) to coat the mirror cage.
	P	⑤ Attach #5188 by Adhesive SC108-33B for five minutes.

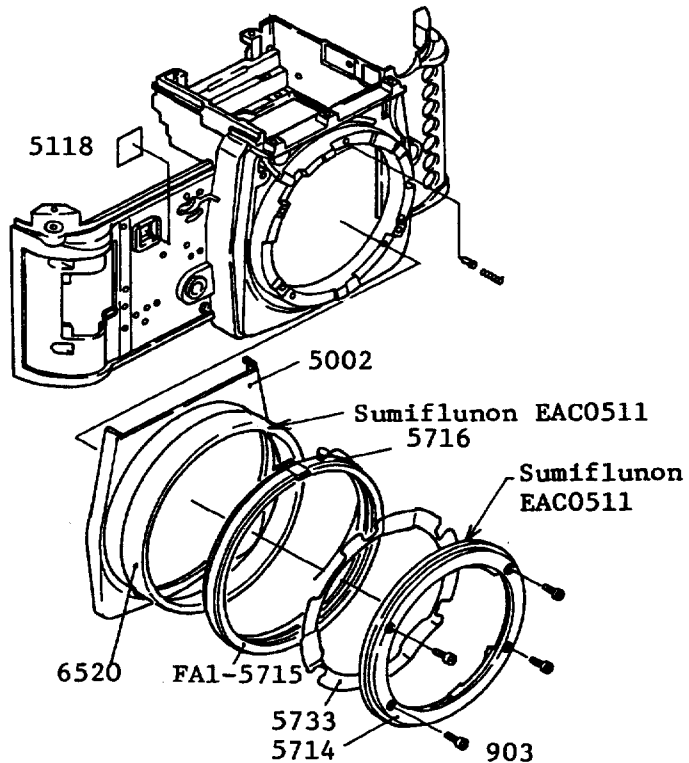

Section	Item	Solution
FA3-5006	T, P	① Attach #3507 and #3518 to #5006.
	P	② Attach #6510
	T, P	③ Apply Sumiflunon EAC0511 to bottom of the front plate.
	P	④ AF lead wire (orange) is removed.
	P	⑤ Sync contact is added. Be sure to bend the soldering section of the sync contact for preventing short-circuit.
	P	⑥ Apply silicon to the through-hole after installing the sync contact as shown in the figure.
	P	⑦ Attach tape to the solder joint after soldering the sync contact lead wire.
	P	⑧ Arrange the lead wire of sync contact by using Adhesive #501
	P	⑨ Reinforce the solder joints of the release magnet lead wires (red, black) by adhesive for five minutes.
	P	⑩ Apply moisture-proof coating to the solder joints of the memory switch and shutter switch.

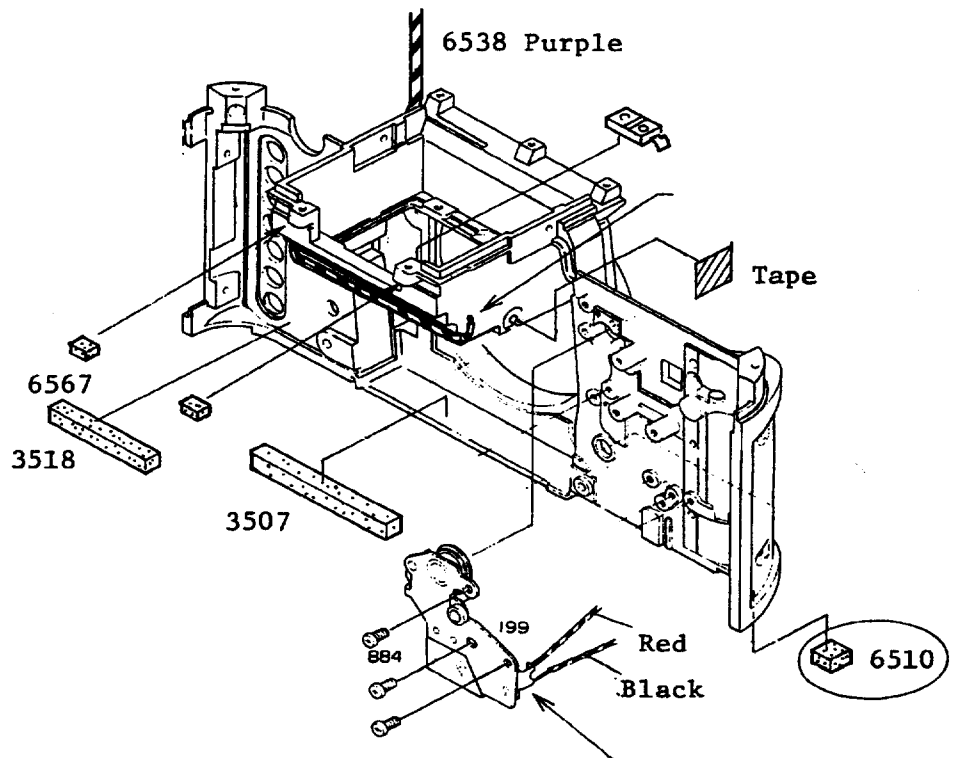

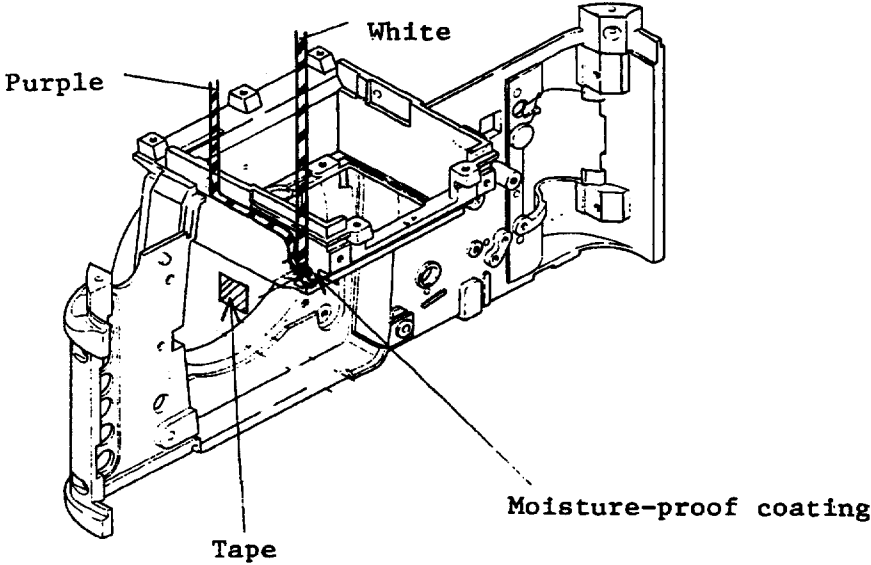
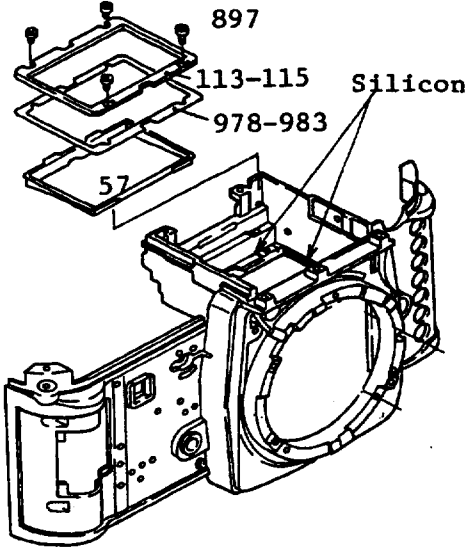
Section	Item	Solution
FA3-5006	P	<p data-bbox="488 163 1372 205">① Solder lead wire (white) to the former AF contact.</p> 
FA3-5006	P	<p data-bbox="488 972 1404 1052">① Apply silicon to the slit between #113 - #115 and #6 after adjusting viewfinder frame and infinity focus.</p> 

4. Body die-casting

Section	Item	Solution
FA1-5001	T, P	① Attach #3519 to #807 by Adhesive #616.
	T, P	② Attach #3509 to #803 by Adhesive #501.
	T, P	③ Attach #3508x2, #3511 and #2774 to the body die-casting by adhesive tapes.
	P	④ Apply moisture-proof coating to Sections A, B, C and D.
	P	⑤ Cover the bearing of film roller shaft and the through-hole of multi-exposure lever by silicon. Be careful not to exude the silicon into the holes.
	P	⑥ Use the sponge strip of 40FB for the camera back sponge strip. Apply moisture-proof coating after attaching the sponge strip.

Silicon (Top and bottom of the holes)

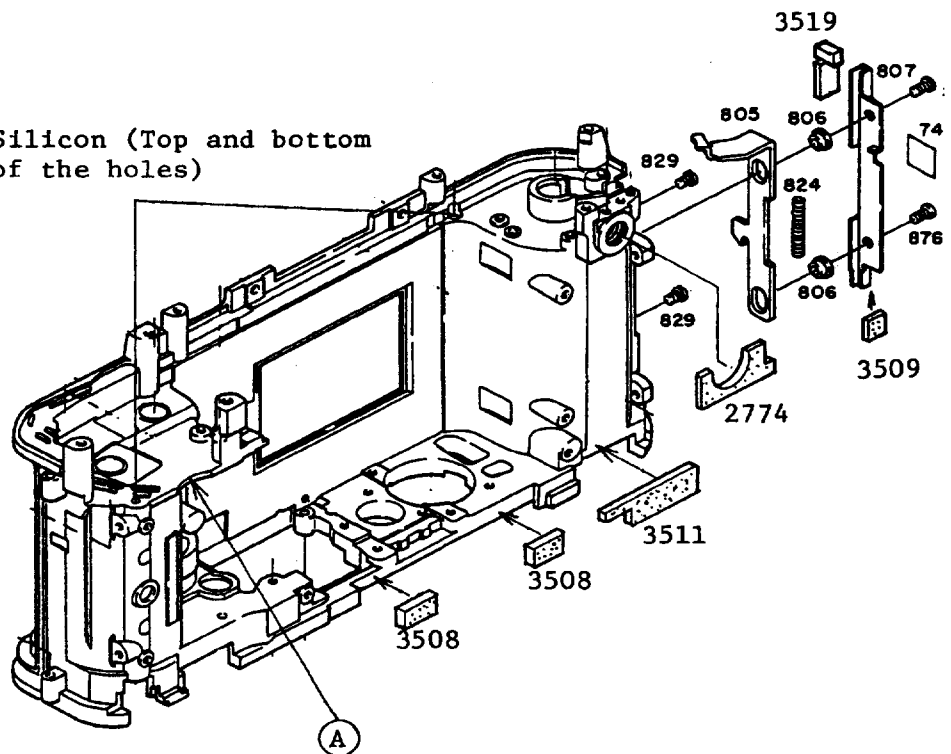

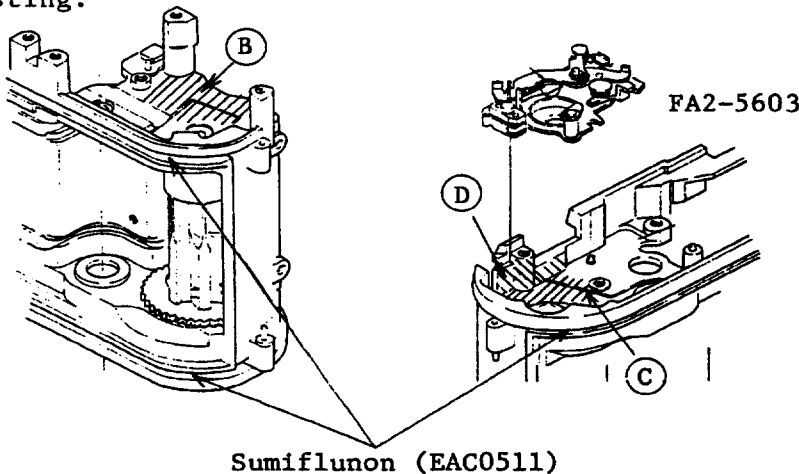
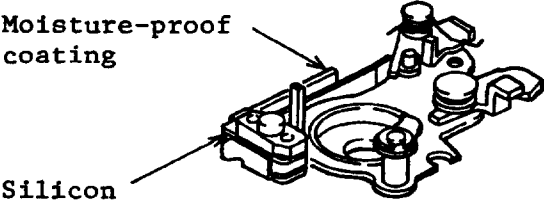
Section	Item	Solution
FA1-50011	T, P	<p>① Apply Sumiflunon (EAC0511) to bottom of the body die-casting.</p> 
FA2-5603	P	<p>① #595, #593 and #613 are removed.</p> <p>② Apply silicon and moisture-proof coating to FA2-5603 except the film-advance completion switch contact.</p> 

5. Top cover, film-advance side

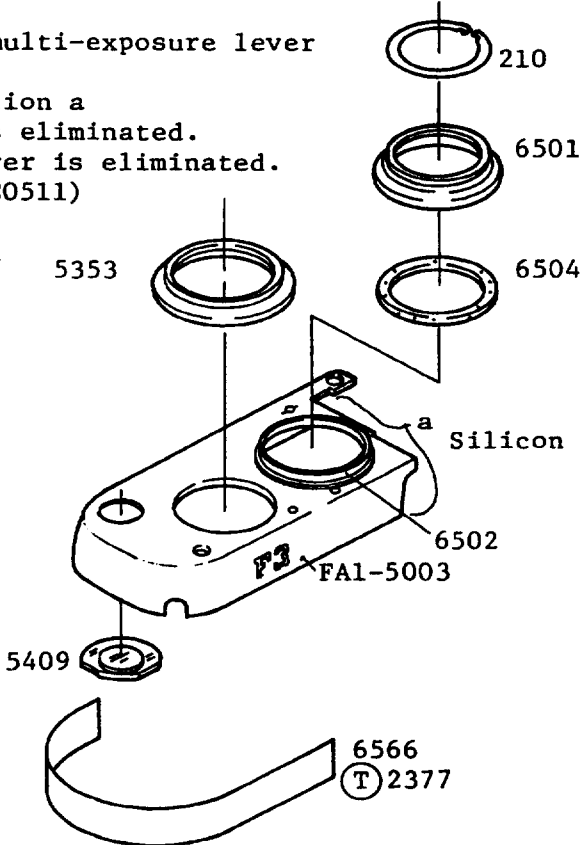
FA1-5003	<p>P</p> <p>P</p> <p>P</p> <p>P</p> <p>P</p> <p>P</p> <p>P</p> <p>P</p> <p>P</p> <p>T</p>	<p>① Secure #6502.</p> <p>② Attach #5409</p> <p>③ Through-hole of the multi-exposure lever is eliminated.</p> <p>④ Apply silicon to Section a</p> <p>⑤ Power switch lever is eliminated.</p> <p>⑥ Multiple exposure lever is eliminated.</p> <p>⑦ Apply Sumiflunon (EAC0511) to #5353.</p> <p>⑧ Attach #6504 to #6501 by adhesive tape.</p> <p>⑨ Attach #6566.</p> <p>⑩ Apply Sumiflunon (EAC0511) to rear side of the top cover after installation.</p> <p>⑪ Apply Sumiflunon (EAC0511) between #341 and #353 after tightening #353.</p> 
----------	---	--

Section	Item	Solution
Shutter button mechanical lock	P	① #346 and #348 are changed to #5346 and #5348.
	P	② #6536, #6535 and #6537 are added.
	P	③ #881 is changed to #5881.
	P	④ Attach #6555 with #6556 to #349. Apply silicon to them.

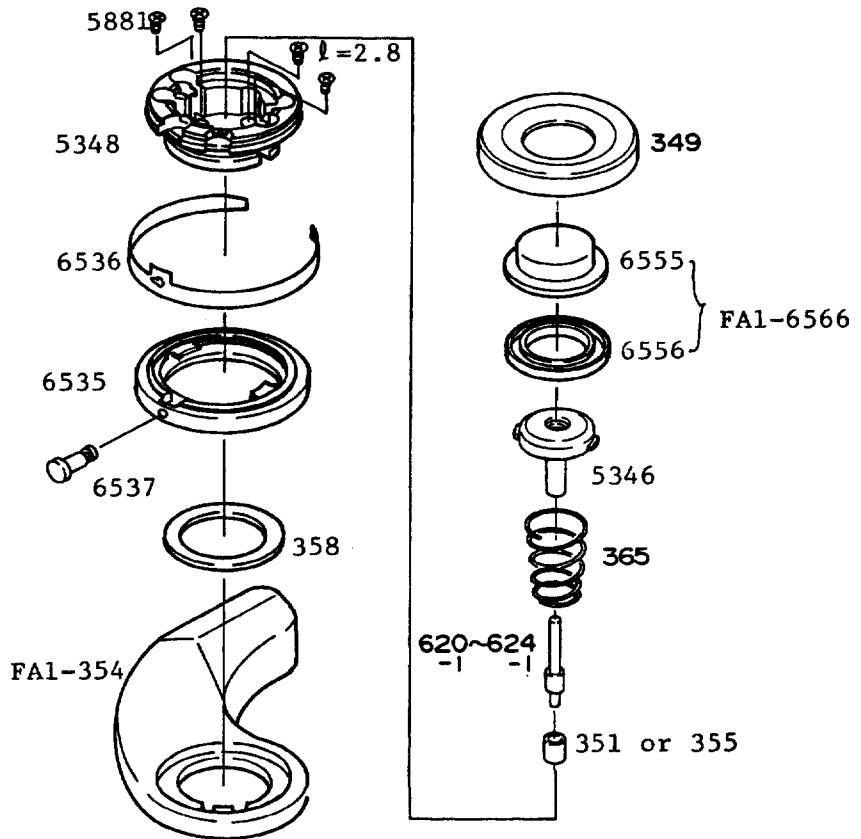

Section	Item	Solution
FA2-5201	<p>P</p> <p>P</p> <p>P</p> <p>P</p>	<p>① #5376 (Water-proof seal)</p> <p>② #6503 is added.</p> <p>③ #5212 (4.6mm), #5204 (4.8mm)</p> <p>④ Silicon application is added.</p>
FA2-5381	<p>P</p> <p>P</p>	<p>① The frame counter switch, power lock switch and four lead wires are eliminated.</p> <p>② Cover the through-holes by seals and silicon.</p>

40FBT top cover, film-advance side

1. Film-advance base plate FA2-2381

- ① Apply Sumiflunon EAC0511 to #2346, #2620 - #2624 and #2348.
- ② Apply moisture-proof coating to Sections A, B, C and D of the power switch.
- ③ Apply Sumiflunon EAC0511 to Sections E and I of the film-advance lever.

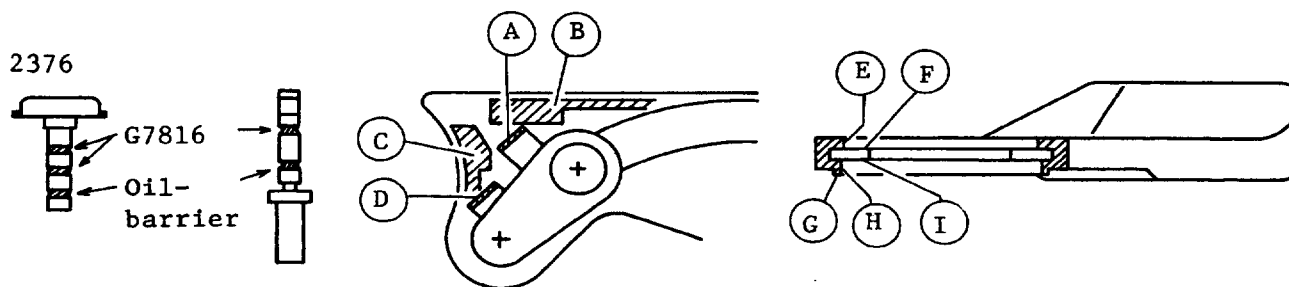

2. Multiple exposure lever

Apply Sumiflunon EAC0511 to Sections A and B



3. Shutter dial FA2-2201

- ① Apply silicon to Opening A
- ② Attach #2376 onto top face of #1008 and then apply moisture-proof coating to it.
- ③ Install #2405 between #1007 and #1008.

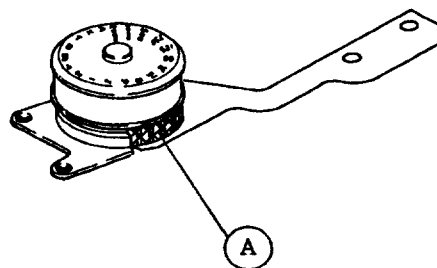

6. Top cover, rewind side

Section	Item	Solution
Rewind knob	<p>P</p> <p>T, P</p> <p>T, P</p>	<p>① Parts change #663 → #5663 #680 → #5680 #668 → #5668 #762 → #5762</p> <p>② Apply Sumiflunon EAC0511 to corners of #5657 (40FBT #657)</p> <p>③ Apply silicon to the section of FA1-665 indicated by bold lines in the figure. Avoid the application to the section of the camera back lock lever in case of 40FBT.</p> <p>④ Apply Sumiflunon EAC0511 to #926.</p>
Shoe-mount	P	<p>① Parts change FA1-681 → FA1-5681 #752 → #5752 Coupling of FRE is executed by #5752.</p> <p>② #6251 is added.</p> <p>③ Attach #6505 by adhesive tape.</p>
FA1-5004	P	<p>① Modification #4, #5683, #5686</p>

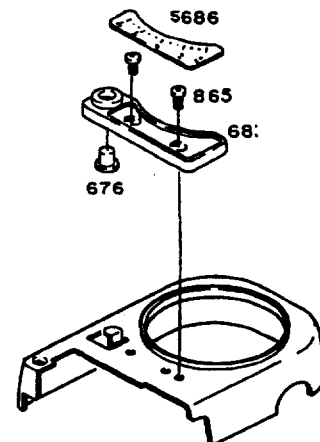
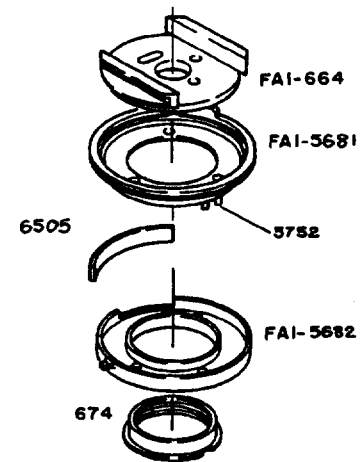
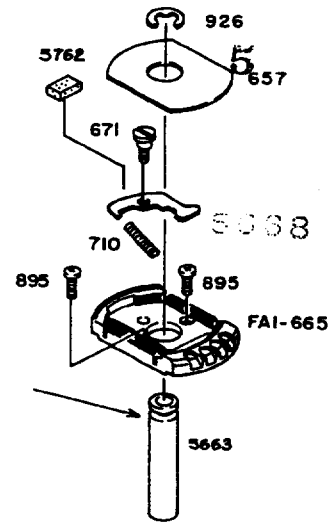

Section	Item	Solution
FA1-5004	<p>P</p> <p>T, P</p> <p>P</p>	<ol style="list-style-type: none"> ① Apply silicon to section a in the figure. ② Screws #888x1 #5912x2 ③ Attach #6506 to FA1-5004 by adhesive tape and then, apply Sumiflunon EAC0511 to it. ④ Attach #2378 to FA1-5004. ⑤ Apply Sumiflunon EAC0511 to rear side of FA1-5004 after installing. <div data-bbox="759 744 1478 1244" data-label="Image"> </div>
FA2-5661	<p>P</p> <p>P</p> <p>P</p> <p>P</p>	<ol style="list-style-type: none"> ① Modification #5684, #5661 ② Apply Sumiflunon EAC0511 to the sections indicated by oblique lines. ③ Apply silicon to slits of #660 = #5661. ④ Cover the screw-hole by silicon <div data-bbox="949 1638 1412 1893" data-label="Image"> </div>

40FBT Top cover, rewind side

- ① Apply Sumiflunon EAC0511 to Sections A and B indicated by oblique lines in the figure.
- ② Apply silicon to Section C indicated by a bold line.
- ③ Attach #2378 and #2774 to the camera body.
- ④ Apply Sumiflunon EAC0511 to Sections D and E.
- ⑤ Apply Sumiflunon EAC0511 to Sections F, G and H.
- ⑥ Apply silicon to Section I indicated by bold lines.

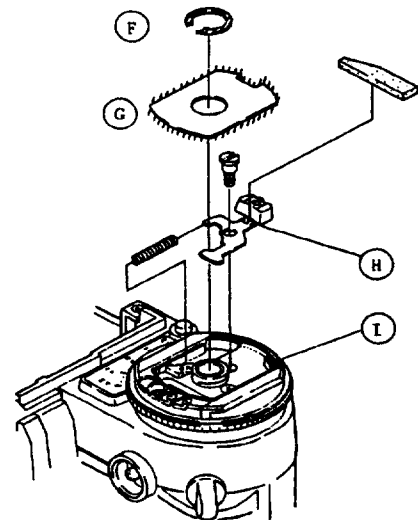
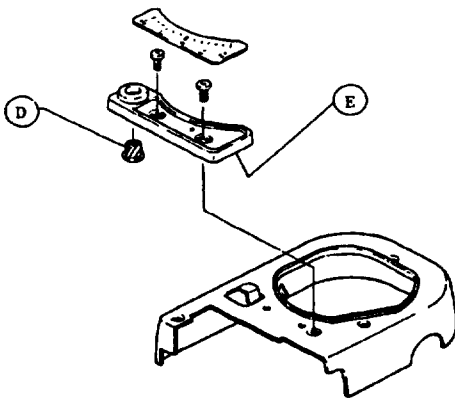
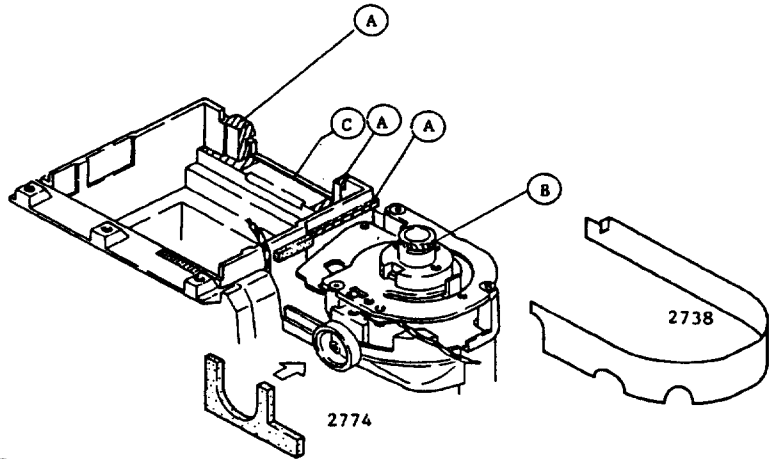

40FBT Bottom cover

- ① Apply Sumiflunon EAC0511 to Section A indicated by oblique lines.
- ② Apply silicon to Section B indicated by oblique lines.
- ③ Apply Sumiflunon EAC0511 to Section C indicated by oblique lines.

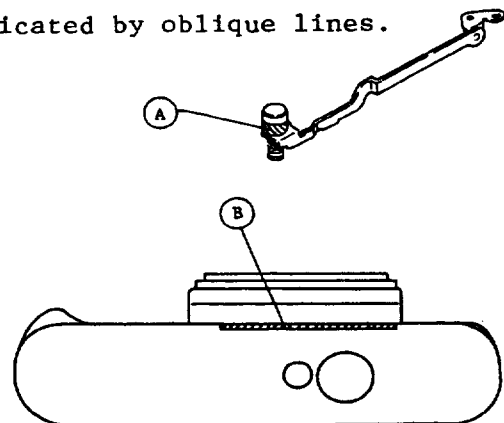

7. Bottom cover

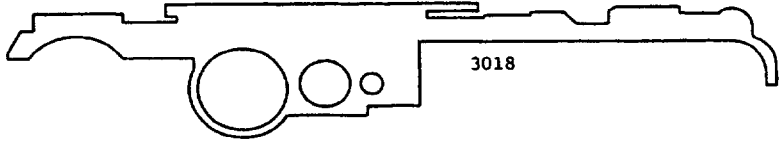
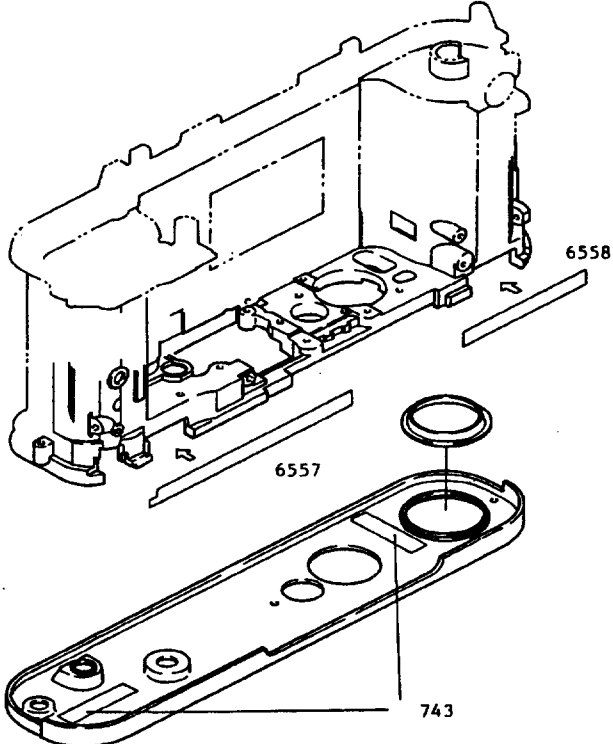
Section	Item	Solution
#3018	T, P	① Modification
	T, P	② Apply Sumiflunon EAC0511 to all of surface of #3018.
		
Bottom cover	T, P	① Apply Sumiflunon EAC0511 to inner surface of the bottom cover
	P	② Attach #743 to #5007.
	P	③ Attach #6557 and #6558 to the body die-casting.
	P	④ Attach #6559 to the MD connector.
		

8. 40FBE Cmera back (FA2-8001)

- ① Camera back MF-6 is used.
- ② Film roller is added for preventing double exposures.
- ③ Apply Sumiflunon EAC0511 to the sections of #2 indicated by oblique lines.
- ④ Install Pressure plate FA1-2820.

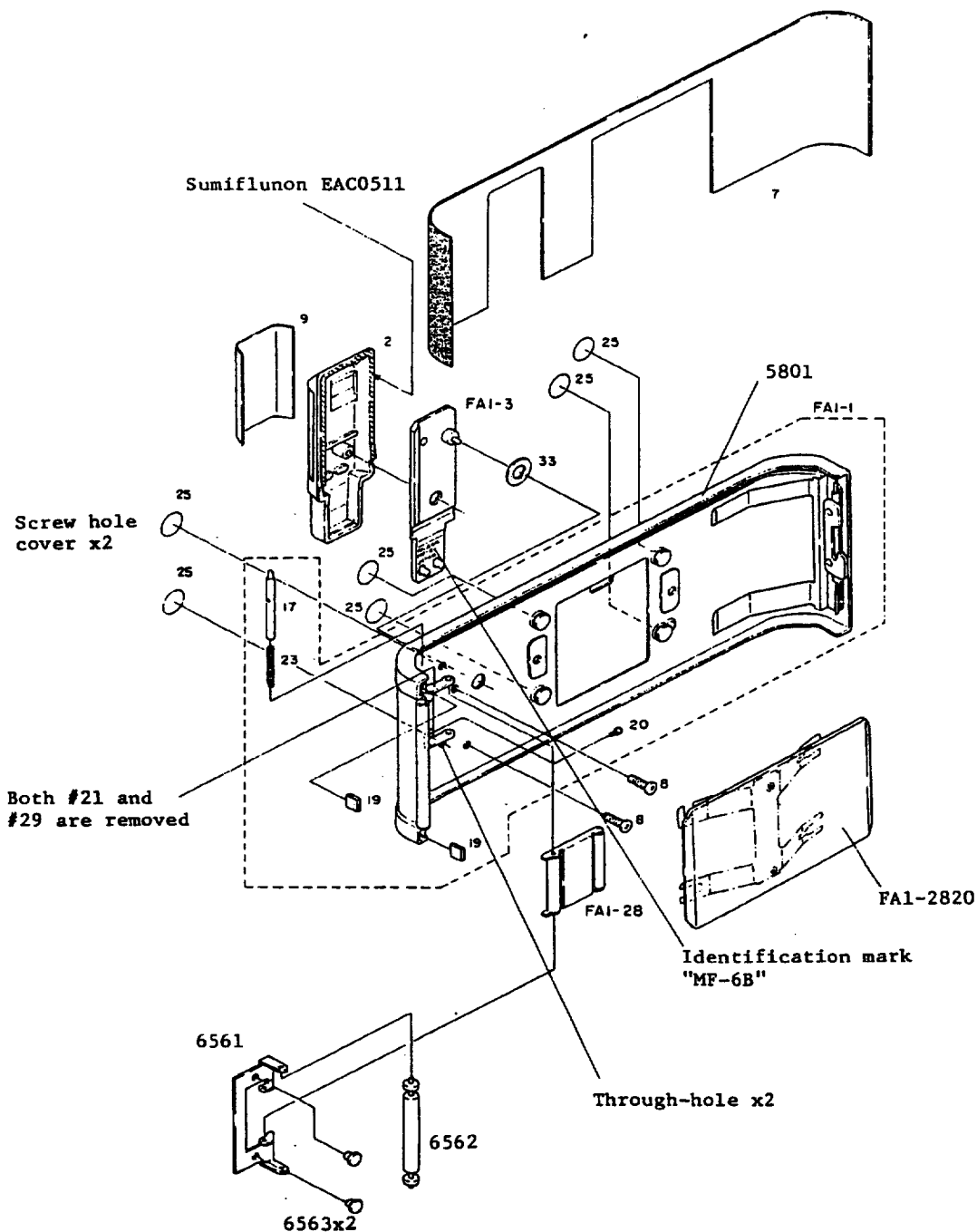

40FBT-R. 3040. A

N i k o n F 3 T

P A R T S L I S T

R E V I S E D

部品表編

総展開図	0
部品表	P 1
部組品表	P 4
F 3ブラック部品表	P 5

PARTS LIST

Drawing of Complete Camera Section	0
PARTS LIST	P 1
ASSEMBLY LIST	P 4
F3 Black Parts List	P 5

展開図の見方

How to use Exploded Drawings

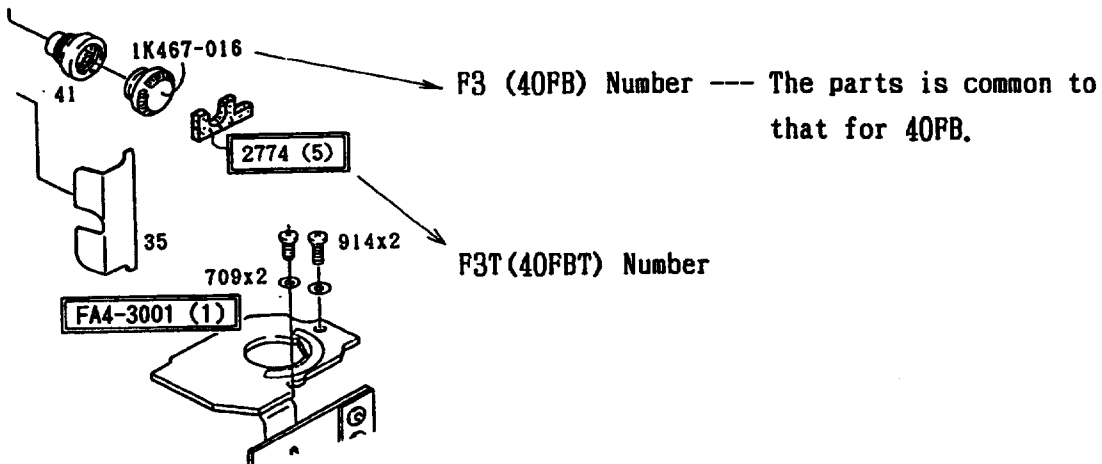

1

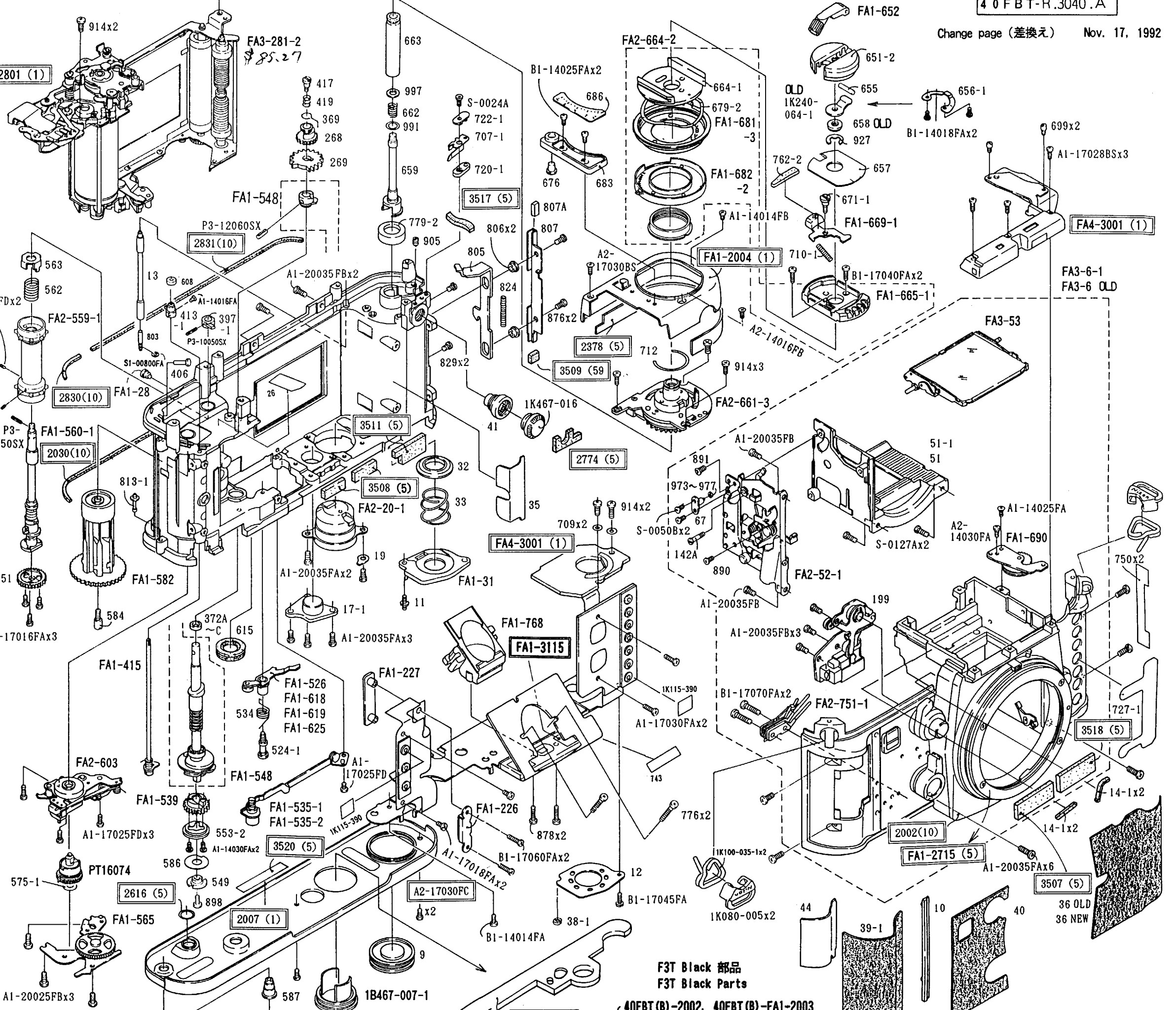
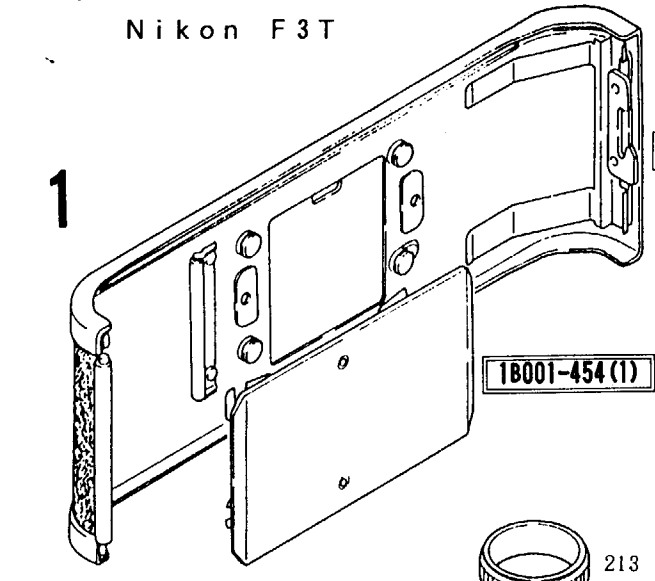

2

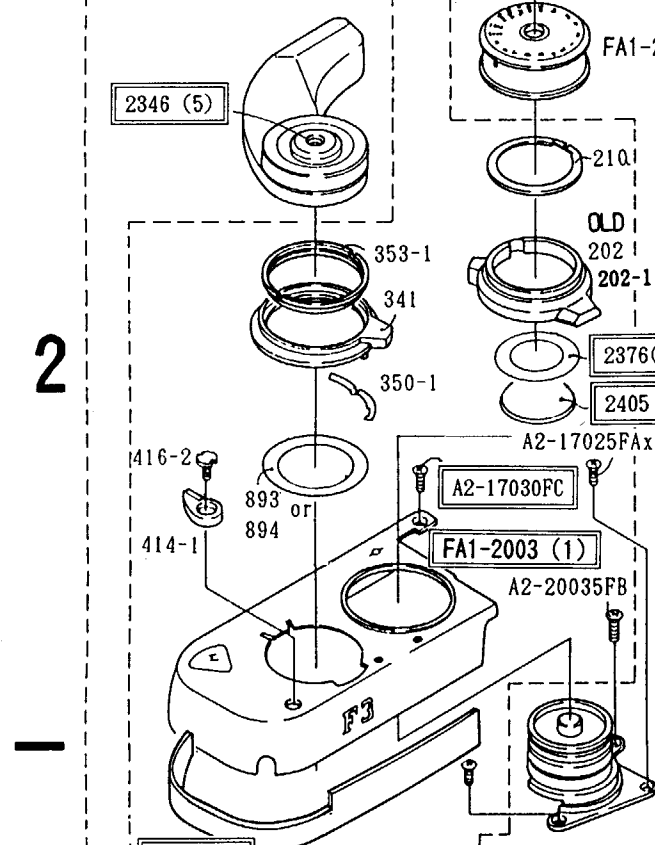

3

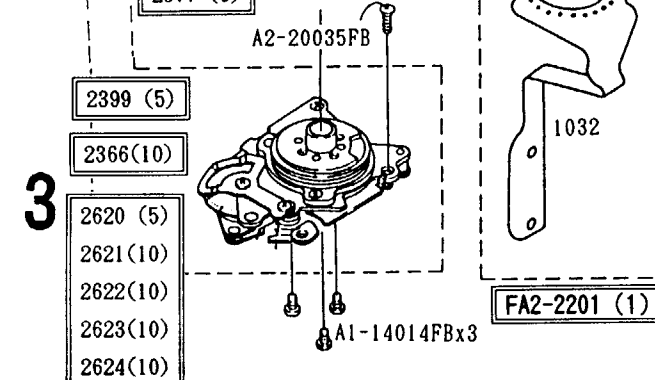

--- 40FBTのオーダーで要求方

Please write 40FBT-xxxx

as the product code number.

F3T Black 部品
F3T Black Parts

40FBT (B)-2002, 40FBT (B)-FA1-2003
40FBT (B)-2007, 40FBT (B)-FA1-2004

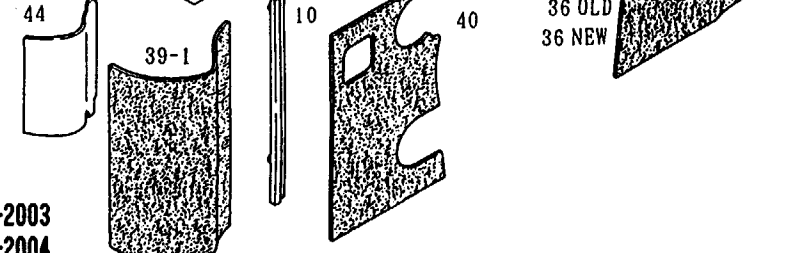

展開図中の部品位置を確認する手順

HOW TO FIND THE PART WITH PART NUMBER IN THE DRAWING

部品表 Parts List

部品番号 Part No.	補助番号 Ckt No.	名称 Name	1台分 個数 Q'ty Per Unit	部組品番号 Assembly	参照 図番 Fig. No.	販売区分 Class. of Salabil- ity	備考 Remarks	要求単位 Order Unit Q'ty
*1K240-516	573	シュー座板バネ Accessory shoe spring	1	18990-712-2	9 A1	○△	F-401S F-601	5
*1K240-713-1	527	ロックバネB Lock spring B	1	18990-712-2	10 A2	○△		5

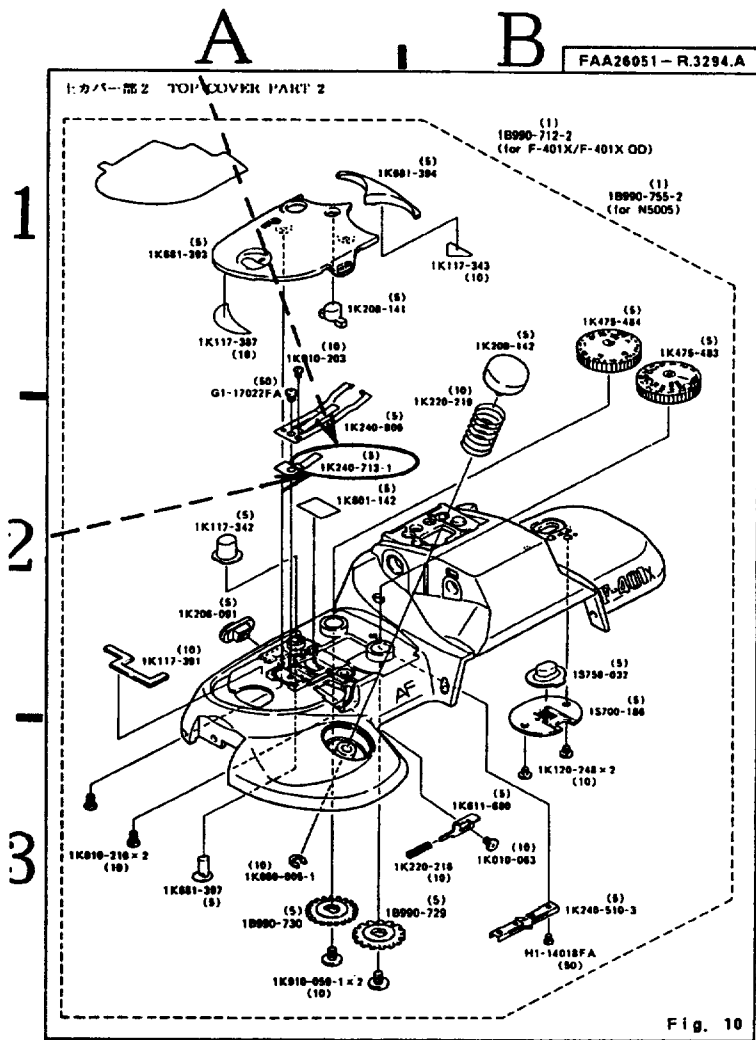

① 部品表の参照図番欄のコードを見る。

Please refer to the letters written in the Fig. No. Column.

② 9, 10等の数字は図面番号を示す。

The numbers 9 and 10 mean the Fig. number.

③ A1, A2等のアルファベットと数字の組み合わせは、図面中の部品の位置を示す。

例 A, B... は横方向の位置を示す。
1, 2... は縦方向の位置を示す。

* よって **1K240-713-1** はAと2が示す範囲内にある。

The combinations of alphabets and numbers, A1 and A2, point out the place of relevant parts in the drawing.

Example)

Alphabets like A and B point out the places along the horizontal direction.

Numbers like 1 and 2 point out the places along the vertical direction.

*It means that the part No. **1K240-713-1** is existing in the area where A and 2 are crossing.

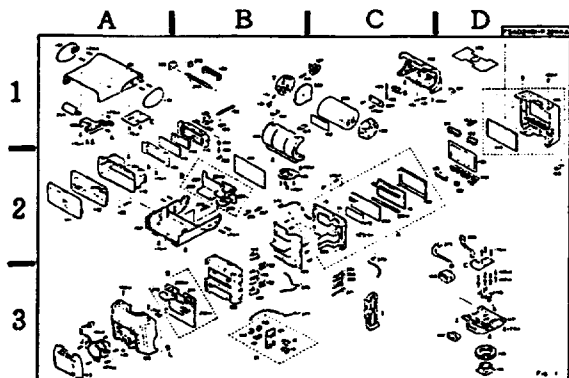

④ 例外 — ビス, ワッシャー等は Fig No. のみ記載する。

As for screws and washers and the like, no code number showing existing place is described in the Fig. No. Column, but only the relevant drawing number (Fig. No.) is stated.

部品表 Parts List

Nikon F3T

40FBT-R. 3040.A

部品番号 Part No.	補助番号 Ckt No.	名称 Name	1台分 個数 Pcs. Per Unit	部組品番号 Assembly	参照 図番 Fig. No.	販売区分 Term of Delivery	備考 Remarks	要求単位 Q'ty per order
2002 (40FBT-2002)		エプロン Apron	1		D3	○		5
2007 (40FBT-2007)		底カバー Bottom cover	1		B3	○		1
2018-1 (40FBT-2018-1)		底部防水ゴム Rubber, bottom cover	1		C3	○		5
2030 (40FBT-2030)		裏蓋溝用スポンジA Sponge A, camera back	1		B2	○		10
2346 (40FBT-2346)		リリースボタン軸 Release button shaft	1	FA2-2381	A2	○△		5
2366 (40FBT-2366)		巻上げレバー戻しバネ Spring, film-advance lever	1	FA2-2381	A3	○△		10
2376 (40FBT-2376)		防湿シールA Seal A	1	FA2-2201	A2	○△		10
2377 (40FBT-2377)		防湿シールB Seal B	1		A3	○		5
2378 (40FBT-2378)		防湿シールC Seal C	1		C1-2	○		5
2399 (40FBT-2399)		枚数計目盛板 Scale, frame counter	1	FA2-2381	A3	○△		5
2405 (40FBT-2405)		シリコン用リング Ring	1	FA2-2201	A2	○△		5
2616 (40FBT-2616)		R 釦部モルトブレン Moltplane, R button	1		B2	○		5
2620 (40FBT-2620)		リリース軸 A Release shaft A L= 15.3	1	FA2-2381	A3	○△		5
2621 (40FBT-2621)		リリース軸 C Release shaft C L= 15.1						10
2622 (40FBT-2622)		リリース軸 D Release shaft D L= 15.2						10
2623 (40FBT-2623)		リリース軸 E Release shaft E L= 15.4						10
2624 (40FBT-2624)		リリース軸 B Release shaft B L= 15.5						10

部品表 Parts List

40FBT-R. 3040. A

部品番号 Part No.	補助番号 Ckt No.	名称 Name	1台分 個数 Pcs. Per Unit	部組品番号 Assembly	参照 図番 Fig. No.	販売区分 Term of Delivery	備考 Remarks	要求単位 Q'ty per order
2774 (40FBT-2774)		シンクロ下スポンジ Sponge	1		C2	○	USE TO 40FBE-FA3-5006	5
2830 (40FBT-2830)		裏蓋溝用スポンジC Sponge C	1		B2	○		10
2831 (40FBT-2831)		裏蓋上溝用スポンジ Moltplane	1		B1	○		10
3507 (40FBT-3507)		受光素子下スポンジ Sponge	1		D3	○		5
3508 (40FBT-3508)		受光素子スポンジ Sponge	1		B2	○		5
3509 (40FBT-3509)		裏蓋ロックスポンジ Sponge	1		C2	○		5
3511 (40FBT-3511)		前側フレキ下スポンジ Sponge	1		B-C2	○		5
3517 (40FBT-3517)		シンクロ横スポンジ Sponge	1		C1	○		5
3518 (40FBT-3518)		前側スポンジ Sponge	1		D3	○		5
3520 (40FBT-3520)		底板セグメントシール Segment seal	1		B3	○		5

部品表 Parts List

40FBT-R. 3040. A

部品番号 Part No.	補助番号 Ckt No.	名称 Name	1台分 個数 Pcs. Per Unit	部組品番号 Assembly	参照 図番 Fig. No.	販売区分 Term of Delivery	備考 Remarks	要求単位 Q'ty per order
A2-17030BC	2888	上蓋、底板、ネジ Screw	3		A2 C3	○		10 or 50
	3121	リード線 赤 Lead wire (red)	1			×	W-0056RE	
	3122	リード線 黒 Lead wire (black)	1			×	W-0056BK	
	3123	リード線 白 Lead wire (white)	1			×	W-0056WH	
	3124	リード線 橙 Lead wire (orange)	1			×	W-0056OR	
	3125	リード線 緑 Lead wire (green)	1			×	W-0056GN	
	3126	リード線 紫 Lead wire (purple)	1			×	W-0056PU	
	3127	リード線 赤 Lead wire (red)	1			×	W-0056RE	
18001-454	FA1-2820	圧板 Pressure plate	1		A1			1
RP-40FB-590 1 (RP-40FB-590-1)		遮光用リング Lightbafflerring	1					1
RP-40FB-590 FA1-5715 (RP-40FB-590-FA1-5715)		絞り連動環 Apertuer coupling ring	1					1

部組品表 Assembly List

40FBT-R. 3040. A

部組番号 Part No.	補助番号 Ckt No.	名称 Name	1台分 個数 Qty Per Unit	大部組品番号 Constituent parts	参照 図番 Fig. No.	備考 Remarks	要求単位 Order Unit Qty
FA1-2003 (40FBT-FA1-2003)		右上カバー (巻上げ側) Top cover, wind side	1		A2		1
FA1-2004 (40FBT-FA1-2004)		左上カバー (巻き戻し側) Top cover, rewind side	1		C1		1
FA1-2715 (40FBT-FA1-2715)		絞り運動環 Aperture coupling ring	1		D3		5
FA1-2801 (40FBT-FA1-2801)		裏蓋 Camera back	1		A1		1
FA1-3115 (40FBT-FA1-3115)		レリーズ補助基板 Circuit, release sw	1		C2		5
FA2-2201 (40FBT-FA2-2201)		シャッターダイヤル基板 Unit, shutter-speed selector	1		A3		1
FA2-2381 (40FBT-FA2-2381)		巻上げ基板 Unit, take-up gear	1		A1		1
FA4-3001 (40FBT-FA4-3001)		F P C	1		C2		1

この部品表は、40FBT (F3T) 専用部品のみ記載。
他の部品については、40FB (F3) 要求方。

This parts list shows the exclusive parts for 40FBT (F3T) only.
As for the common parts, please refer to the parts list for 40FB (F3).

部品表 Parts List

Nikon F3T Black

40FBT(B)-R. 3040. A

部品番号 Part No.	補助番号 Ckt No.	名称 Name	1台分 個数 Pcs. Per Unit	部組品番号 Assembly	参照 図番 Fig. No.	販売区分 Term of Delivery	備考 Remarks	要求単位 Q'ty per order
2002 (40FBT(B)-2002)		エプロン Apron	1			○		5
2007 (40FBT(B)-2007)		底カバー Bottom cover	1			○		1

部組品表 Assembly List

40FBT(B)-R. 3040. A

部組番号 Part No.	補助番号 Ckt No.	名称 Name	1台分 個数 Q'ty Per Unit	大部組品番号 Constituent parts	参照 図番 Fig. No.	備考 Remarks	要求単位 Order Unit Q'ty
△ FAI-2003 (40FBT-FAI-2003)		右上カバー (巻上げ側) Top cover, wind side	1			RP-9548	1
△ FAI-2003 (40FBT(B)-FAI-2003)							
△ FAI-2004 (40FBT-FAI-2004)		左上カバー (巻き戻し側) Top cover, rewind side	1			RP-9548	1
△ FAI-2004 (40FBT(B)-FAI-2004)							
△ FAI-2715 (40FBT-FAI-2715)		絞り連動環 Aperture coupling ring	1			RP-9548	5
△ FAI-2715 (40FBT(B)-FAI-2715)							
△ FAI-2801 (40FBT-FAI-2801)		裏蓋 Camera back	1			RP-9548	1
△ FAI-2801 (40FBT(B)-FAI-2801)							

この部品表は、40FBT(B)/(F3T Black) 専用部品のみ記載。
他の部品については、40FB(F3)・40FBT(F3T)にて要求方。

This parts list shows the exclusive parts for 40FBT(B)/(F3T Black) only.
As for the common parts, please refer to the parts lists for 40FB(F3) / 40FBT(F3T).

RP-Inf. NO. 9548



40FBE-R. 3040. A

N i k o n F 3 P

P A R T S L I S T

R E V I S E D

部品表編

総展開図 0

部品表 P 1

部組品表 P 4

PARTS LIST

Drawing of Complete Camera Section 0

PARTS LIST P 1

ASSEMBLY LIST P 4

展開図の見方

How to use Exploded Drawings

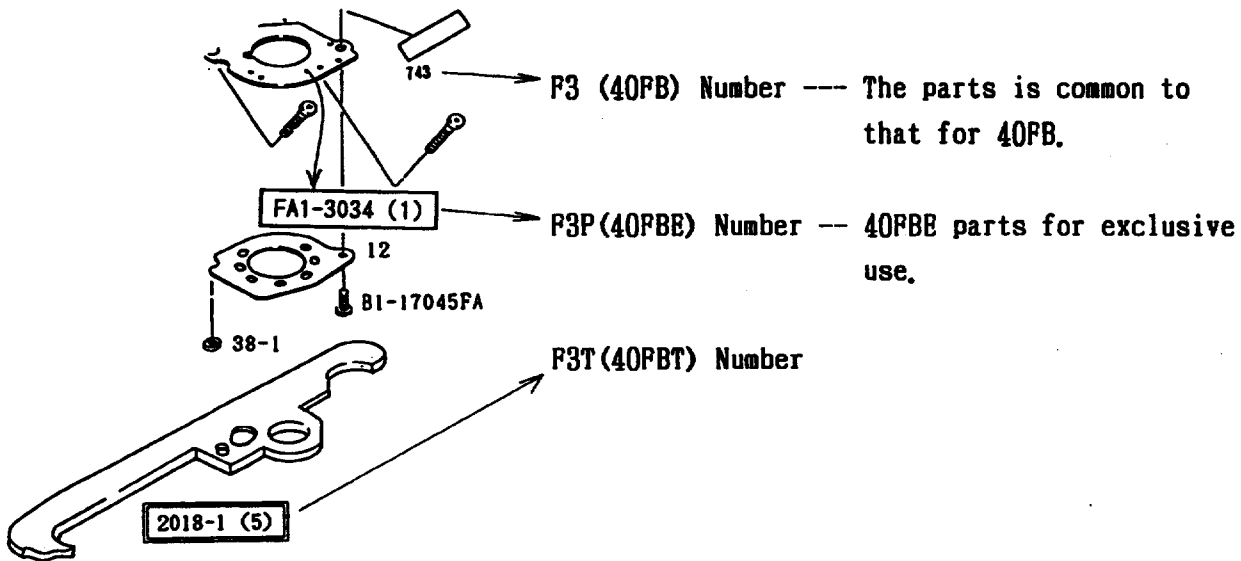

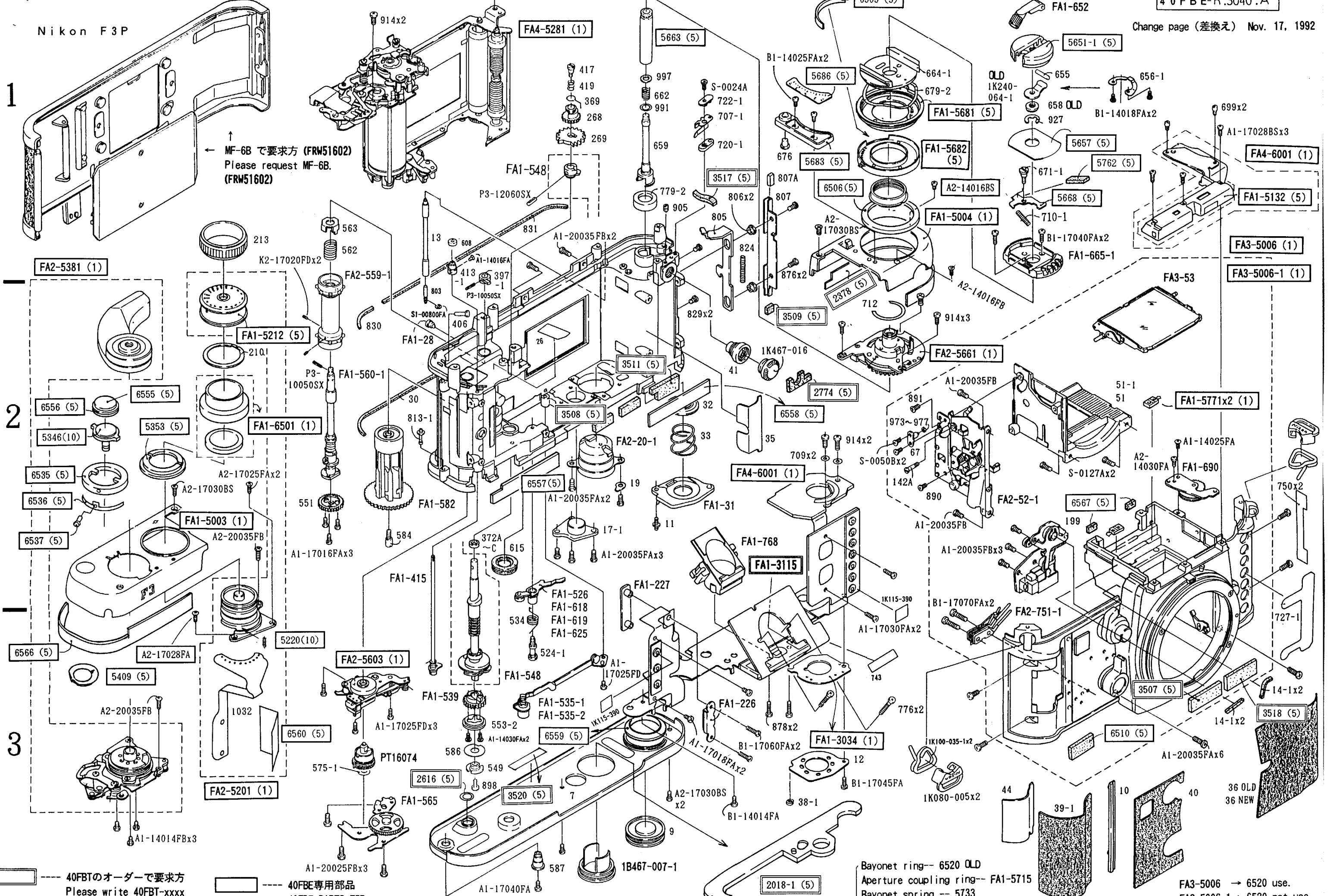

MF-6B で要求方 (FRW5160Z)
Please request MF-6B.
(FRW5160Z)

FA2-5381 (1)

2

3

40FBTのオーダーで要求方
Please write 40FBT-xxxx

40FBE専用部品
40FBE PARTS FOR

Bayonet ring-- 6520 OLD
Aperture coupling ring-- FA1-5715
Bayonet spring -- 5733

FA3-5006 → 6520 use.
FA3-5006-1 → 6520 not use.

FA4-6001 (1)

FA1-5132 (5)

FA3-5006 (1)

FA3-5006-1 (1)

FA1-5771x2 (1)

FA4-6001 (1)

FA1-3115

FA1-3034 (1)

2018-1 (5)

FA4-5281 (1)

FA1-548

FA1-28

FA1-582

FA1-548

FA1-565

FA1-5681 (5)

FA1-5682 (5)

FA1-5004 (1)

FA2-5661 (1)

FA2-52-1

FA2-751-1

FA2-5603 (1)

FA2-5201 (1)

FA3-53

FA1-690

FA1-535-1
FA1-535-2

FA1-539

FA1-526
FA1-618
FA1-619
FA1-625

FA1-5212 (5)

FA1-5212 (5)

FA1-5212 (5)

FA1-5212 (5)

FA1-5212 (5)

FA1-5212 (5)

FA1-5212 (5)

FA1-5212 (5)

FA1-5212 (5)

FA1-5212 (5)

FA1-5212 (5)

FA1-5212 (5)

FA1-5212 (5)

FA1-5212 (5)

FA1-5212 (5)

FA1-5212 (5)

FA1-5212 (5)

FA1-5212 (5)

FA1-5212 (5)

FA1-5212 (5)

FA1-5212 (5)

FA1-5212 (5)

FA1-5212 (5)

FA1-5212 (5)

FA1-5212 (5)

FA1-5212 (5)

FA1-5212 (5)

FA1-5212 (5)

FA1-5212 (5)

FA1-5212 (5)

FA1-5212 (5)

FA1-5212 (5)

FA1-5212 (5)

FA1-5212 (5)

FA1-5212 (5)

FA1-5212 (5)

FA1-5212 (5)

FA1-5212 (5)

FA1-5212 (5)

FA1-5212 (5)

FA1-5212 (5)

FA1-5212 (5)

FA1-5212 (5)

FA1-5212 (5)

FA1-5212 (5)

FA1-5212 (5)

FA1-5212 (5)

FA1-5212 (5)

FA1-5212 (5)

FA1-5212 (5)

FA1-5212 (5)

FA1-5212 (5)

FA1-5212 (5)

FA1-5212 (5)

FA1-5212 (5)

FA1-5212 (5)

FA1-5212 (5)

FA1-5212 (5)

FA1-5212 (5)

FA1-5212 (5)

FA1-5212 (5)

FA1-5212 (5)

FA1-5212 (5)

FA1-5212 (5)

FA1-5212 (5)

FA1-5212 (5)

FA1-5212 (5)

FA1-5212 (5)

FA1-5212 (5)

FA1-5212 (5)

FA1-5212 (5)

FA1-5212 (5)

FA1-5212 (5)

FA1-5212 (5)

FA1-5212 (5)

FA1-5212 (5)

FA1-5212 (5)

FA1-5212 (5)

FA1-5212 (5)

FA1-5212 (5)

FA1-5212 (5)

FA1-5212 (5)

FA1-5212 (5)

FA1-5212 (5)

FA1-5212 (5)

FA1-5212 (5)

FA1-5212 (5)

FA1-5212 (5)

FA1-5212 (5)

FA1-5212 (5)

FA1-5212 (5)

FA1-5212 (5)

FA1-5212 (5)

FA1-5212 (5)

FA1-5212 (5)

FA1-5212 (5)

FA1-5212 (5)

FA1-5212 (5)

FA1-5212 (5)

部品表 Parts List

Nikon F3P

40FBE-R. 3040. A

部品番号 Part No.	補助番号 Ckt No.	名称 Name	1台分 個数 Pcs. Per Unit	部組品番号 Assembly	参照 図番 Fig. No.	販売区分 Term of Delivery	備考 Remarks	要求単位 Qty per order
5220 (40FBE-5220)		シャッターダイヤル クリックバネ Click spring	1	FA2-5201	A3	○△		10
5346 (40FBE-5346)		リリース押しボタン Release button shaft	1		A2	○		5
5353 (40FBE-5353)		カバー押さえ環 Ring. power lock	1	FA2-5381	A2	○△	RP-8330	5
5409 (40FBE-5409)		枚数表示窓 Window. frame-counter	1	FA1-5003	A3	○△		5
5651-1 (40FBE-5651-1)		巻き戻しノブ Rewind knob	1		D1	○	RP-8342 RP-8517 RP-8527	5
5657 (40FBE-5657)		シュー飾り板 Cover. shoe mount	1		D1	○		5
5663 (40FBE-5663)		巻き戻し軸支え Tube	1		B1	○		5
5668 (40FBE-5668)		開閉クリックレバー Lock lever	1		D1	○		5
5683 (40FBE-5683)		補正目盛ホルダー Holder. exposure compensation scale	1	FA1-5004	C1	○△		5
5686 (40FBE-5686)		補正目盛板 Exposure compensation scale	1		C1	○		5
5714 (40FBE-5714)		バヨネット環 Bayonet ring	1	FA3-5006 FA3-5006-1	40FB Fig5	○△		5
5733 (40FBE-5733)		バヨネットバネ Bayonet spring	1	FA3-5006 FA3-5006-1	40FB Fig5	○△		5
5762 (40FBE-5762)		シュー飾り板下シール Seal	1		D1	○		5
6505 (40FBE-6505)		ASA環保護シール Seal. ASA dial	1		C1	○		5
6506 (40FBE-6506)		ASA環シール Seal. ASA dial	1		C1	○		5
6510 (40FBE-6510)		前側多重部スポンジ Sponge. multi-exposure	1		D3	○		5

Change page (差し替え)

RP- INF. NO. 9467



Nov. 21. 1994

部品表 Parts List

40FBE-R. 3040. A

部品番号 Part No.	補助番号 Ckt No.	名称 Name	1台分 個数 Pcs. Per Unit	部品番号 Assembly	参照 図番 Fig. No.	販売区分 Term of Delivery	備考 Remarks	要求単位 Qty per order
6520 (40FBE-6520)		バヨネット補助リング Bayonet ring	1	FA3-5006		○△	USE TO 40FBE-FA3-5006	5
6535 (40FBE-6535)		ロックリング Lock ring	1		A2	○		5
6536 (40FBE-6536)		メカロックバネ Spring	1		A2	○		5
6537 (40FBE-6537)		メカロックボタン Button, mechanical lock	1		A2	○		5
6555 (40FBE-6555)		ゴムキャップ Rubber cap	1		A2	○		5
6556 (40FBE-6556)		キャップ押さえ Retainer, cap	1	0	A2	○		5
6557 (40FBE-6557)		底部防湿シールA Seal A	1		B2	○		5
6558 (40FBE-6558)		底部防湿シールB Seal B	1		C2	○		5
6559 (40FBE-6559)		MDカップリングキャップ Cap, MD capring	1		B3	○		5
6560 (40FBE-6560)		圧接部シール Seal	1		A3	○		5
6566 (40FBE-6566)		巻上げDCシール Seal	1		A3	○		5
6567 (40FBE-6567)		カバー下スポンジ Sponge, cover	1		D2	○		5
△ 6568 (40FBE-6568)		多重爪制限ピン Pin	1		B3	○	RP-9467	5

Change page (差し替え) △×1



部品表 Parts List

40FBE-R. 3040. A

部品番号 Part No.	補助番号 Ckt No.	名称 Name	1台分 個数 Pcs. Per Unit	部組品番号 Assembly	参照 図番 Fig. No	販売区分 Term of Delivery	備考 Remarks	要求単位 Q'ty per order
A2-17028FA	5881	上カバー受け台ネジ Screw, top cover	1		A3	○		10 or 50
A2-14016BS	5912	上カバー止めネジ Screw	1		C1	○		10 or 50
	6126	リード線 Lead wire	1			×	W-0056PU	
	6130	シンクロ信号C. リード線 Lead wire	1	FA1-5771		×	W-0080PU	
	6131	レディライト用コード Lead wire	1			×	W-0056WH	
		裏蓋 Camera back	1		A1		USE TO FRW51602 (MF-GB)	

この部品表は、40FBE (F3P) 専用部品のみ記載。
 他の部品については、40FB (F3) ・ 40FBT (F3T) にて要求方。
 This parts list shows the exclusive parts for 40FBE (F3P) only.
 As for the common parts, please refer to the parts lists for 40FB (F3) / 40FBT (F3T).

部組品表 Assembly List

40FBE-R. 3040. A

部組番号 Part No.	補助番号 Ckt No.	名称 Name	1台分 個数 Qty Per Unit	大部組品番号 Constituent parts	参照 図番 Fig. No.	備考 Remarks	要求単位 Order Unit Qty
FA1-3034 (40FBE-FA1-3034)		MDコネクター基板 MD connector base plate	1	FA4-6001	C3		5
FA1-5003 (40FBE-FA1-5003)		右上カバー (巻上げ側) Top cover, wind side	1		A2		1
FA1-5004 (40FBE-FA1-5004)		左上カバー (巻き戻し側) Top cover, rewind side	1		C1		1
FA1-5132 (40FBE-FA1-5132)		表示ブロック	1	FA4-6001	D1		5
FA1-5212 (40FBE-FA1-5212)		シャッターダイヤル	1	FA2-5201	A2		5
FA1-5681 (40FBE-FA1-5681)		ASA環 ASA dial	1		C1		5
FA1-5682 (40FBE-FA1-5682)		補正環 Exposure compensation ring	1		C1		5
FA1-5715 (40FBE-FA1-5715)		絞り連動環 Aperture coupling ring	1		40FB Fig5		1
FA1-5771 (40FBE-FA1-5771)		接点 (ホットシュー) Conector (H shoe)	2	FA3-5006 FA3-5006-1	D2		5
FA1-6501 (40FBE-FA1-6501)		中間リング Ring	1		A2		5
FA2-5201 (40FBE-FA2-5201)		シャッターダイヤル基板 Unit, shutter-speed selector	1		A3		1
FA2-5381 (40FBE-FA2-5381)		巻上げ基板 Unit, take-up gear	1		A1		1
FA2-5603 (40FBE-FA2-5603)		巻上げシグナル基板 Unit, film-advance completion signal	1		B3		1
FA2-5661 (40FBE-FA2-5661)		巻き戻し部取付け板 Unit, rewind shaft	1		C2		1
FA3-5006 (40FBE-FA3-5006)		前ボディ	1		D1	USE TO 40FBE-6520 OLD	1
FA3-5006-1 (40FBE-FA3-5006-1)		Assembly, front plate				サービス技報 No.90-17号	1
FA4-5281 (40FBE-FA4-5281)		ユニットシャッター Assembly, shutter	1		B1		1
FA4-6001 (40FBE-FA4-6001)		F P C	1		C2		1

配布許可印

F 3 L i m i t e d

PARTS LIST

修 理 部 品 表

Nikon | NIKON CORPORATION
Tokyo, Japan

© Copyright 1993
ALL RIGHTS RESERVED
無断転載を禁ず!!

部組品表 Assembly List

F 3 Limited

40FBE-R. 3351. A

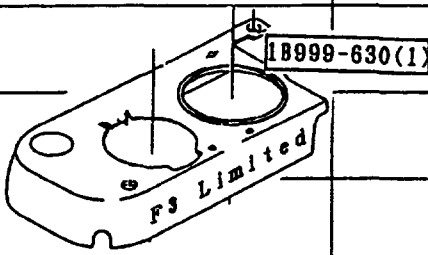
部組番号 Part No.	補助番号 Ckt No.	名称 Name	1台分 個数 Qty Per Unit	大部組品番号 Main assembly No	参照 図番 Fig. No.	備考 Remarks	要求単位 Order Unit Qty
1B999-630		右上カバー (巻上げ側) Top cover. wind side	1		A2		1
							

その他の部品、部組品は、F 3 P と共通です。
 Other parts and assemblies are same to those of F 3 P' s.