

PROPRIETARY STATEMENT: ULTRAVOLT INC.  
CONFIDENTIAL DRAWING

REVISIONS				
REV	DESCRIPTION	BY	DATE	APPD
A	RELEASED TO DOC-CTRL	A.S.	07/13/2012	PM

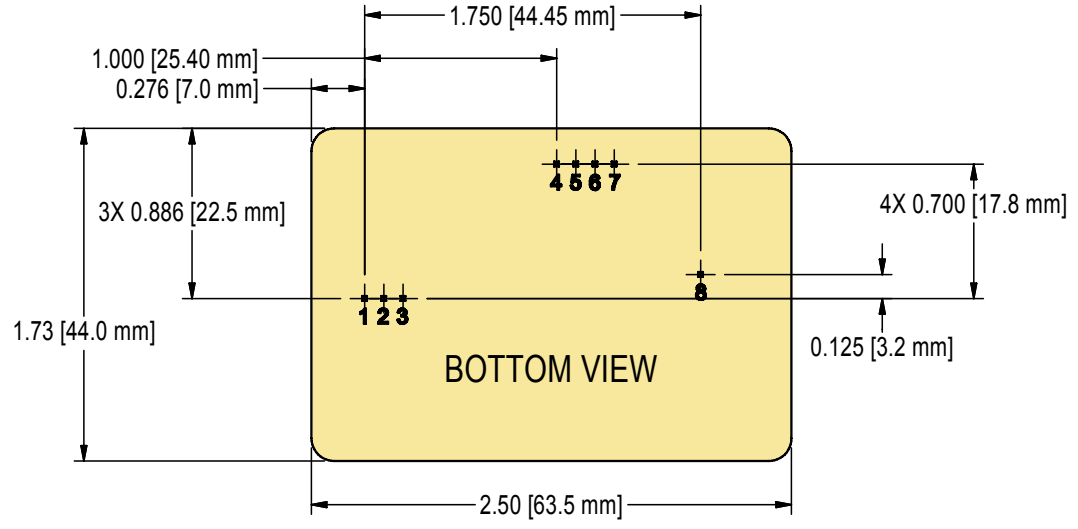
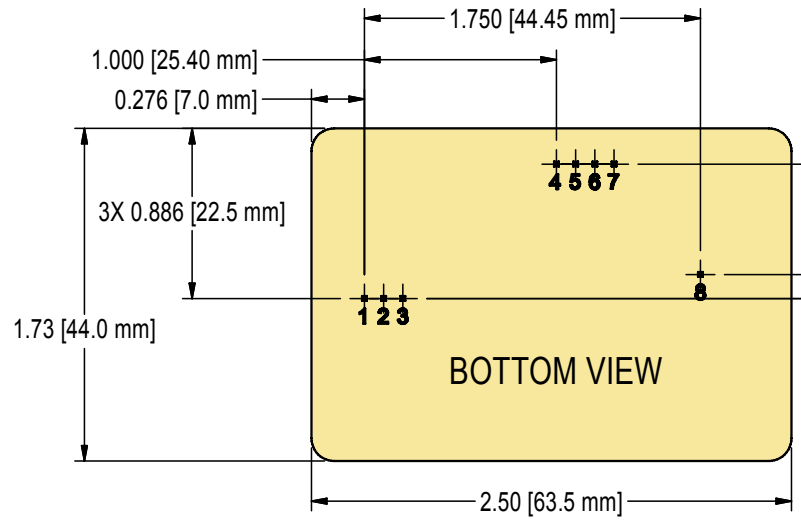
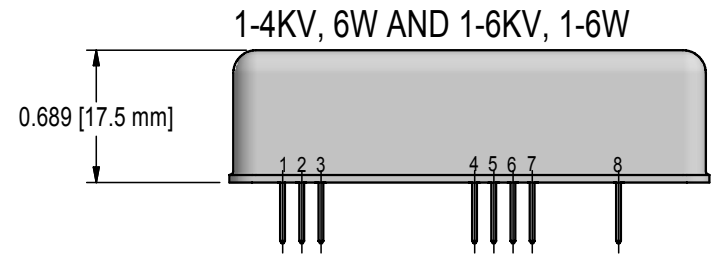
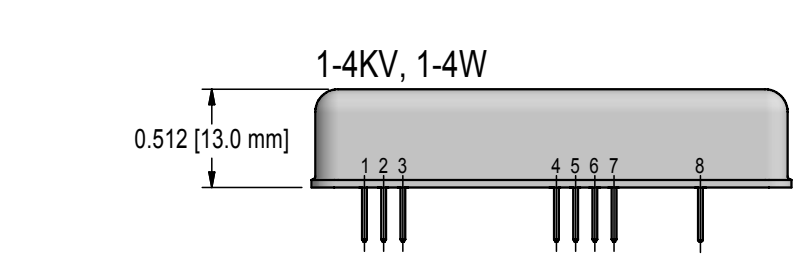

PCB MOUNTING (TOP VIEW)  
4W & 6W

TYPICAL HOLE SIZE  
Ø0.050 ± .003 [1.27 ± 0.08 mm] THRU PLATED  
(8 PLACES)  
SEE NOTE 1.4

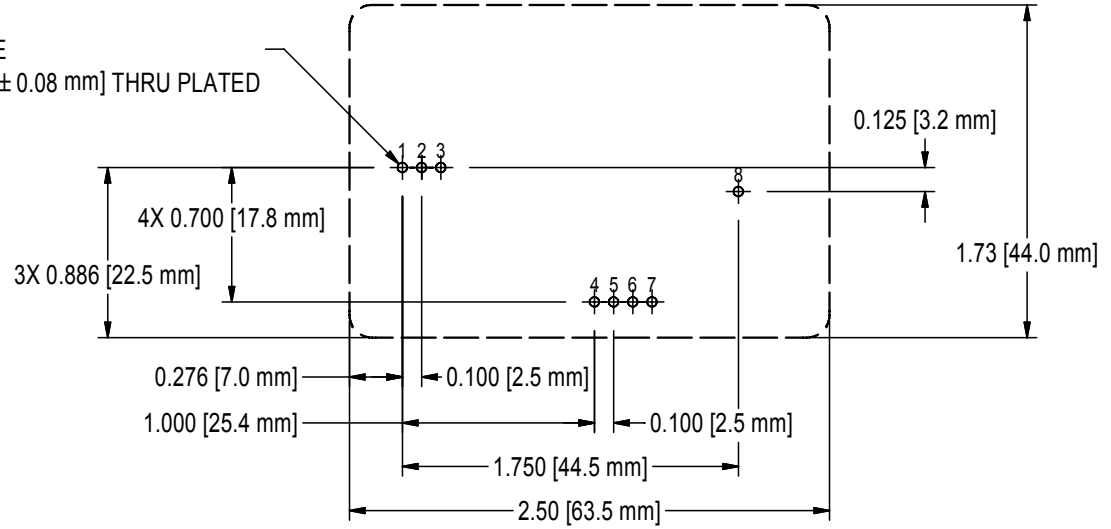

- NOTES:
- 1- PINS:
    - 1.1- MATERIAL: GOLD PLATED 0.025 [0.63mm] SQUARE.
    - 1.2- THE CENTER OF THE PINS TABS ARE LOCATED FROM CENTER OF PIN 1.
    - 1.3- PINS 1 THRU 3 AND 4 THRU 7 SPACING 0.100 [2.54mm] ON CENTER, HEIGHT FROM SEATING PLANE 0.240 [6.10mm] MIN.
    - 1.4- THIS IS A SUGGESTED MOUNTING PATTERN. PLEASE REVIEW IT FOR SUITABILITY IN YOUR APPLICATION.
  - 2- CONSTRUCTION:
    - TIN STEEL PLATE, 0.020 [0.50mm].
    - INSULATION: FULLY POTTED IN AN EPOXY RESIN.
  - 3- TOLERANCES:
    - 3.1- OVERALL ±0.050 [1.27mm]
    - 3.2- PIN TO PIN ±0.015 [0.38mm]
  - 4- RoHS:
    - UNITS ARE RoHS COMPLIANT.

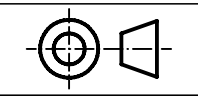

UNLESS OTHERWISE SPECIFIED DIMENSION ARE IN INCHES [mm] TOLERANCES ARE:			CUSTOMER		
2 PL DEC ± .02	FRACT ± 1/64		DRAWN	Adrian Siu	DATE
3 PL DEC ± .010	ANGLES ± 5°		CHECKED	Chris Vorvoreanu	7/17/2012
HOLE DIA	TOLERANCES		CSD	Justin Kubicki	7/17/2012
.0135 THRU .125	+ .004 - .004		MFG ENGR	N/A	
.126 THRU .250	+ .005 - .005		MARKETING	Richard Bailey	7/16/2012
.251 THRU .500	+ .006 - .006		QA	Ralph Palotta	7/17/2012
.501 THRU .750	+ .008 - .008		ENG	Peter Match	7/16/2012
.751 THRU 1.000	+ .010 - .010		CFN: OL-079_rev_A_D.idw		
1.001 THRU 2.000	+ .012 - .012				
DASH NUMBER	NEXT ASSY	USED ON			
APPLICATION					

**ULTRAVOLT, INC.**  
1800 OCEAN AVE. FRNT, RONKONKOMA, N.Y. 11779  
1-631-471-4444

OUTLINE,  
D SERIES

PART NUMBER: **OL-079** REV **A**

SCALE NONE DO NOT SCALE THIS DRAWING SHEET 1 OF 2



PROPRIETARY STATEMENT: ULTRAVOLT INC.  
CONFIDENTIAL DRAWING

1-4KV, 1-4W

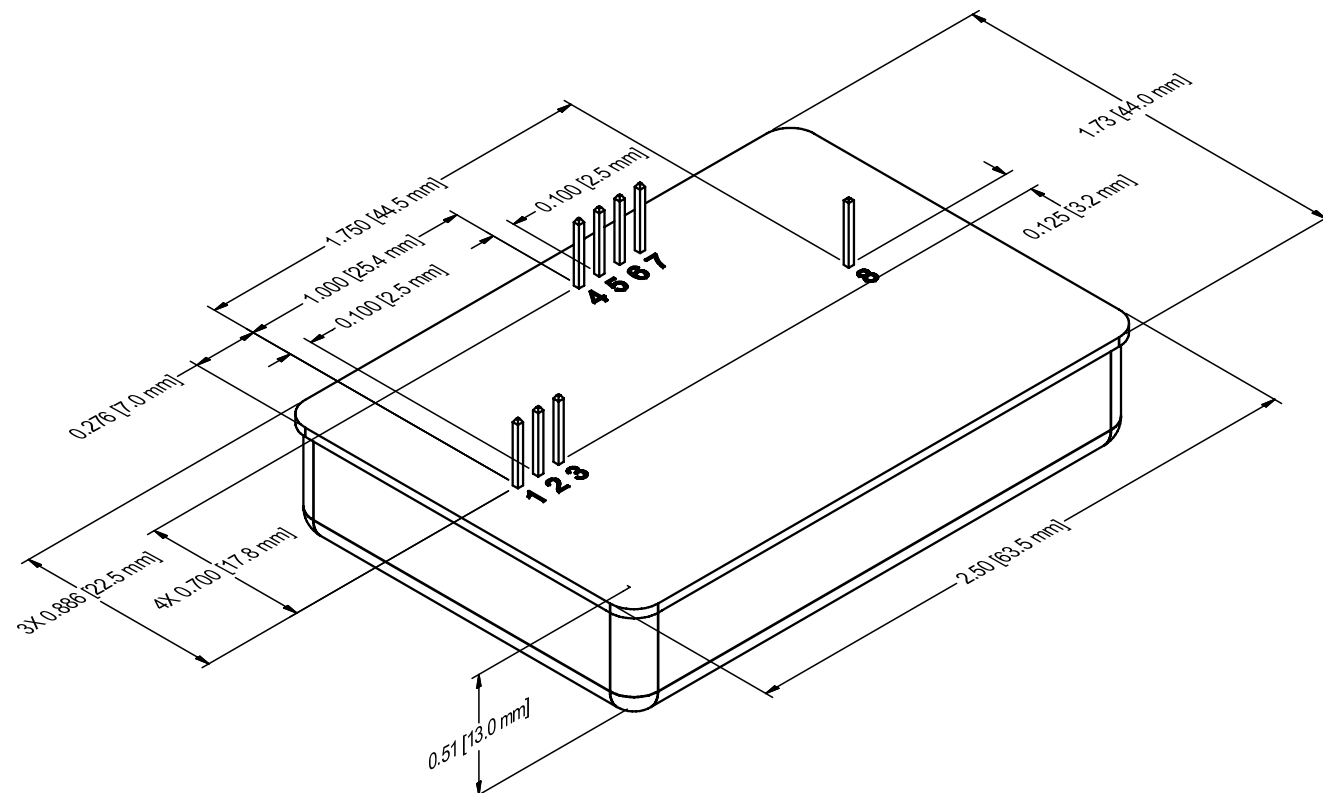

1-4KV, 6W AND 1-6KV, 1-6W

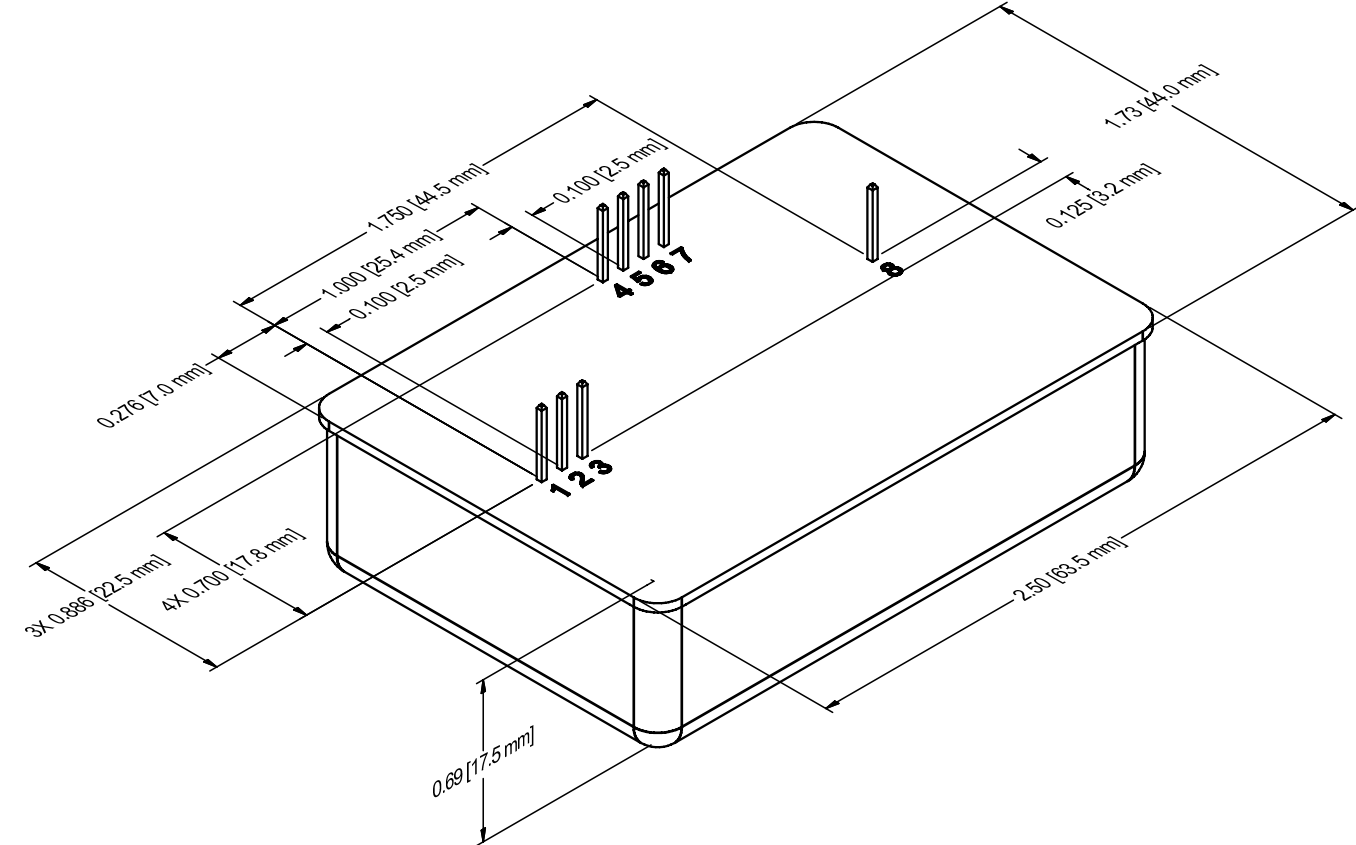

**ULTRAVOLT, INC.**

1800 OCEAN AVE. FRNT, RONKONKOMA, N.Y. 11779  
1-631-471-4444

B

PART NUMBER:

OL-079

REV

A

