

PROPRIETARY STATEMENT: ULTRAVOLT INC.
CONFIDENTIAL DRAWING

REVISIONS				
REV	DESCRIPTION	BY	DATE	APPD
A	RELEASED TO DOC-CTRL	A.S.	6/07/2012	RB

PXS - THRU-HOLE PACKAGE

PXS - SMT PACKAGE

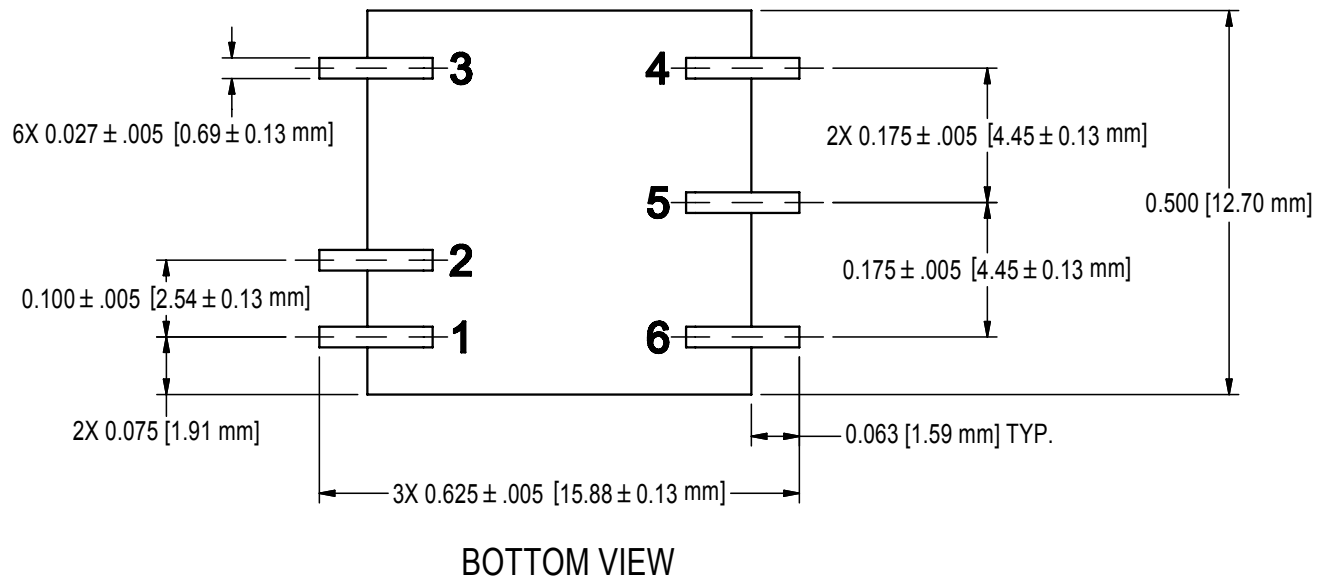
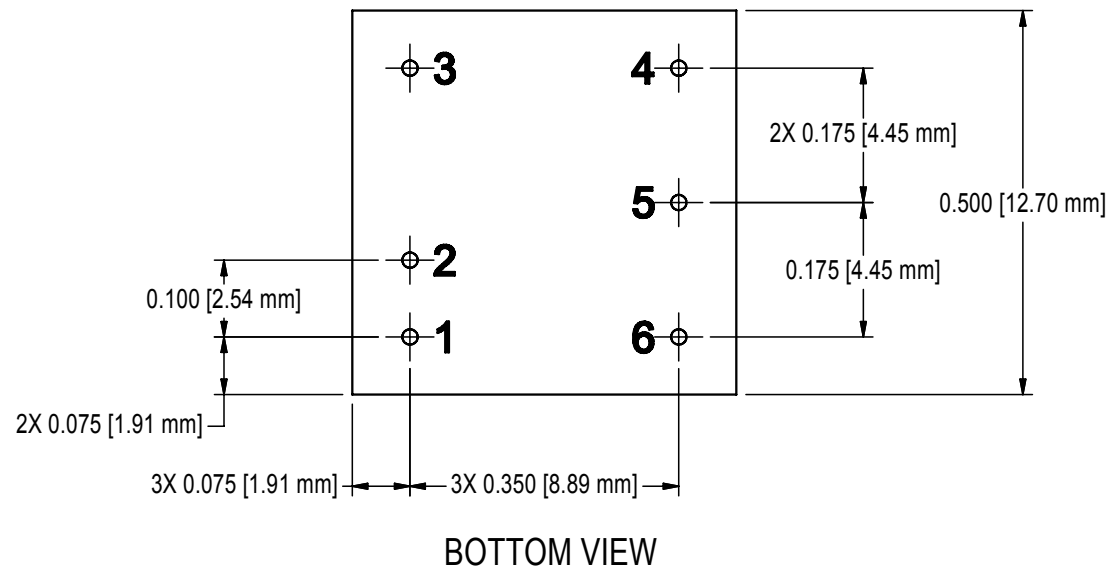
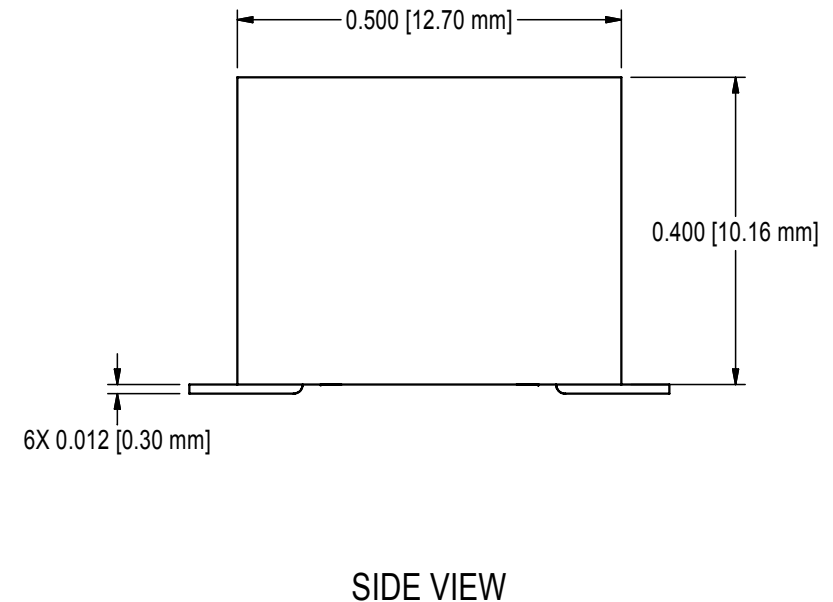
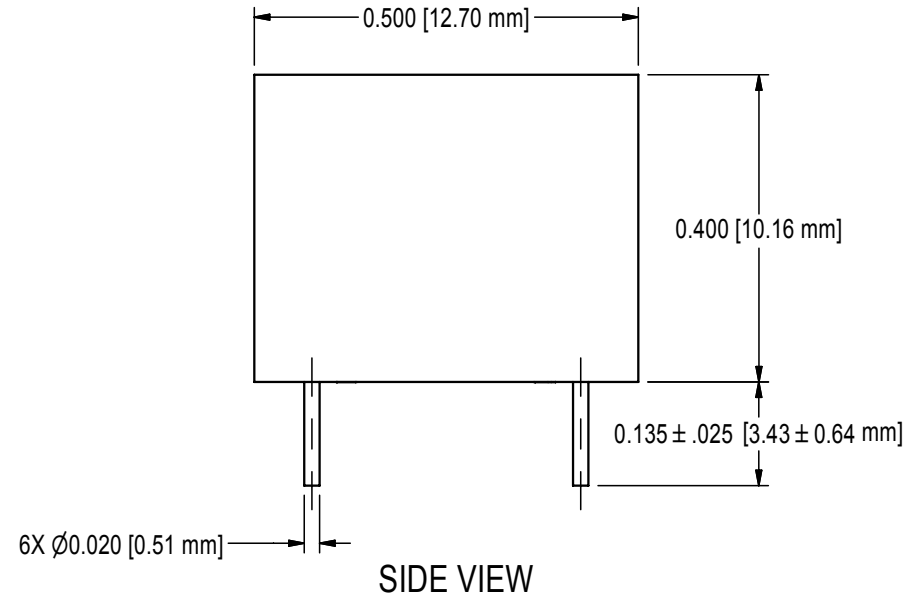

NOTES:
 1- PINS:
 THRU-HOLE: BRASS (UNS C36000 PER ASTM B16),
 TIN OVER NICKEL PLATED, 0.020 [0.51mm] ROUND.
 SMT: COPPER, TIN PLATED, 0.012 [0.30mm] X 0.027 [0.69mm].
 2- CONSTRUCTION:
 RED DIALYL PHTHALATE PER ASTM D5948 TYPE SDG-F.
 INSULATION: FULLY POTTED IN AN EPOXY RESIN.
 3- TOLERANCES:
 ALL DIMENSIONS HAVE A TOLERANCE OF ±0.010 [0.25mm]
 UNLESS OTHERWISE SPECIFIED.
 4- RoHS:
 UNITS ARE RoHS COMPLIANT.

UNLESS OTHERWISE SPECIFIED DIMENSION ARE IN INCHES [mm]			CUSTOMER		
TOLERANCES ARE:			DRAWN	Adrian Siu	DATE
2 PL DEC ± .02 FRACT ± 1/64			CHKD	Chris Vorvoreanu	6/12/2012
3 PL DEC ± .010 ANGLES ± 2'			CSD	Scott Wilson	6/13/2012
HOLE DIA			MFG ENGR	N/A	
.0135 THRU .125			MARKETING	Richard Bailey	6/13/2012
.126 THRU .250			QA	Ralph Palotta	6/13/2012
.251 THRU .500			ENG	Brian Long	6/12/2012
.501 THRU .750			CFN: OL-083_revA_PXS.idw		
.751 THRU 1.000					
1.001 THRU 2.000					
DASH NUMBER	NEXT ASSY	USED ON			
APPLICATION					

ULTRAVOLT, INC.
 1800 OCEAN AVE. FRNT, RONKONKOMA, N.Y. 11779
 1-631-471-4444

OUTLINE,
PXS POWER SUPPLY

PART NUMBER: **OL-083** REV **A**

SCALE NONE DO NOT SCALE THIS DRAWING SHEET 1 OF 3

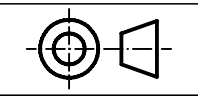



PROPRIETARY STATEMENT: ULTRAVOLT INC.
CONFIDENTIAL DRAWING

PXS - THRU-HOLE PACKAGE FOOTPRINT

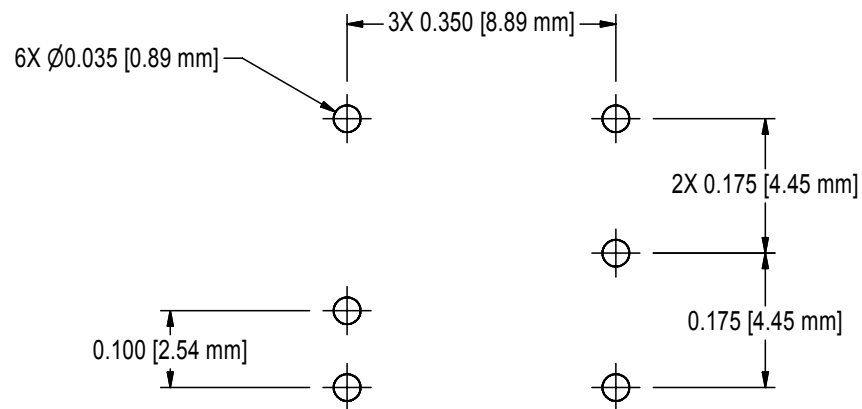

PXS - SMT PACKAGE FOOTPRINT

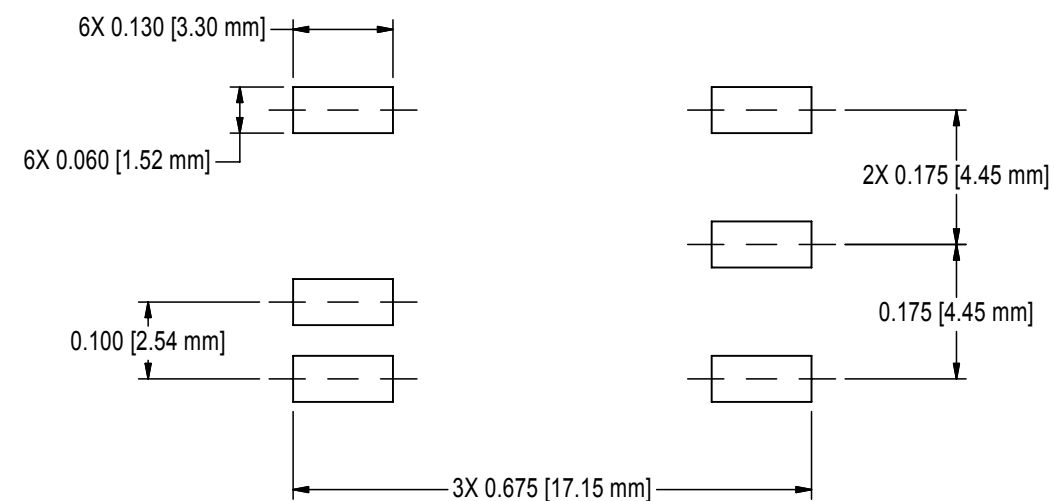

NOTE: THESE DIMENSIONS ARE FOR A STARTING POINT ONLY
AND MAY NEED TO CHANGE BASED ON THE MANUFACTURING
PROCESSES USED TO PLACE THE PART.

ULTRAVOLT, INC.

1800 OCEAN AVE. FRNT, RONKONKOMA, N.Y. 11779
1-631-471-4444

B

PART NUMBER:

OL-083

REV

A



B



A

B



A



PROPRIETARY STATEMENT: ULTRAVOLT INC.
CONFIDENTIAL DRAWING

PXS - THRU-HOLE PACKAGE

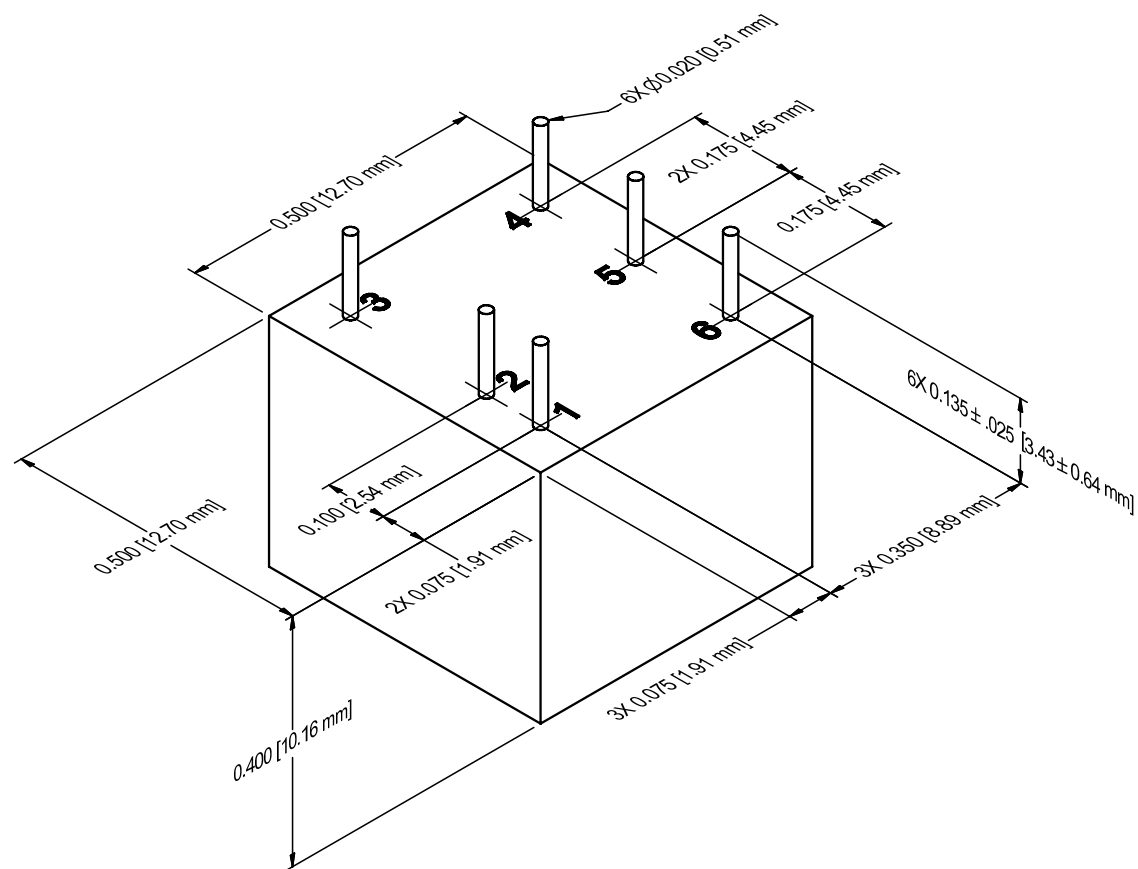

PXS - SMT PACKAGE

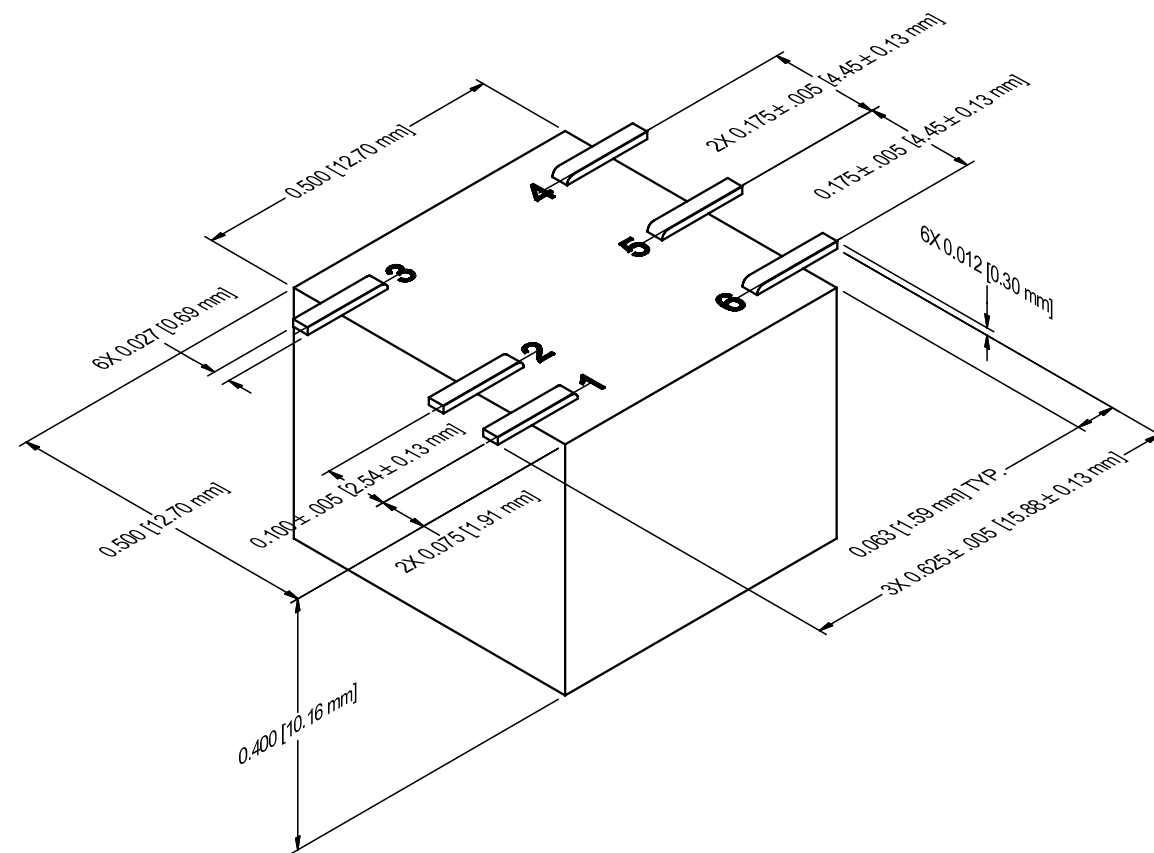

ULTRAVOLT, INC.		
1800 OCEAN AVE. FRNT, RONKONKOMA, N.Y. 11779 1-631-471-4444		
B	PART NUMBER: OL-083	REV A
SCALE NONE	DO NOT SCALE THIS DRAWING	SHEET 3 OF 3