

PROPRIETARY STATEMENT: ULTRAVOLT INC.
CONFIDENTIAL DRAWING

REVISIONS				
REV	DESCRIPTION	BY	DATE	APPD
A	RELEASED TO DOC-CTRL	A.S.	05/10/2012	LH

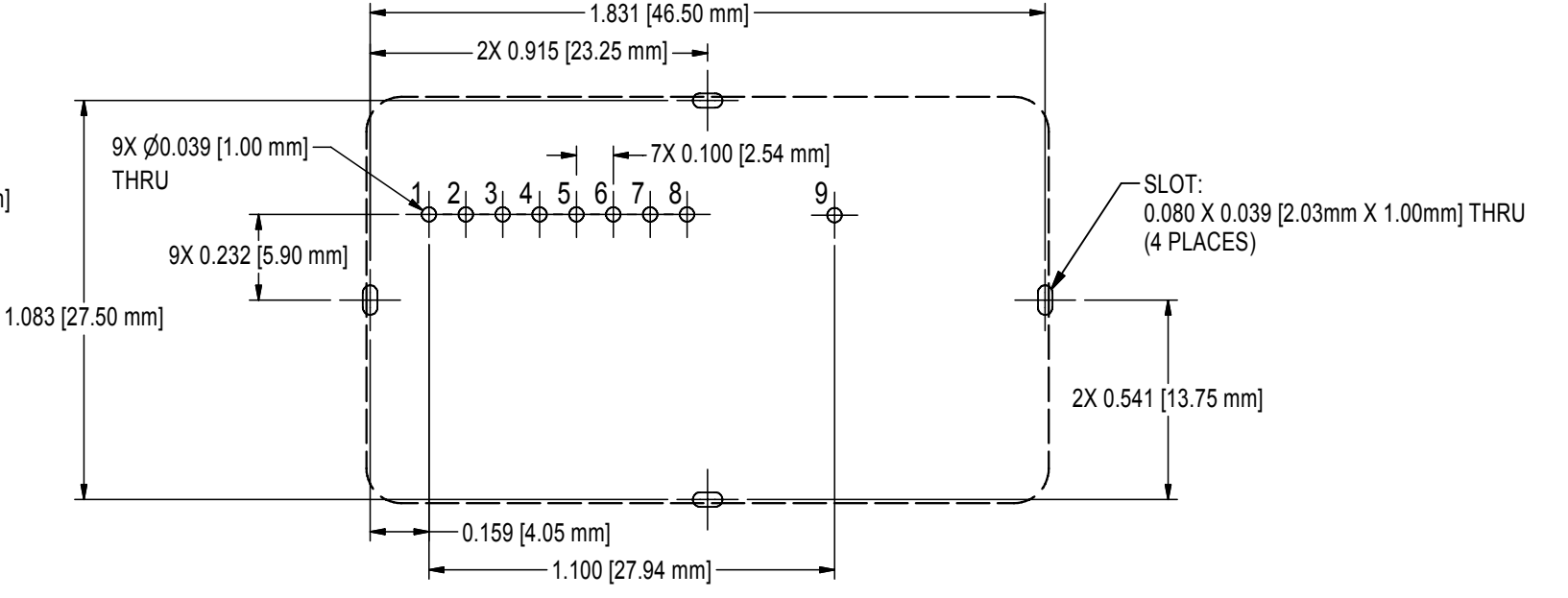
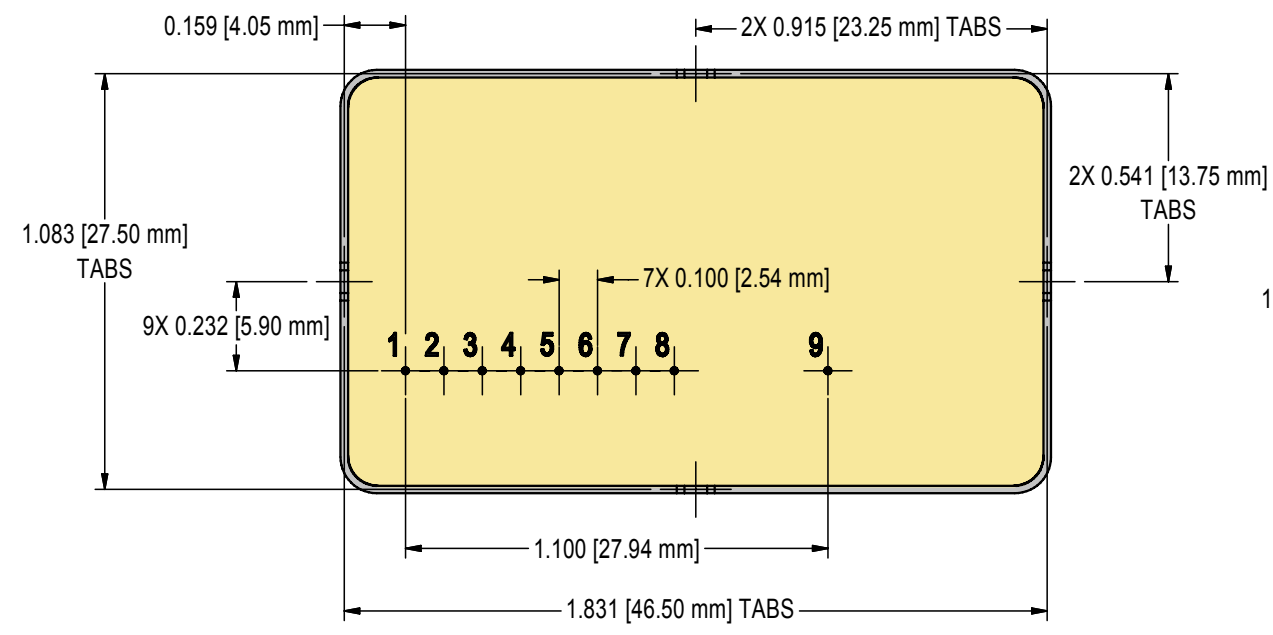
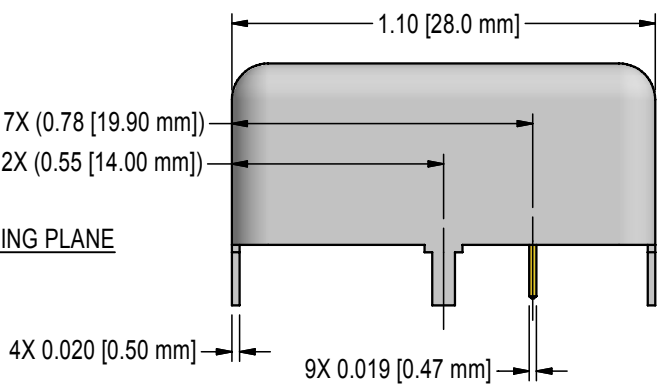
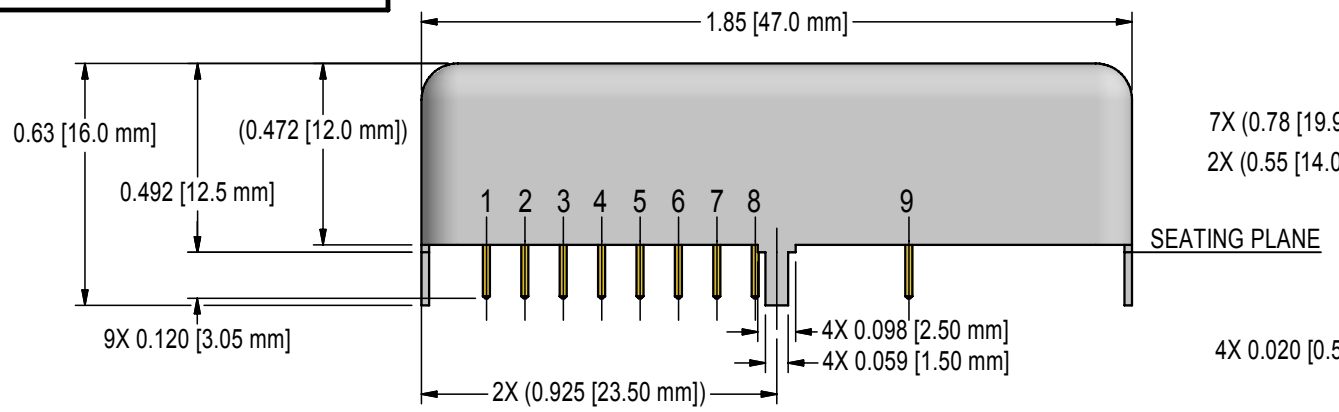

PCB MOUNTING (TOP VIEW)

- NOTES:
- PINS:
 - MATERIAL: GOLD PLATED 0.019 [0.47mm] ROUND.
 - THE CENTER OF THE PINS TABS ARE LOCATED FROM CENTER OF PIN 1.
 - PINS 1 THRU 8 SPACING 0.100 [2.54mm] ON CENTER, HEIGHT FROM SEATING PLANE 0.120 [3.05mm].
 - CONSTRUCTION:
 - STEEL, ZINC PLATED, 0.020 [0.51mm] THICK.
 - INSULATION: FULLY POTTED IN AN EPOXY RESIN.
 - TOLERANCES:
 - OVERALL ± 0.030 [0.76mm]
 - PIN TO PIN ± 0.015 [0.38mm]
 - PIN TO TAB ± 0.020 [0.51mm]
 - TAB TO TAB ± 0.010 [0.25mm]
 - TAB FEATURES ± 0.005 [0.13mm]
 - RoHS:
 - UNITS ARE RoHS COMPLIANT.

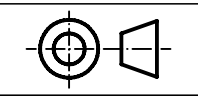

UNLESS OTHERWISE SPECIFIED DIMENSION ARE IN INCHES [mm] TOLERANCES ARE:			CUSTOMER		
2 PL DEC $\pm .02$	FRACT $\pm 1/64$	DATE	DRAWN	Adrian Siu	5/9/2012
3 PL DEC $\pm .010$	ANGLES $\pm 2'$	5/22/2012	CHECKED	Justin Kubicki	5/22/2012
			CSD	Scott Wilson	5/22/2012
			MFG ENGR	Lloyd Hasluck	5/22/2012
			MARKETING	Rich Bailey	5/22/2012
			QA	Ralph Palotta	5/22/2012
			ENG	Brian Long	5/22/2012
			CFN:	OL-085_revA_M-EI.idw	

HOLE DIA	TOLERANCES
.0135 THRU .125	+ .004 - .004
.126 THRU .250	+ .005 - .005
.251 THRU .500	+ .006 - .006
.501 THRU .750	+ .008 - .008
.751 THRU 1.000	+ .010 - .010
1.001 THRU 2.000	+ .012 - .012

DASH NUMBER	NEXT ASSY	USED ON
APPLICATION		

ULTRAVOLT, INC.
1800 OCEAN AVE. FRNT, RONKONKOMA, N.Y. 11779
1-631-471-4444

OUTLINE,
M SERIES, WITH "-EI" OPTION

B	PART NUMBER:	OL-085	REV	A
	SCALE	NONE	DO NOT SCALE THIS DRAWING	SHEET 1 OF 1