

EXPOSED PAD CORNER
TAB DETAIL

DETAIL 'A'

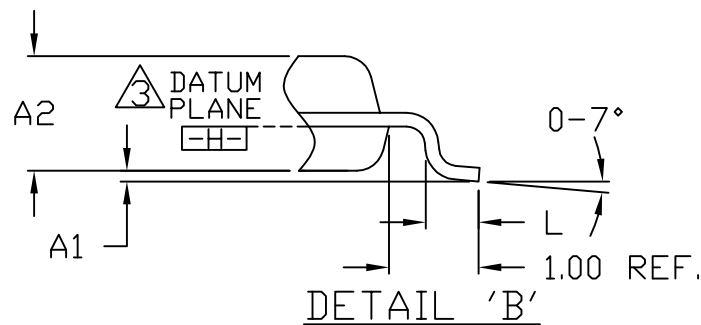

TITLE:
PACKAGE OUTLINE, 64L TQFP, 10x10x1.00mm
EXPOSED PAD, INVERTED PAD

APPROVAL

DOCUMENT CONTROL NO.

REV.

21-0162

B

1/2

-DRAWING NOT TO SCALE-

NOTES:

1. ALL DIMENSIONS ARE IN MILLIMETERS UNLESS OTHERWISE SPECIFIED.
2. ALL DIMENSIONS AND TOLERANCING CONFORM TO ANSI Y14.5-1982.
3. DATUM PLANE $\square H$ IS LOCATED AT MOLD PARTING LINE AND COINCIDENT WITH LEAD, WHERE LEAD EXITS PLASTIC BODY AT BOTTOM OF PARTING LINE.
4. DIMENSIONS D1 AND E1 DO NOT INCLUDE MOLD PROTRUSION. ALLOWABLE MOLD PROTRUSION IS 0.25MM MM PER SIDE.
5. THE TOP OF PACKAGE IS SMALLER THAN THE BOTTOM OF PACKAGE BY AS MUCH AS 0.15 MILLIMETERS.
6. DIMENSION b DOES NOT INCLUDE DAMBAR PROTRUSION. ALLOWABLE DAMBAR PROTRUSION SHALL BE 0.08 MM TOTAL IN EXCESS OF THE b DIMENSION AT MAXIMUM MATERIAL CONDITION.
7. MEET JEDEC MS-026 EXCEPT FOR COPLANARITY (SEE NOTE 8).
8. LEADS SHALL BE COPLANAR WITHIN 0.10 MM.
9. EXPOSED DIE PAD SHALL BE COPLANAR WITH BOTTOM OF PACKAGE WITHIN 2 MILS (0.05 MM).
10. MATERIAL MUST COMPLY WITH BANNED AND RESTRICTED SUBSTANCES SPEC# 10-0131
11. ALL DIMENSIONS APPLY TO BOTH LEADED (-) AND PbFREE (+) PKG. CODES.

SYMBOL	COMMON DIMENSIONS ALL DIMENSIONS IN MILLIMETERS	
	JEDEC VARIATION ACD	
	MIN.	MAX.
A	\approx	1.20
A ₁	0.05	0.15
A ₂	0.95	1.05
D	12.00 BSC	
D ₁	10.00 BSC	
E	12.00 BSC	
E ₁	10.00 BSC	
L	0.45	0.75
N	64	
e	0.50 BSC	
b	0.17	0.27
b ₁	0.17	0.23

EXPOSED PAD VARIATIONS						
PKG CODE	D2			E2		
	MIN.	NOM.	MAX.	MIN.	NOM.	MAX.
C64E-4R	4.7	5.0	5.3	4.7	5.0	5.3
C64E-9R	5.7	6.0	6.3	5.7	6.0	6.3
C64E-13R	4.7	5.0	5.3	4.7	5.0	5.3



TITLE:
PACKAGE OUTLINE, 64L TQFP, 10x10x1.00mm
EXPOSED PAD, INVERTED PAD

APPROVAL	DOCUMENT CONTROL NO. 21-0162	REV. B	2/2
----------	---------------------------------	-----------	-----