

TOP VIEW

SIDE VIEW

BOTTOM VIEW

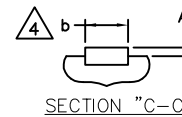
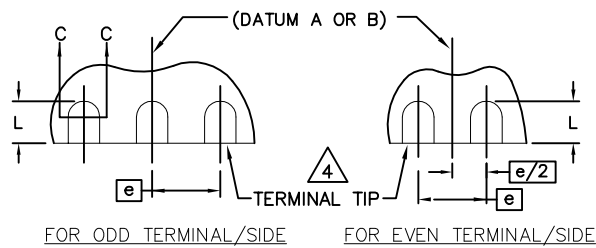

SYMBOL	COMMON DIMENSIONS			NOTE
	MIN.	NOM.	MAX.	
A	0.50	0.55	0.60	
A1	0.00	0.01	0.05	
A3	0.15 REF.			
D	3.50			
E	4.50			
θ	0	-	12°	2
e	0.40 BSC			
N	28			3
L	0.20	0.30	0.40	
b	0.15	0.20	0.25	4
Pkgcodes: V283A4F+2				

NOTES:

1. DIMENSIONING AND TOLERANCING CONFORME TO ASME Y14.5M - 1994.
2. ALL DIMENSIONS ARE IN MILLIMETERS, 0 IS IN DEGREES.
3. N IS THE TOTAL NUMBER OF TERMINALS.
4. DIMENSION b APPLIES TO METALLIZED TERMINAL AND IS MEASURED BETWEEN 0.15 AND 0.30mm FROM TERMINAL TIP. IF THE TERMINAL HAS THE OPTIONAL RADIUS ON THE OTHER END OF THE TERMINAL, THE DIMENSION b SHOULD NOT BE MEASURED IN THAT RADIUS AREA.
5. PIN #1 ID ON TOP WILL BE LASER MARKED.
6. BILATERAL COPLANARITY ZONE APPLIES TO THE EXPOSED HEAT SINK SLUG AS WELL AS THE TERMINALS.
7. MARKING SHOWN IF FOR PACKAGE ORIENTATION ONLY.
8. ALL DIMENSIONS APPLY TO PBFREE (+) PKGCODES ONLY.



TITLE:
PACKAGE OUTLINE, 28L
MIS PKG., FLIP CHIP

APPROVAL

DOCUMENT CONTROL NO.
21-0178

REV. B 1/1

-DRAWING NOT TO SCALE-