

TOP VIEW

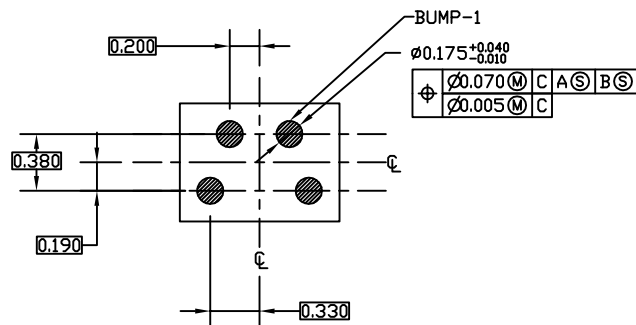

BOTTOM VIEW

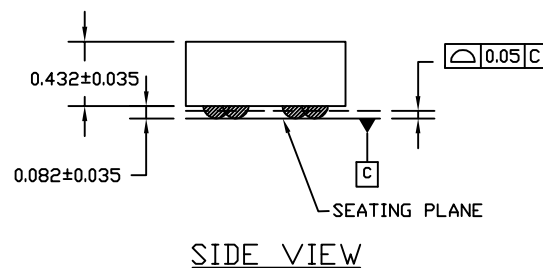

SIDE VIEW

| TABLE 1. LAND PAD CONNECTIONS AND CENTER COORDINATES | | | | | |
|--|------|-------------|-------|---------|---------|
| | | MILLIMETERS | | INCHES | |
| NUMBER | NAME | X | Y | X | Y |
| 1 | I/O | .200 | .190 | 0.0079 | 0.0075 |
| 2 | VSS | -.200 | .190 | -0.0079 | 0.0075 |
| 5 | RVSS | -.330 | -.190 | -0.0130 | -0.0075 |
| 6 | RI/O | .330 | -.190 | -0.0130 | -0.0075 |

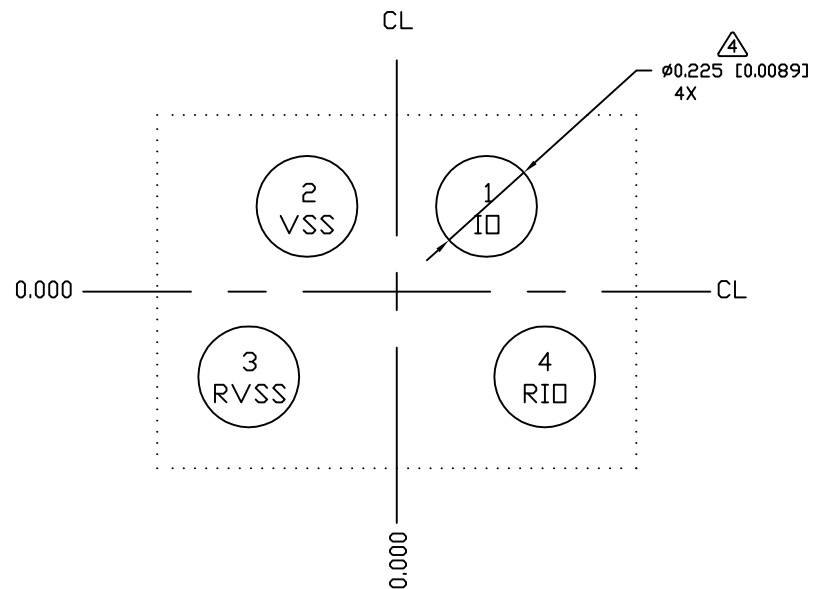

TOP VIEW

RECOMMENDED SUBSTRATE
LAND PATTERN

NOTES:

- ALL DIMENSIONS ARE IN MILLIMETERS UNLESS OTHERWISE SPECIFIED.
- MATERIAL MUST COMPLY WITH BANNED AND RESTRICTED SUBSTANCES SPEC # 10-0131.
- LASER MARK
- LANDING PAD DIAMETER NOT DEFINED BY SOLDERMASK; FOR PAD CONNECTIONS SEE TABLE 1.
- ALL DIMENSIONS APPLY TO LEADED (-), PKG. CODES ONLY.
- PACKAGE CODE: BF411-3



| | | | |
|---|---------------------------------|-----------|-----|
| TITLE: PACKAGE OUTLINE, 4 BUMPS FLIP CHIP, 0.788x1.068x0.432mm, 0.380mm PITCH | | | |
| APPROVAL | DOCUMENT CONTROL NO. 21-0380 | REV. B | 1/1 |