

LEAD FORM DETAILS

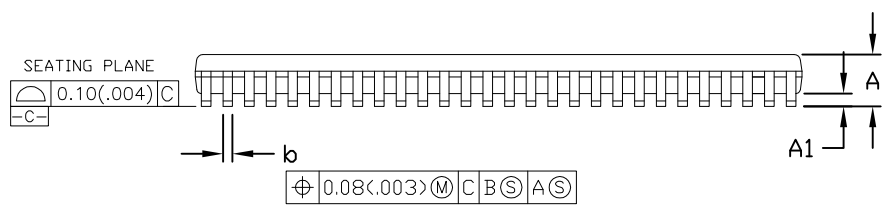
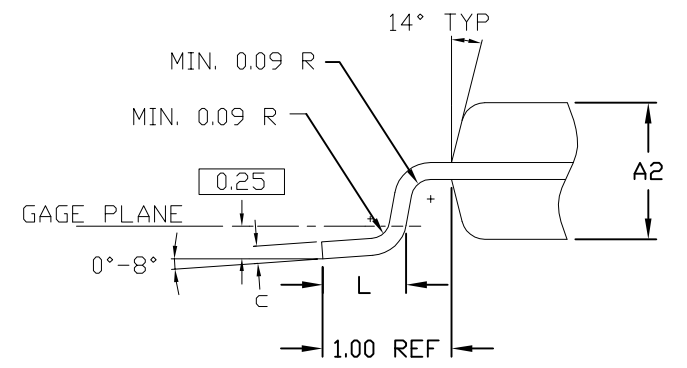

TITLE:
PACKAGE OUTLINE,
56L TSSOP 6.1mm BODY

APPROVAL	DOCUMENT CONTROL NO. 21-0481	REV. B	1/2
----------	---------------------------------	-----------	-----

-DRAWING NOT TO SCALE-

NOTES:

1. DIMENSIONS D & E ARE REFERENCE DATUMS AND DO NOT INCLUDE MOLD FLASH.
2. MOLD FLASH OR PROTRUSIONS NOT TO EXCEED 0.15MM ON D SIDE, AND 0.25MM ON E SIDE.
3. CONTROLLING DIMENSION: MILLIMETERS.
4. THIS PART IS COMPLAINT WITH JEDEC SPECIFICATION MO-153-EE.
5. "N" REFERS TO NUMBER OF LEADS.
6. THE LEAD TIPS MUST LIE WITHIN A SPECIFIED ZONE. THE TOLERANCE ZONE IS DEFINED BY TWO PARALLEL PLANES. ONE PLANE IS THE SEATING PLANE, DATUM (-C-), THE OTHER PLANE IS AT THE SPECIFIED DISTANCE FROM (-C-) IN THE DIRECTION INDICATED.
7. MARKING SHOWN IS FOR PACKAGE ORIENTATION REFERENCE ONLY.
8. ALL DIMENSIONS APPLY TO BOTH LEADED (-) AND P_bFREE (+) PKG. CODES.

COMMON DIMENSIONS				
REF.	MIN.	NOM.	MAX.	NOTE
A	--	--	1.20	
A1	0.05	--	0.15	
A2	0.80	--	1.05	
b	0.17	--	0.27	
c	0.09	--	0.20	
E	6.00	6.10	6.20	
D	13.90	14.00	14.10	
e	0.50 BSC			
H	7.95	--	8.25	
L	0.45	0.60	0.75	
N	56			
PKG CODE: U56-1 ; U56-1C				

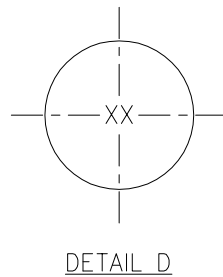

MOLD CAVITY
SERIAL NUMBER
A1 - A30
B1 - B30
C1 - C30
D1 - D30

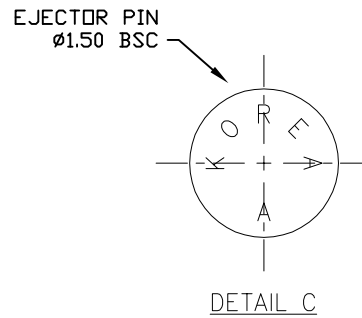

TITLE:
PACKAGE OUTLINE,
56L TSSOP 6.1mm BODY

APPROVAL	DOCUMENT CONTROL NO. 21-0481	REV. B	2/2
----------	---------------------------------	-----------	-----

-DRAWING NOT TO SCALE-