

TOP VIEW

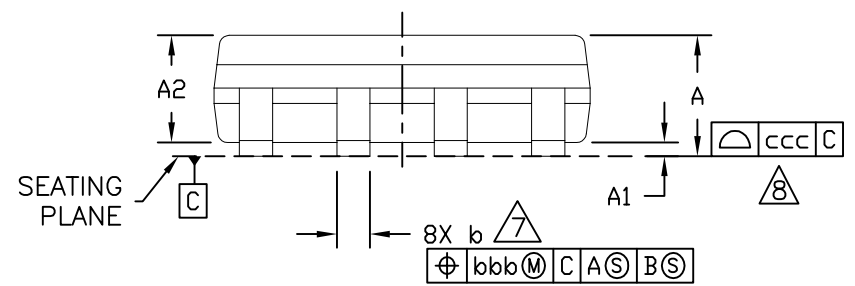

SIDE VIEW

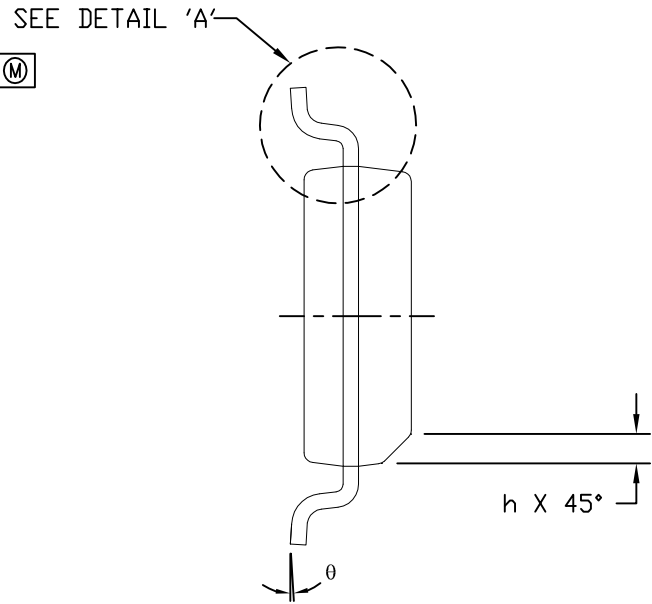
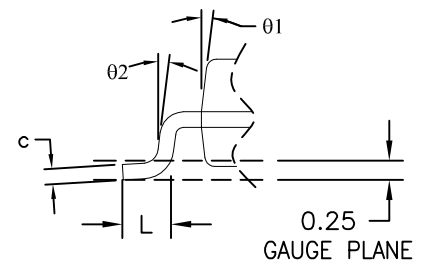

DETAIL 'A'



TITLE: PACKAGE OUTLINE, 8L SOIC, 150 MIL - SENSOR DYNAMICS			
APPROVAL RAMON DE LEON 12/20/11	DOCUMENT CONTROL NO. 21-0640	REV. A	1/2

-DRAWING NOT TO SCALE-

NOTES:

1. ALL DIMENSIONS ARE IN MILLIMETERS. ANGLES ARE IN DEGREES.
2. DIMENSIONING & TOLERANCING CONFORM TO ASME Y14.5M-1994.
3. N IS THE TOTAL NUMBER OF TERMINALS.
4. THE TERMINAL #1 IDENTIFIER AND TERMINAL NUMBERING CONVENTION SHALL CONFORM TO JESD 95-1 SPP-012. DETAILS OF TERMINAL #1 IDENTIFIER ARE OPTIONAL, BUT MUST BE LOCATED WITHIN THE ZONE INDICATED. THE TERMINAL #1 IDENTIFIER MAY BE EITHER A MOLD OR MARKED FEATURE.
5. DIMENSION D AND E1 DO NOT INCLUDE MOLD PROTRUSION.
6. MAXIMUM MOLD PROTRUSION 0.15 mm PER SIDE
7. DIMENSION b DOES NOT INCLUDE DAM BAR PROTRUSION. ALLOWABLE DAM BAR PROTRUSION SHALL BE 0.127mm. TOTAL IN EXCESS OF THE b DIMENSION AT MAXIMUM MATERIAL CONDITION.
8. COPLANARITY APPLIES TO THE EXPOSED HEAT SINK SLUG AS WELL AS THE TERMINALS.
9. MATERIAL MUST COMPLY WITH BANNED AND RESTRICTED SUBSTANCES SPEC # 10-0131.
10. ALL DIMENSIONS APPLY TO PbfREE (+) PKG. CODES.
11. PACKAGE CODE: S8-18

SYMBOL	INCH			MILLIMETER		
	MIN	NOM	MAX	MIN	NOM	MAX
A	.053		.069	1.35		1.75
A1	.004		.010	0.10		0.25
A2	.049		---	1.25		---
b	.014		.019	0.35		0.49
c	.007		.010	0.19		0.25
D	.189		.197	4.80		5.00
E1	.150		.157	3.80		4.00
E	.228		.244	5.80		6.20
e	.050 BSC			1.27 BSC		
L	.016		.049	0.40		1.25
h	.010		.020	0.25		0.50
θ	0°		7°	0°		7°
θ1	5°		15°	5°		15°
θ2	2°	7°	12°	2°	7°	12°
aaa	.010			0.25		
bbb	.010			0.25		
ccc	.004			0.10		



TITLE:
PACKAGE OUTLINE, 8L SOIC,
150 MIL - SENSOR DYNAMICS

APPROVAL
RAMON DE LEON
12/20/11

DOCUMENT CONTROL NO.
21-0640

REV. A 2/2