

TOP VIEW

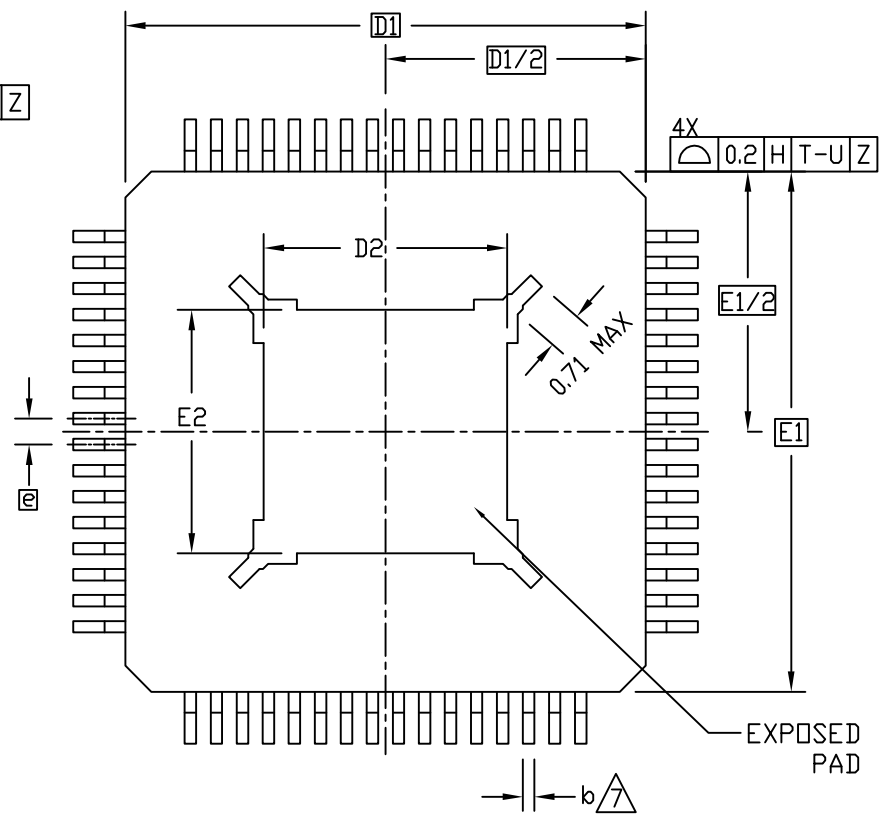

BOTTOM VIEW

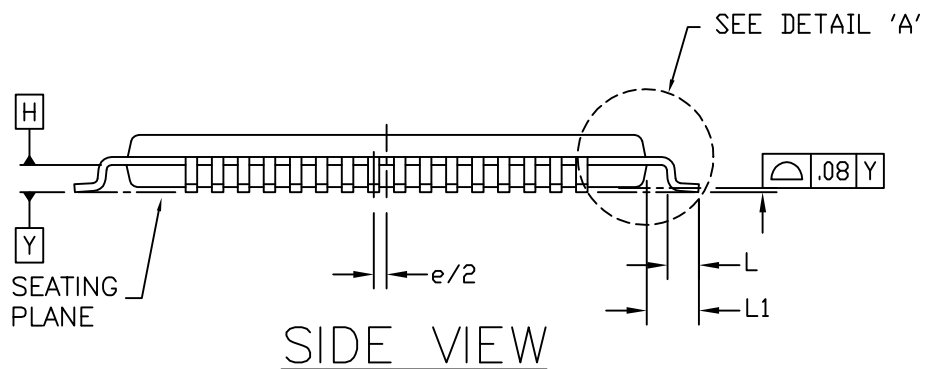

SIDE VIEW

-DRAWING NOT TO SCALE-

MAXIM

TITLE:
 PACKAGE OUTLINE, 64L TQFP, W/ EXPOSED PAD
 10X10X1MM - SENSOR DYNAMICS

APPROVAL
 RAMON DE LEON
 01/06/12

DOCUMENT CONTROL NO.
 21-0644

REV. 1/2
 A

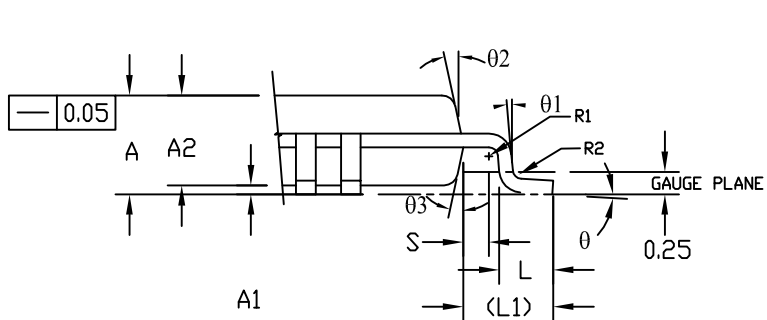

DETAIL 'A'

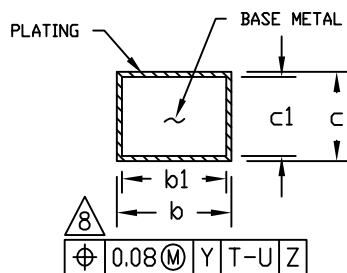

SECTION G-G

SYMBOL	MILLIMETER		
	MIN.	NOM.	MAX.
A	---	-	1.2
A1	0.05	-	0.15
A2	0.95	1	1.05
b	0.17	0.22	0.27
b1	0.17	0.2	0.23
c	0.09	-	0.2
c1	0.09	-	0.16
D	12 BSC		
D1	10 BSC		
e	0.5 BSC		
E	12 BSC		
E1	10 BSC		
L	0.45	0.6	0.75
L1	1 REF		
R1	0.08	-	---
R2	0.08	-	0.2
S	0.2	-	---
theta	0°	3.5°	7°
theta1	0°	-	---
theta2	11°	12°	13°
theta3	11°	12°	13°
E2	4.58	4.68	4.78
D2	4.58	4.68	4.78

NOTES:

1. ALL DIMENSIONS ARE IN MILLIMETERS. ANGLES ARE IN DEGREES.
2. DIMENSIONING & TOLERANCING CONFORM TO ASME Y14.5M-1994.
3. N IS THE TOTAL NUMBER OF TERMINALS.
4. DATUM [T], [U], AND [Z] TO BE DETERMINED AT DATUM PLANE [H].
5. DIMENSIONS D AND E TO BE DETERMINED AT SEATING PLANE DATUM [Y].
6. DIMENSIONS D1 AND E1 DO NOT INCLUDE MOLD PROTRUSION. ALLOWABLE PROTRUSION IS 0.25 PER SIDE. DIMENSIONS D1 AND E1 DO INCLUDE MOLD MISMATCH AND ARE DETERMINED AT DATUM PLANE DATUM [H].
7. DIMENSION b DOES NOT INCLUDE DAM BAR PROTRUSION. ALLOWABLE DAM BAR PROTRUSION SHALL NOT CAUSE THE LEAD WIDTH TO EXCEED THE MAXIMUM b DIMENSION BY MORE THAN 0.08 mm. DAM BAR CANNOT BE LOCATED ON THE LOWER RADIUS OR THE FOOT. MINIMUM SPACE BETWEEN PROTRUSION AND AN ADJACENT LEAD IS 0.07 mm.
8. ND AND NE REFER TO THE NUMBER OF TERMINALS ON EACH D AND E SIDE, RESPECTIVELY.
9. EXACT SHAPE OF EACH CORNER IS OPTIONAL.
10. MATERIAL MUST COMPLY WITH BANNED AND RESTRICTED SUBSTANCES SPEC # 10-0131.
11. MARKING SHOWN IS FOR PACKAGE ORIENTATION REFERENCE ONLY.
12. ALL DIMENSIONS APPLY TO PbFREE (+) PKG. CODES.
13. PACKAGE CODE: C64E-14



TITLE:
PACKAGE OUTLINE, 64L TQFP, W/ EXPOSED PAD
10X10X1MM - SENSOR DYNAMICS

APPROVAL
RAMON DE LEON
01/06/12

DOCUMENT CONTROL NO.
21-0644

REV. 2/2
A

-DRAWING NOT TO SCALE-