

TOP VIEW

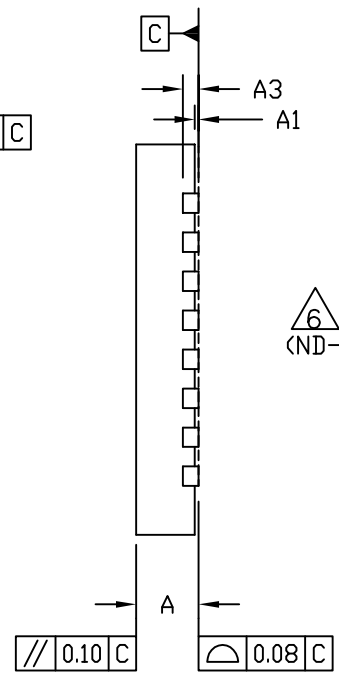

SIDE VIEW

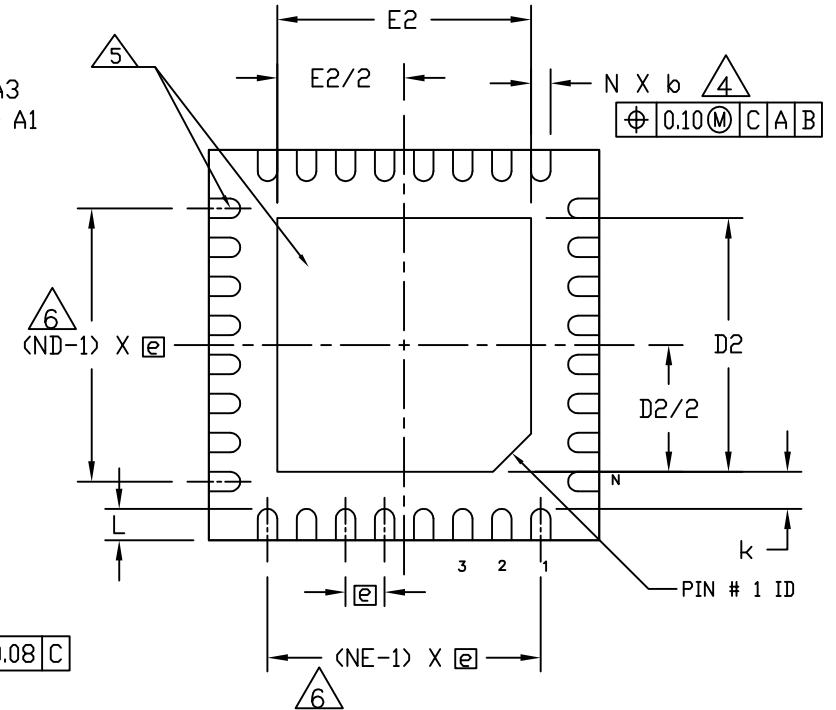

BOTTOM VIEW



TITLE:  
 PACKAGE OUTLINE, 32L SAWN QFN,  
 5X5X0.90MM, PHYWORKS

APPROVAL	DOCUMENT CONTROL NO. 21-0668	REV. A	1/2
----------	---------------------------------	-----------	-----

-DRAWING NOT TO SCALE-

NOTES:

1. ALL DIMENSIONS ARE IN MILLIMETERS. ANGLES ARE IN DEGREES.
2. DIMENSIONING & TOLERANCING CONFORM TO ASME Y14.5M-1994.
3. N IS THE TOTAL NUMBER OF TERMINALS.
4. DIMENSION *b* APPLIES TO METALLIZED TERMINAL AND IS MEASURED BETWEEN 0.15 mm AND 0.30 mm FROM TERMINAL TIP.
5. APPLIED FOR EXPOSED PAD AND TERMINALS. EXCLUDE EMBEDDING PART OF EXPOSED PAD FROM MEASURING.
6. ND AND NE REFER TO THE NUMBER OF TERMINALS ON EACH D AND E SIDE, RESPECTIVELY.
7. MARKING SHOWN IS FOR PACKAGE ORIENTATION REFERENCE ONLY.
8. NI/PD/AU LEAD FINISH.
9. MATERIAL MUST COMPLY WITH BANNED AND RESTRICTED SUBSTANCES SPEC # 10-0131.
10. ALL DIMENSIONS APPLY TO BOTH LEADED (-) AND PbfREE (+) PKG. CODES.
11. PACKAGE CODE: G3255N-1

SYMBOL	MILLIMETER		
	MIN.	NOM.	MAX.
A	0.85	0.90	0.95
A3	0.195	0.203	0.211
A1	0	---	0.05
<i>b</i>	0.20	0.25	0.30
D	4.925	5.0	5.075
D2	1.25	2.70	3.25
E	4.925	5.0	5.075
E2	1.25	2.70	3.25
<i>e</i>	0.50 BSC		
L	0.30	0.40	0.50
<i>k</i>	MIN 0.2		



TITLE:  
PACKAGE OUTLINE, 32L SAWN QFN,  
5X5X0.90MM PHYWORKS

APPROVAL	DOCUMENT CONTROL NO. 21-0668	REV. A	2/2
----------	---------------------------------	-----------	-----

-DRAWING NOT TO SCALE-